

Charter Bylaw 19889

A Bylaw to amend Bylaw 12800, as amended,
The Edmonton Zoning Bylaw
Amendment No. 3337

WHEREAS a portion of Lot 2, Block 6A, Plan 9220135; located at 101 - Airport Road NW, Blatchford, Edmonton, Alberta, is specified on the Zoning Map as (MA1) Municipal Airport Airfield Zone and (PU) Public Utility Zone; and

WHEREAS an application was made to rezone the above described property to (BRH) Blatchford Row Housing Zone and (BP) Blatchford Parks Zone;

NOW THEREFORE after due compliance with the relevant provisions of the Municipal Government Act RSA 2000, ch. M-26, as amended, the Municipal Council of the City of Edmonton duly assembled enacts as follows:

1. The Zoning Map, being Part III to Bylaw 12800 The Edmonton Zoning Bylaw is hereby amended by rezoning the lands legally described as a portion of Lot 2, Block 6A, Plan 9220135; located at 101 - Airport Road NW, Blatchford, Edmonton, Alberta, which lands are shown on the sketch plan attached as Schedule "A", from (MA1) Municipal Airport Airfield Zone and (PU) Public Utility Zone to (BRH) Blatchford Row Housing Zone and (BP) Blatchford Parks Zone.

2. The Edmonton Zoning Bylaw is hereby further amended by deleting from it Appendix 1 to Section 997 Special Area Blatchford and replacing therefore as Appendix 1 the map attached hereto as Schedule “B”.

| | | |
|-------------------------|--------|---------------|
| READ a first time this | day of | , A. D. 2021; |
| READ a second time this | day of | , A. D. 2021; |
| READ a third time this | day of | , A. D. 2021; |
| SIGNED and PASSED this | day of | , A. D. 2021. |

THE CITY OF EDMONTON

MAYOR

CITY CLERK

CHARTER BYLAW 19889

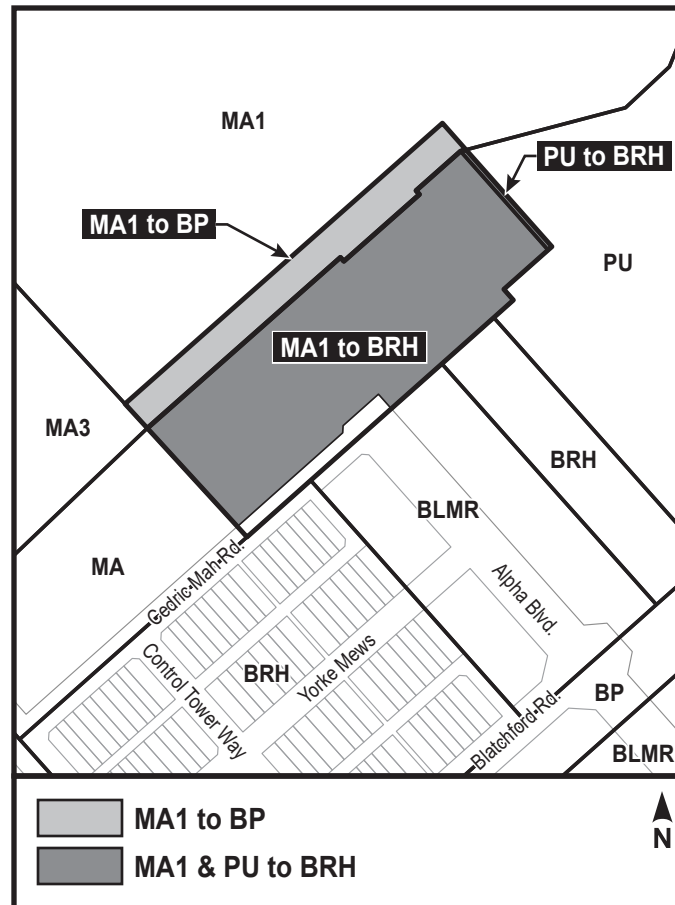

V:\1161\active\1161109180\drawing\model_files\rezone\sq_rz_blatchford_stage 5_13oct2021.dwg

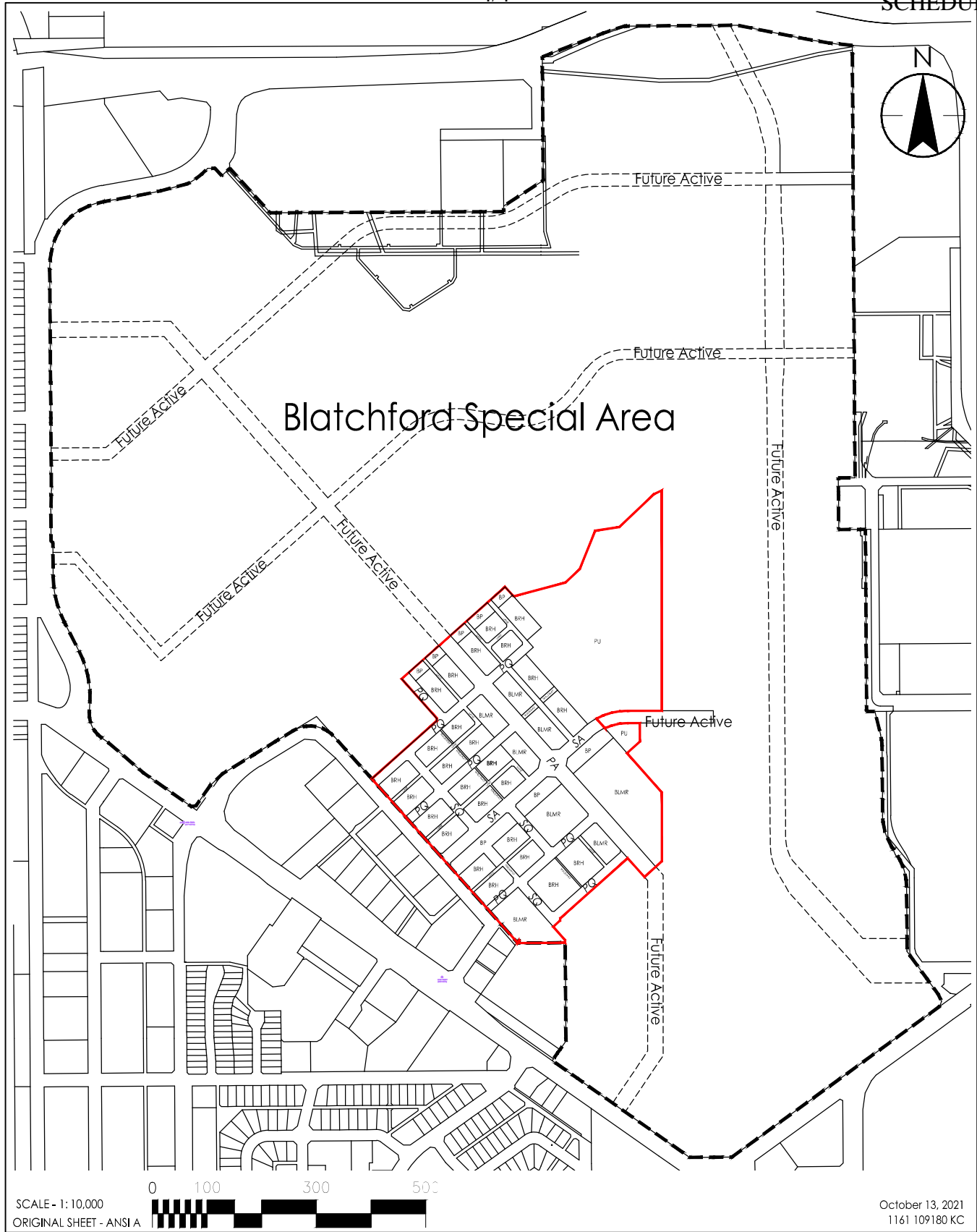

Client/Project

CITY OF EDMONTON
BLATCHFORD NEIGHBOURHOOD
REZONING APPLICATION

Figure No.

Appendix 1

Title

Special Area
Blatchford Neighbourhood



10160-112 Street
Edmonton, AB T5K 2L6
www.stantec.com

LEGEND

PA = PRIMARY ACTIVE STREET
SA = SECONDARY ACTIVE STREET
PQ = PRIMARY QUIET STREET
SQ = SECONDARY QUIET STREET