

Bylaw 18260

A Bylaw to amend Bylaw 6616, as amended,
Being the Terra Losa Neighbourhood Area Structure Plan

WHEREAS pursuant to the provision of the Planning Act, City Council on May 11, 1982 passed Bylaw 6616, as amended, being the Terra Losa Neighbourhood Area Structure Plan; and

WHEREAS Council found it desirable to amend the Terra Losa Neighbourhood Area Structure Plan through the through the passage of Bylaws 7173, 7265, 7526, 10949, 11532, 12200 and 12828; and

WHEREAS an application was received by City Planning to further amend the Terra Losa Neighbourhood Area Structure Plan; and

WHEREAS Council considers it desirable to further amend the Terra Losa Neighbourhood Area Structure Plan;

NOW THEREFORE after due compliance with the relevant provisions of the Municipal Government Act, S.A. 1994, c. M-26.1, as amended, the Municipal Council of the City of Edmonton duly assembled enacts as follows:

1. Bylaw 6616, as amended, is hereby amended by:
 - a) deleting therefrom the statistics entitled “Terra Losa Neighbourhood Area Structure Plan – Land Use and Population Statistics - Bylaw 12828” and substituting therefor new statistics entitled “Terra Losa Neighbourhood Area Structure Plan – Land Use and Population

Statistics - Bylaw 18260” and forming part of this Bylaw; and

**TERRA LOSA NEIGHBOURHOOD AREA STRUCTURE PLAN
LAND USE AND POPULATION STATISTICS
Bylaw 18260**

Residential	Area (ha)	Population
DC 1 (Area 1)	1.0	95
RF5	6.5	900
RF6	3.5	925
RA7	6.6	1770
Medium Density Residential (Site Specific DC2)	6.7	1670
RA8	3.8	1580
RA9	2.0	1205
CNC	1.2	
US (Community Centres)	1.2	
AP (AGU)	5.6	
StormWater Lake	2.4	
Circulation (Internal)	3.3	
	<hr/>	
Total	43.8	8,145
Business/Commercial		
IB	0.6	
DC 1 (Area II)	2.0	
DC 1 (Area III)	2.5	
DC 1 (Area IV)	8.6	
DC5	8.8	
Circulation (Internal)	1.3	
	<hr/>	
Total	23.8	
Circulation (External)	1.9	
	<hr/>	
Total Land Area	69.5	

- b) deleting map entitled “Bylaw 12828 Amendment to the Terra Losa Neighbourhood Area Structure Plan” and substituting therefor the map entitled “Bylaw 18260 Amendment to the Terra Losa Neighbourhood Area Structure Plan” attached hereto as Schedule “A” and forming part of this Bylaw.

READ a first time this	day of	, A. D. 2018;
READ a second time this	day of	, A. D. 2018;
READ a third time this	day of	, A. D. 2018;
SIGNED and PASSED this	day of	, A. D. 2018.

THE CITY OF EDMONTON

MAYOR

CITY CLERK

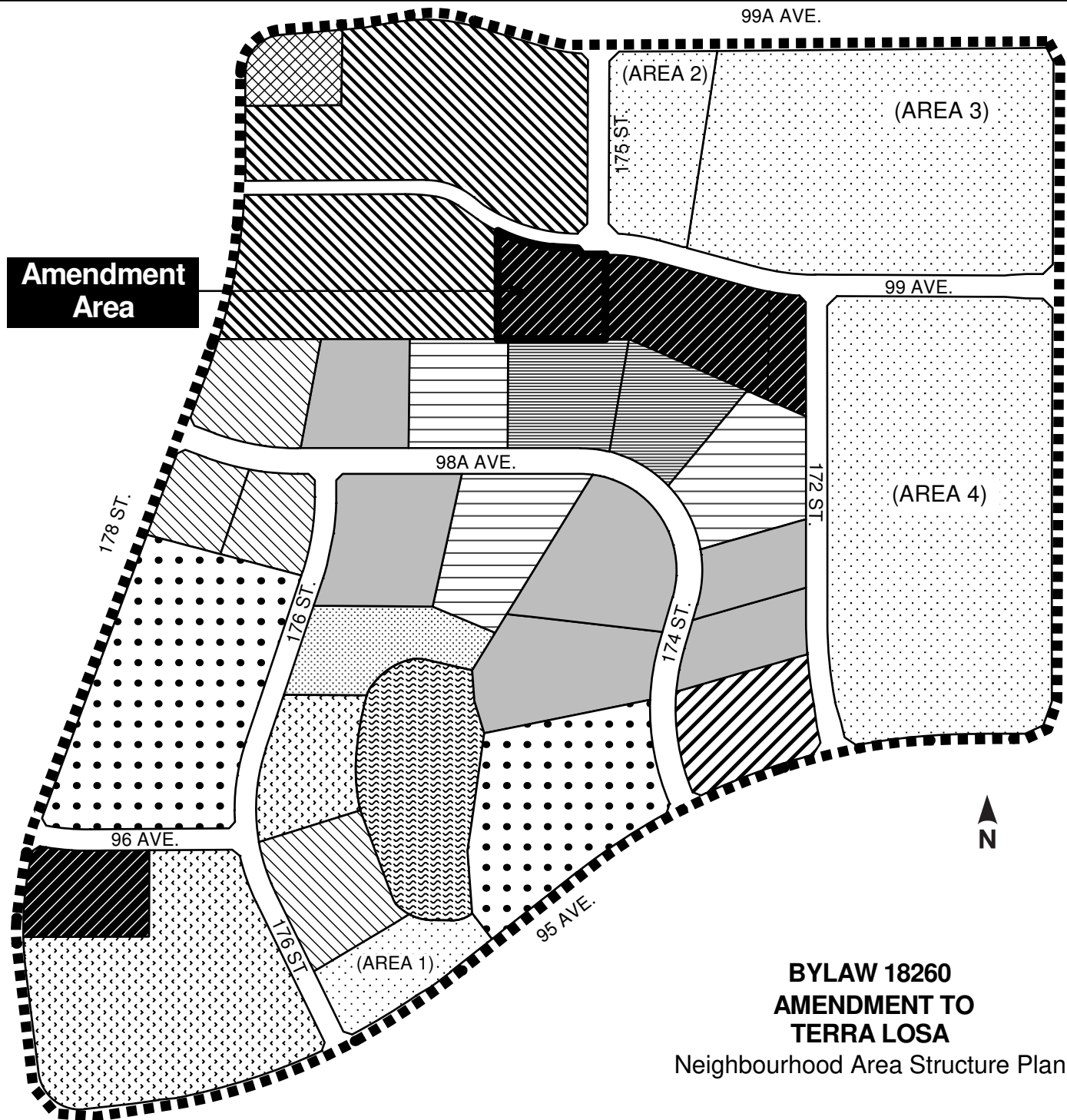

Amendment Area



**BYLAW 18260
AMENDMENT TO
TERRA LOSA**
Neighbourhood Area Structure Plan

- | | | | |
|--|--------------------------------------|--|-----------------------------|
| | Row Housing | | Storm Water Lake |
| | Medium Density Multiple-Family | | Commercial (DC2) |
| | Low Rise Apartment | | Public Parks |
| | Medium Rise Apartment | | Urban Service |
| | High Rise Apartment | | Direct Development Controls |
| | Industrial Business | | N.A.S.P. Boundary |
| | Neighbourhood Convenience Commercial | | Boundary of Amendment |
| | Medium Density Residential (DC2) | | |

Note: Location of collector roads and configuration of stormwater management facilities are subject to minor revisions during subdivision and rezoning of the neighbourhood and may not be developed exactly as illustrated.