

Village at ICE District

Council Public Hearing

August 16, 2022

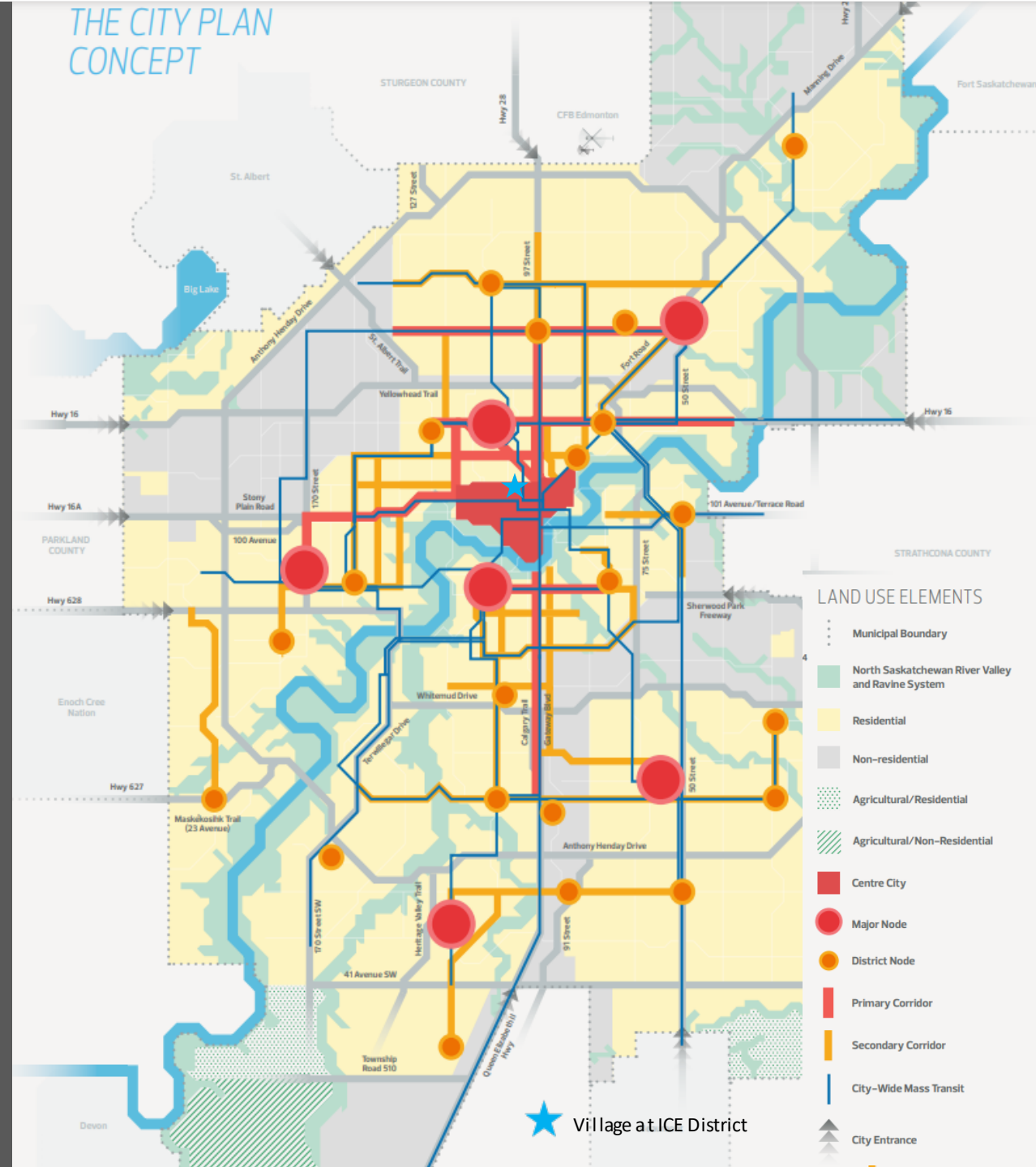



CENTRAL MCDOUGALL /QUEEN MARY PARK ARP

- The proposed application is in conformance with the plan as the subject lands are designated for high density high and medium rise apartments and business uses.

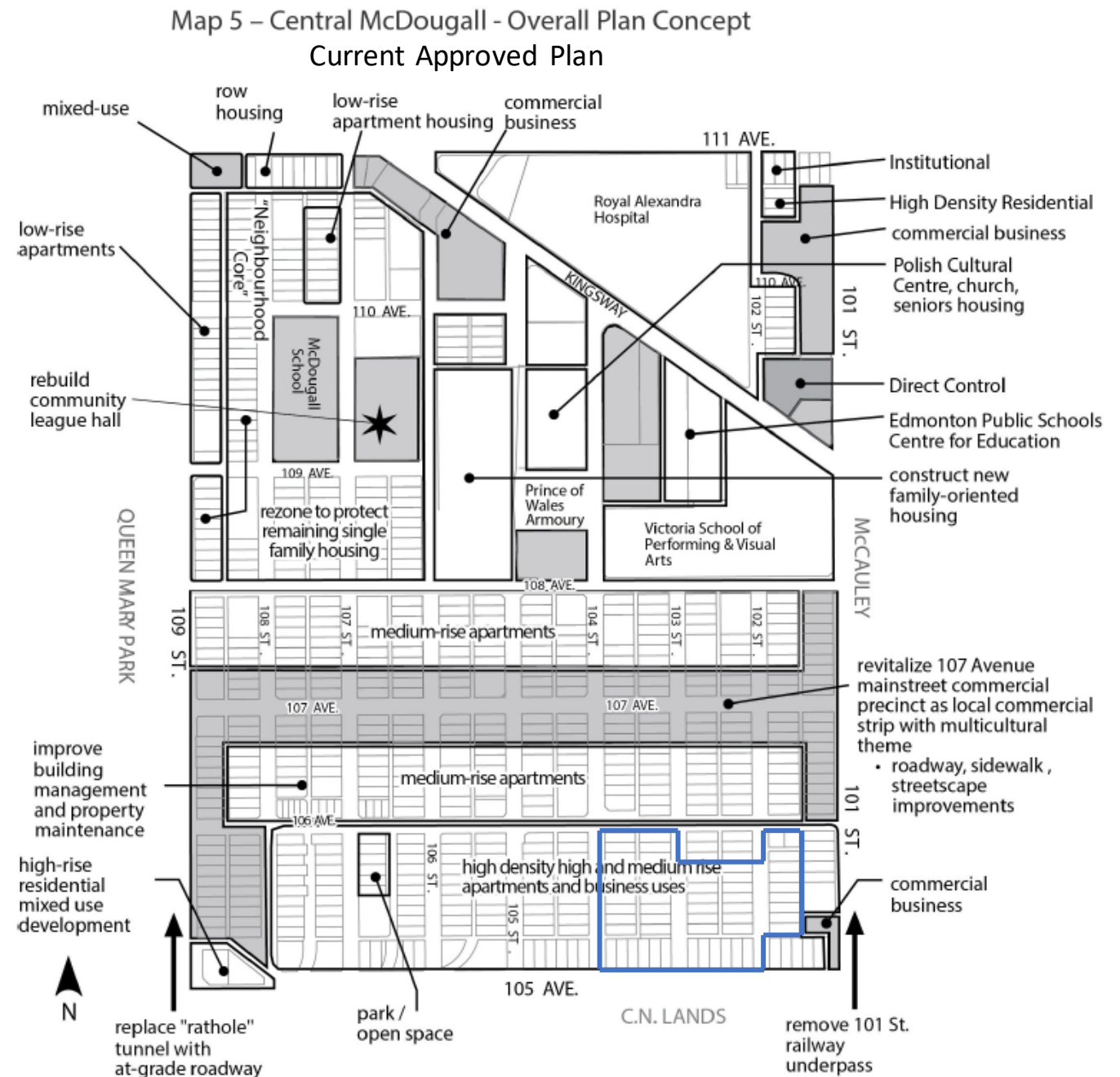

SPECIAL AREA ZONE SUMMARY— CENTRAL MCDOUGALL URBAN VILLAGE

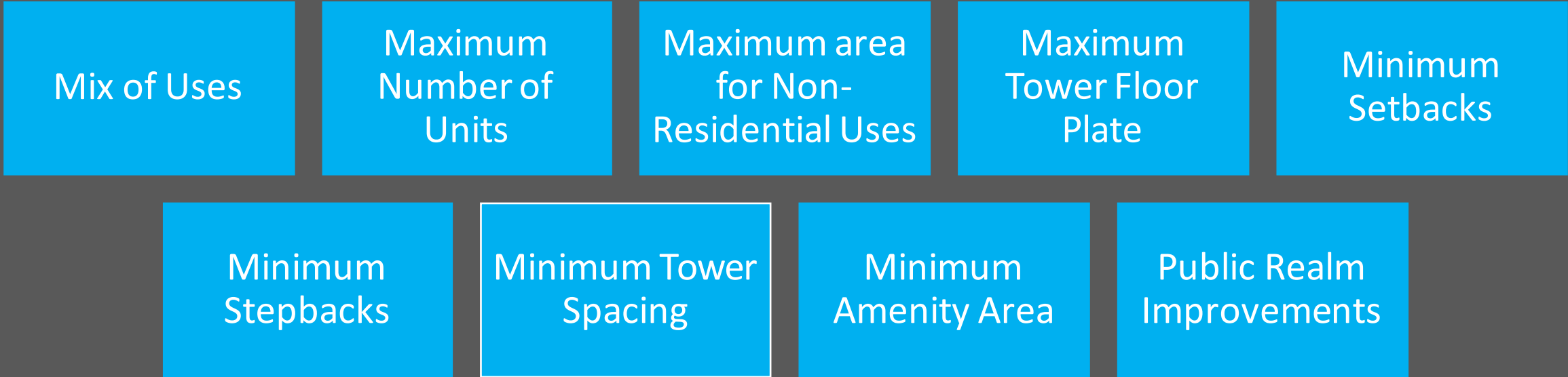

SPECIAL AREA ZONE – CENTRAL MCDOUGALL URBAN VILLAGE



PUBLIC ENGAGEMENT

2017

- Meetings with Central McDougall Community League – 2 meetings
- Public Open House – 1 open house

2018

- Meetings with Central McDougall Community League – 1 meeting

2019

- Meetings with Central McDougall Community League – 2 meetings
- Public Open House – 1 open house

2020

- Meetings with Central McDougall Community League – 1 meeting

2021

- Meetings with Central McDougall Community League – 1 meeting

2022

- Meetings with Central McDougall Community League – 2 meetings
- Meetings with North Edge BIA, Downtown Edmonton Community League, Downtown Business Association, Chinatown Business Association, Boyle Street Community Services and MacEwan University
- Engage Edmonton Website



Conceptual rendering