

THE CITY OF EDMONTON

BYLAW 18150

ARTERIAL ROADS FOR DEVELOPMENT AMENDMENT No. 23

Edmonton City Council enacts:

- 1 Bylaw 14380, the ARTERIAL ROADS FOR DEVELOPMENT, is amended by this bylaw.
- 2 That Schedule “AA” of Bylaw 14380 is amended as per the map and text attached to this Bylaw 18150.
- 3 That Schedule “G” of Bylaw 14380 is amended as per the map and text attached to this Bylaw 18150.
- 4 That Schedule “J” of Bylaw 14380 is amended as per the map and text attached to this Bylaw 18150.
- 5 That Schedule “T” of Bylaw 14380 is amended as per the map and text attached to this Bylaw 18150.
- 6 That Schedule “X” of Bylaw 14380 is amended as per the map and text attached to this Bylaw 18150.

READ a first time this	day of ,	A. D. 2017;
READ a second time this	day of,	A. D. 2017;
READ a third time this	day of,	A. D. 2017;
SIGNED and PASSED this	day of ,	A. D. 2017.

THE CITY OF EDMONTON

MAYOR

CITY CLERK

Schedule "AA" - Edgemont - Catchment & Associated Roadways

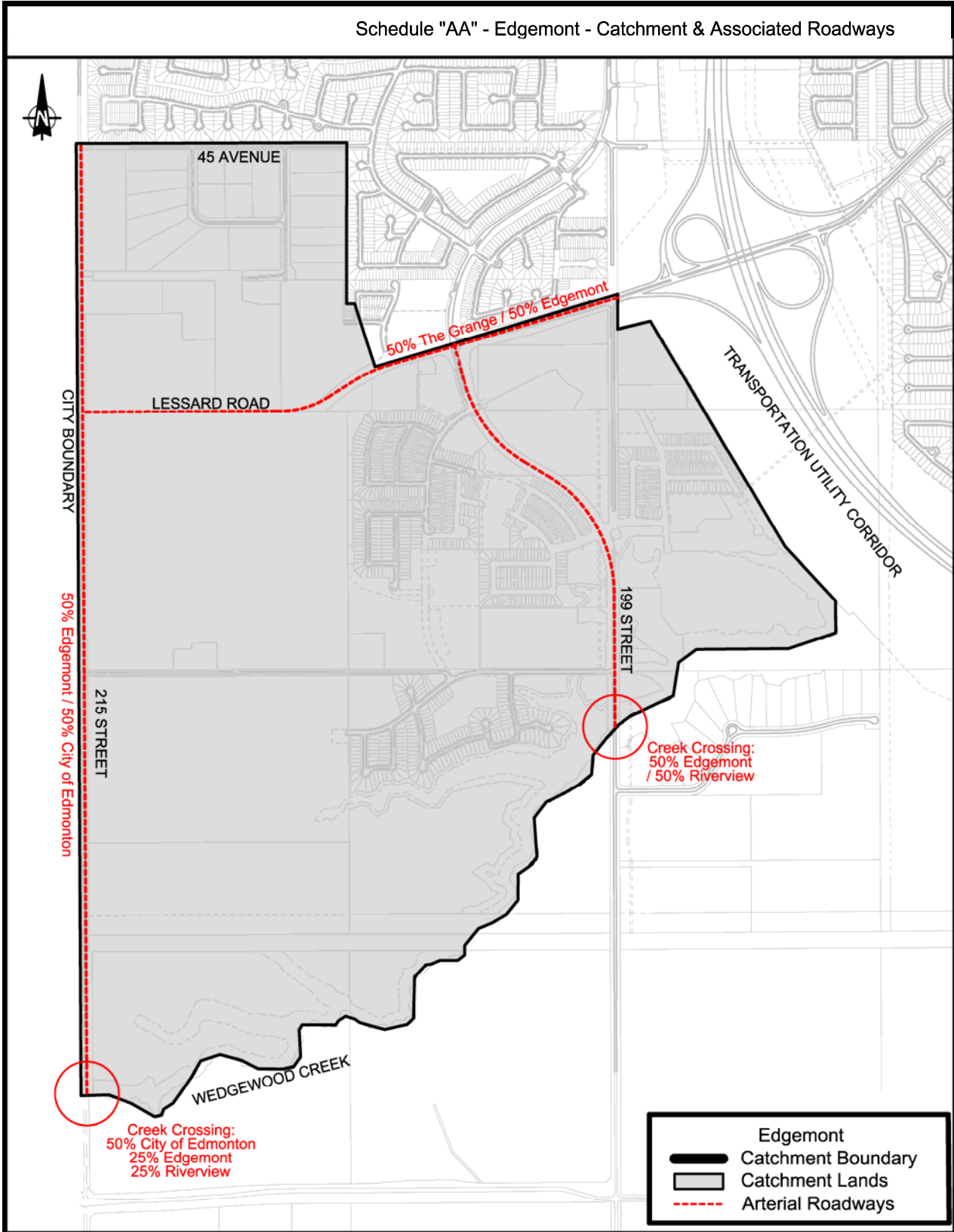

Schedule “AA”
Edgemont – Catchment & Associated Roadways

The following Arterial Road Improvements are included in the Edgemont ARA Catchment:

1. 199 Street (four lanes) – Lessard Road to Wedgewood Creek
2. Lessard Road (four lanes) – Transportation Utility Corridor to approximately 750 m west of the Transportation Utility Corridor (50%/50% cost share with The Grange ARA Catchment)
3. Lessard Road (four lanes) – Approximately 750 m west of the Transportation Utility Corridor to 215 Street
4. 215 Street (four lanes) – 45 Avenue to Wedgewood Creek (50%/50% cost share with the City of Edmonton)
5. Creek Crossing on 199 Street at Wedgewood Creek (50%/50% cost share with future adjacent ARA catchment to the south)
6. Creek Crossing on 215 Street at Wedgewood Creek (25% /25%/ 50% cost share between Edgemont ARA catchment, future adjacent ARA catchment to the south, and the City of Edmonton, respectively)

Schedule "G" - The Grange - Catchment & Associated Roadways

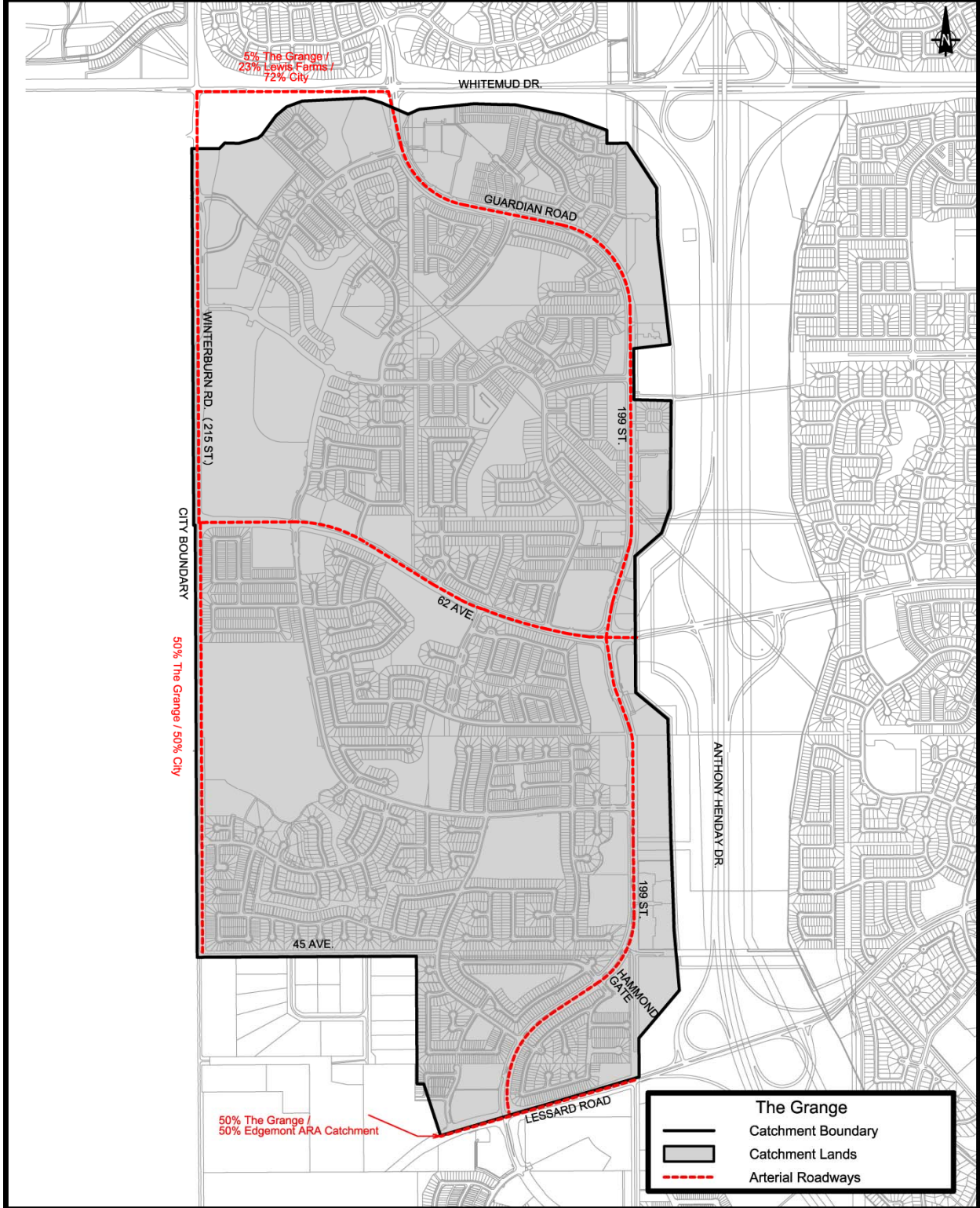

**Schedule “G”
The Grange – Catchment & Associated Roadways**

The following Arterial Road Improvements are included in The Grange ARA Catchment:

1. Guardian Road (two lanes) – Whitemud Drive to 199 Street
2. 199 Street (two lanes) – Guardian Road to Hammond Gate
3. 199 Street (four lanes) – Hammond Gate to Lessard Road
4. 62 Avenue (two lanes) – Transportation Utility Corridor to 212 Street
5. 62 Avenue (four lanes) – 212 Street to 215 Street
6. 215 Street (four lanes) – Whitemud Drive to 45 Avenue (50%/50% cost share with the City of Edmonton)
7. Whitemud Drive (two lanes) – Guardian Road to 215 Street (5%/23%/72% cost share between the Grange ARA Catchment, Lewis Farms ARA Catchment and the City of Edmonton, respectively)
8. Lessard Road (four lanes) – Transportation Utility Corridor to approximately 750 metres west of the Transportation Utility Corridor (50%/50% cost share with Edgemont ARA Catchment)

Schedule "J" - Lewis Farms - Catchment & Associated Roadways

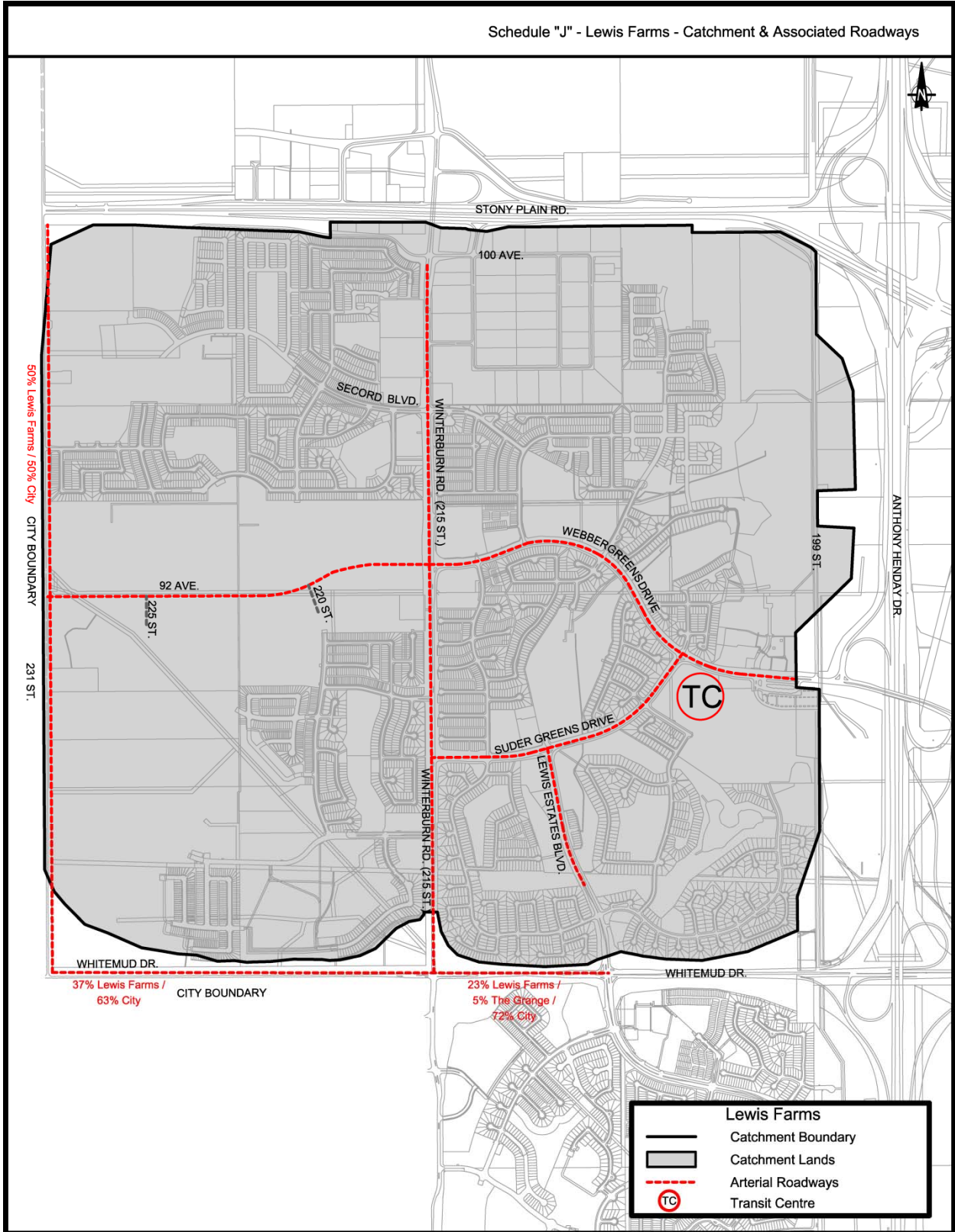

Schedule “J”
Lewis Farms – Catchment & Associated Roadways

The following Arterial Road Improvements are included in the Lewis Farms ARA Catchment:

1. Lewis Estates Boulevard (two lanes) – approximately 310 metres north of Whitemud Drive to Suder Greens Drive
2. Suder Greens Drive (two lanes) – Webber Greens Drive to 215 Street
3. Webber Greens Drive (two lanes) – Transportation Utility Corridor to 215 Street
4. 215 Street (two lanes) – Whitemud Drive to 100 Avenue
5. 92 Avenue (four lanes) – 215 Street to approximately 135 m west of 220 Street
6. 92 Avenue (three lanes) – Approximately 135 m west of 220 Street to 225 Street
7. 92 Avenue (two lanes) – 225 Street to 231 Street
8. 231 Street (four lanes) – Whitemud Drive to Stony Plain Road (50%/50% cost share with the City of Edmonton)
9. Whitemud Drive (two lanes) – Lewis Estates Boulevard to 215 Street (23%/5%/72% cost share between Lewis Farms ARA Catchment, the Grange ARA Catchment and the City of Edmonton, respectively)
10. Whitemud Drive (four lanes) – 215 Street to 231 Street (37%/63% cost share between Lewis Farms Catchment and the City of Edmonton, respectively)
11. Transit Centre right-of-way dedication south of Webber Greens Drive and west of the Transportation Utility Corridor

Schedule "T" - South East ASP - Catchment & Associated Roadways

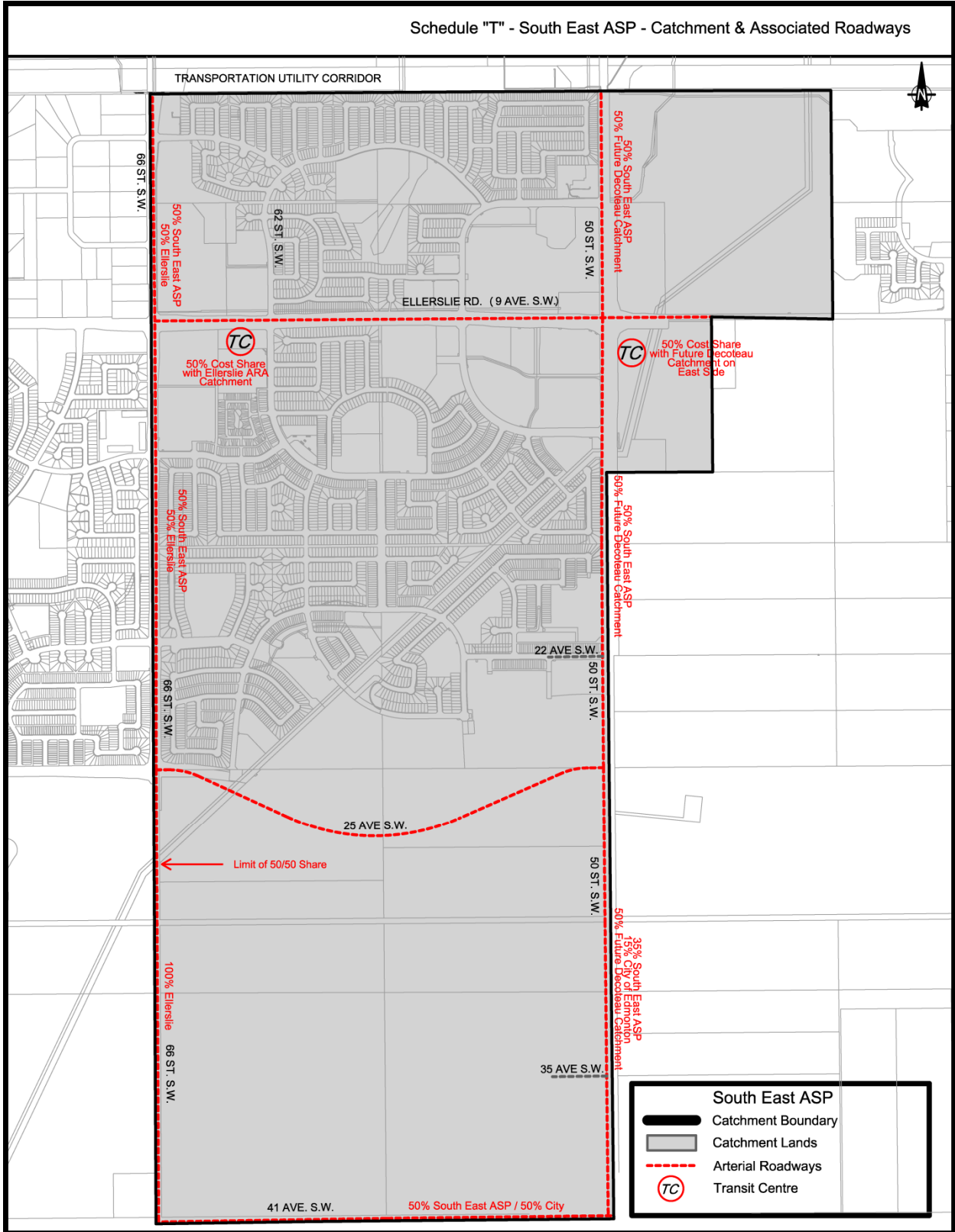

Schedule “T”
South East ASP – Catchment & Associated Roadways

The following Arterial Road Improvements are included in the South East ASP Catchment:

1. 66 Street S.W. (three lanes) – Transportation Utility Corridor to Ellerslie Road (50%/50% cost share with the Ellerslie ARA Catchment)
2. 66 Street S.W. (four lanes) – Ellerslie Road to approximately 250 metres south of 25 Avenue S.W. (50%/50% cost share with the Ellerslie ARA Catchment)
3. Ellerslie Road (two lanes) – 66 Street S.W. to 62 Street S.W.
4. Ellerslie Road (four lanes) – 62 Street S.W. to 50 Street S.W.
5. 25 Avenue S.W. (four lanes) – 66 Street S.W. to 50 Street S.W.
6. 41 Avenue S.W. (four lanes) – 66 Street S.W. to 50 Street S.W. (50%/50% cost share with the City of Edmonton)
7. 50 Street S.W. (two lanes) – Transportation Utility Corridor to 22 Avenue S.W. (50%/50% cost share with the future Decoteau ARA Catchment to the east)
8. 50 Street S.W. (four lanes) – 22 Avenue S.W. to 41 Avenue S.W. (35%/50%/15% cost share between Southeast ARA Catchment, the future Decoteau ARA Catchment to the east, and the City of Edmonton, respectively)
9. Transit centre right-of-way dedication on the southwest corner of the intersection at Ellerslie Road and 62 Street S.W. (50%/50% cost share with the Ellerslie ARA Catchment)
10. Transit centre right-of-way dedication southeast of the intersection at Ellerslie Road and 50 Street S.W. (50%/50% cost share with the future Decoteau ARA Catchment to the east)

Schedule "X" - Windermere - Catchment & Associated Roadways

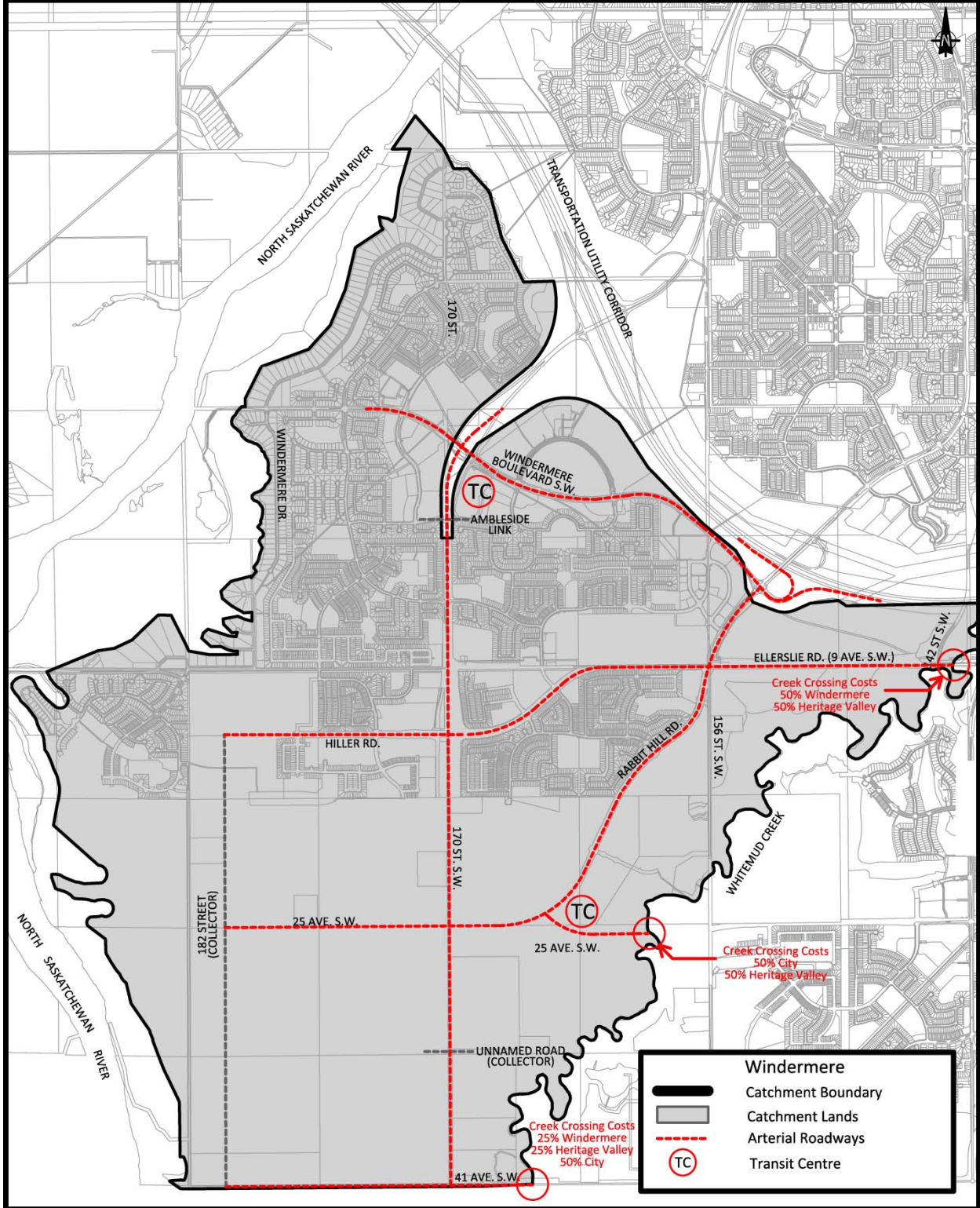

Schedule “X”

Windermere – Catchment & Associated Roadways

The following Arterial Road Improvements are included in the Windermere ARA Catchment:

1. Windermere Boulevard S.W. (four lanes) – 156 Street S.W. to approximately 350 metres west of 170 Street
2. Ellerslie Road (four lanes) – Whitemud Creek to 170 Street S.W.
3. Hiller Road (four lanes) – 170 Street S.W. to 182 Street S.W.
4. Rabbit Hill Road S.W. (four lanes) – Transportation Utility Corridor to 25 Avenue S.W.
5. 170 Street N.W & S.W. (two lanes) – Transportation Utility Corridor to Ambleside Link S.W.
6. 170 Street S.W. (four lanes) – Ambleside Link S.W. to Unnamed Road (Collector) North of 41 Avenue S.W.
7. 170 Street S.W. (two lanes) – Unnamed Road (Collector) North of 41 Avenue S.W. to 41 Avenue S.W.
8. 25 Avenue S.W. (two lanes) – Whitemud Creek to Unnamed Road (Collector) East of Rabbit Hill Road S.W.
9. 25 Avenue S.W. (four lanes) – Unnamed Road (Collector) East of Rabbit Hill Road S.W. to 182 Street S.W.
10. 41 Avenue S.W. (two lanes) – Whitemud Creek to 182 Street S.W.
11. The permanent right-in and right-out ramps on the south side of the Anthony Henday Drive and 156 Street interchange
12. The earth works and grading for the 170 Street S.W. re-alignment within the Transportation Utility Corridor lands, at the location south of the Anthony Henday Drive and 170 Street interchange
13. Creek crossing at Ellerslie Road (50%/50% cost share with the Heritage Valley ARA Catchment)
14. Creek crossing at 25 Avenue S.W. (50%/50% cost shared between the City of Edmonton and Heritage Valley ARA Catchment)
15. Creek crossing at 41 Avenue S.W. (cost shared 25%/25%/50% between the Windermere ARA Catchment, the Heritage Valley ARA Catchment and the City of Edmonton, respectively)
16. Transit centre right-of-way dedication southeast of the intersection at 170 Street N.W. and 9 Avenue N.W.
17. Transit Centre right-of-way dedication northeast of the intersection at Rabbit Hill Road S.W. and 25 Avenue S.W.