

Charter Bylaw 20499

A Bylaw to amend Bylaw 12800, as amended,
The Edmonton Zoning Bylaw
Amendment No. 3645

WHEREAS a portion of Lot A, Block 1, Plan 2122223; located at 2303 - 199 Street NW, The Uplands, Edmonton, Alberta, is specified on the Zoning Map as (AG) Agricultural Zone; and

WHEREAS an application was made to rezone the above described property to (RTCMR) Riverview Town Centre Medium Rise Zone;

NOW THEREFORE after due compliance with the relevant provisions of the Municipal Government Act RSA 2000, ch. M-26, as amended, the Municipal Council of the City of Edmonton duly assembled enacts as follows:

1. The Zoning Map, being Part III to Bylaw 12800 The Edmonton Zoning Bylaw is hereby amended by rezoning the lands legally described as a portion of Lot A, Block 1, Plan 2122223; located at 2303 - 199 Street NW, The Uplands, Edmonton, Alberta, which lands are shown on the sketch plan annexed hereto as Schedule "A", from (AG) Agricultural Zone to (RTCMR) Riverview Town Centre Medium Rise Zone.
2. The Edmonton Zoning Bylaw is hereby further amended by deleting Appendix I of Section 992 – Special Area Riverview and replacing it with Appendix I of Section 992 – Special Area Riverview, attached hereto as Schedule "B" and forming part of this bylaw.
3. The Edmonton Zoning Bylaw is hereby further amended by deleting Appendix I of Section 993 – Special Area Riverview Town Centre and replacing it with Appendix I of Section 993 – Special Area Riverview Town Centre, attached hereto as Schedule "C" and forming part of this bylaw.

4. The Edmonton Zoning Bylaw is hereby further amended by deleting Appendix II of Section 993 – Special Area Riverview Town Centre and replacing it with Appendix II of Section 993 – Special Area Riverview Town Centre, attached hereto as Schedule “D” and forming part of this bylaw.

READ a first time this	30th day of May	, A. D. 2023;
READ a second time this	30th day of May	, A. D. 2023;
READ a third time this	30th day of May	, A. D. 2023;
SIGNED and PASSED this	30th day of May	, A. D. 2023.

THE CITY OF EDMONTON



 MAYOR



 A/ CITY CLERK

CHARTER BYLAW 20499

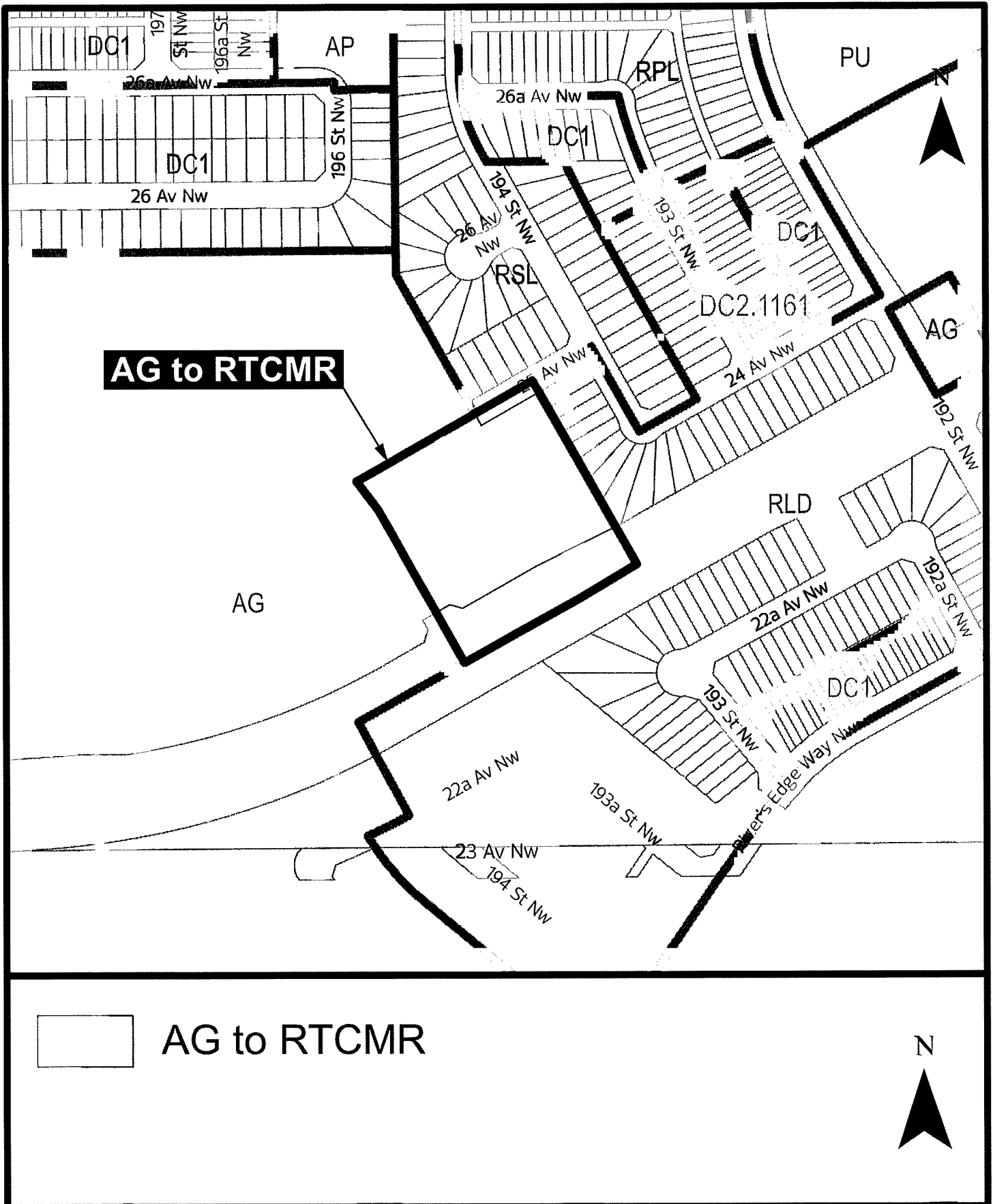

PARKLAND COUNTY

Special Area Boundary

Special Area, Riverview. Appendix I to Section 992 of Bylaw 12800

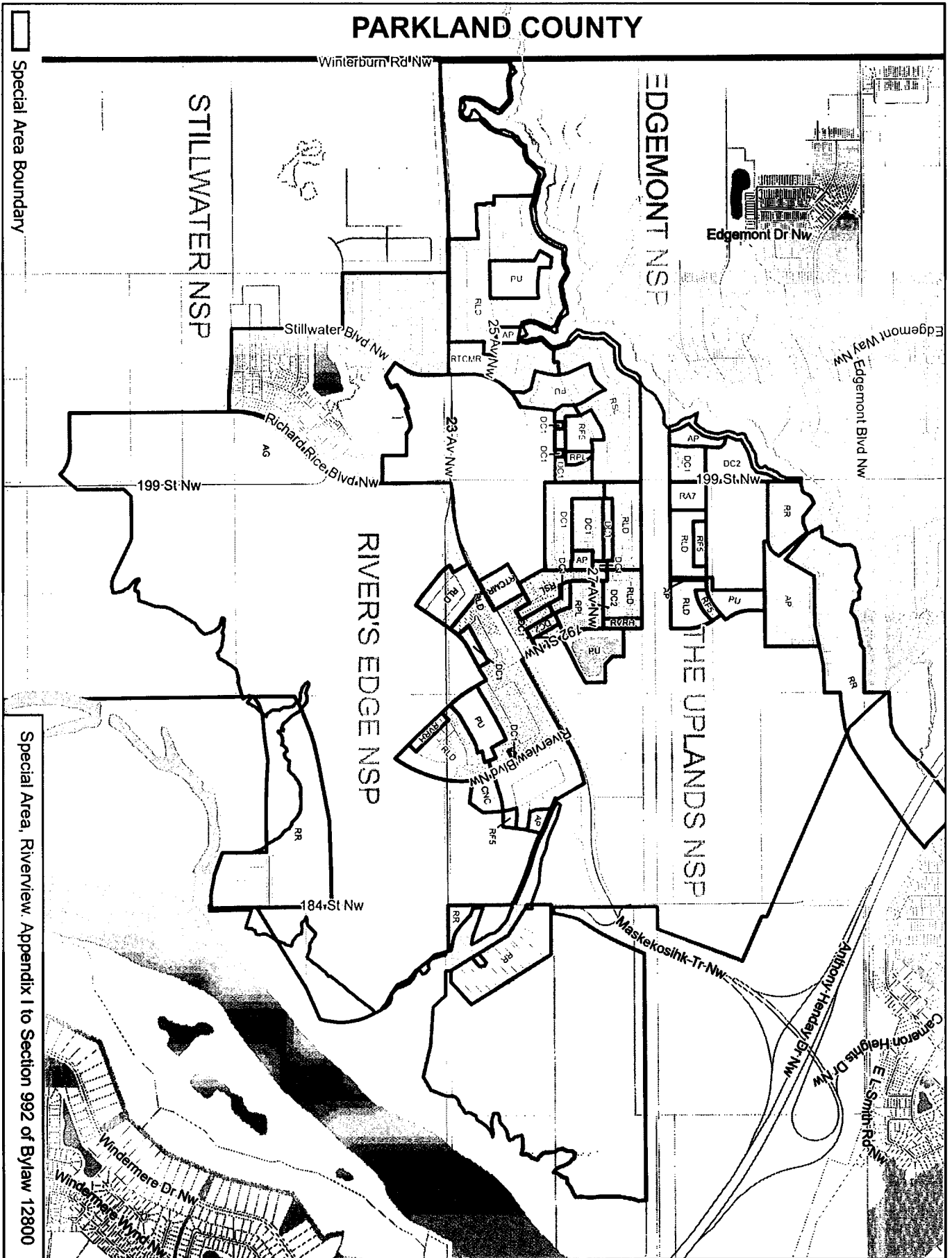

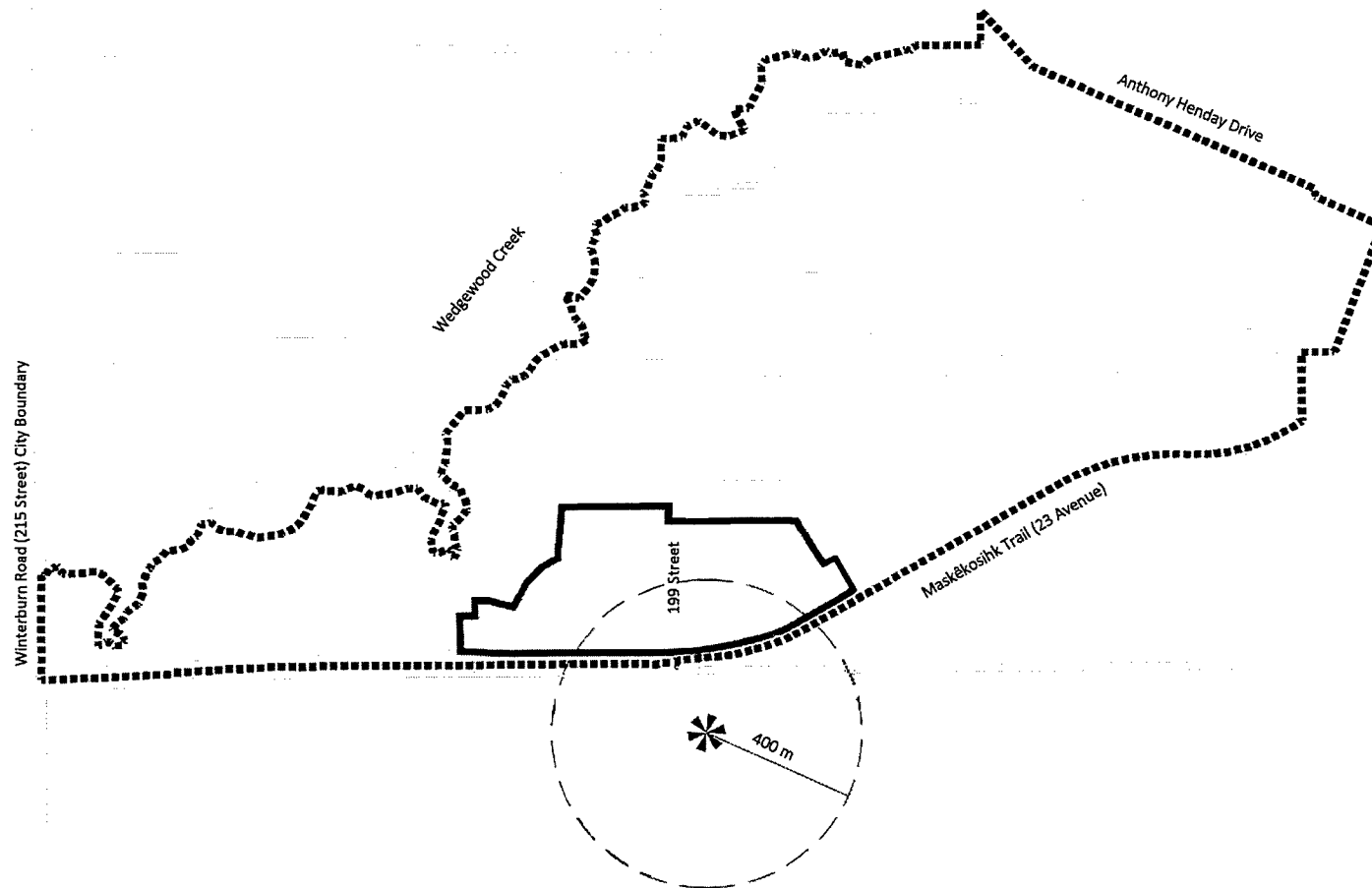

- Special Area Boundary
- - - The Uplands NSP Boundary
- ✱ Future Transit Centre
- - - 400 m radius

APPENDIX I

Special Area

Riverview Town Centre
Special Area

Edmonton, Alberta

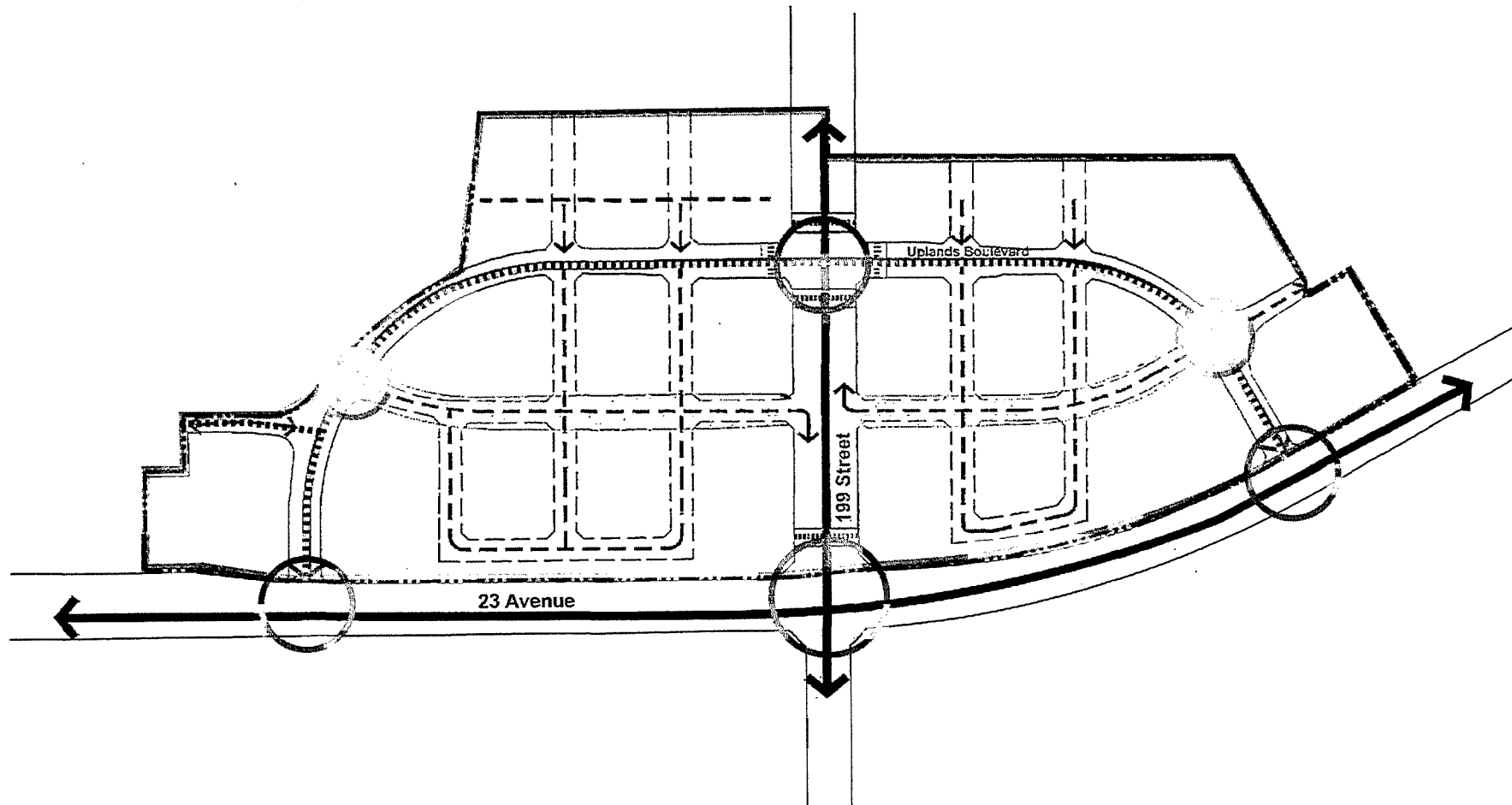

Legend

- Special Area Riverview Town Centre Boundary
- Conceptual Publicly Accessible Private Road
- Public Road
- Conceptual Vehicle Access and Circulation
- Pedestrian Crossing at Key Intersections
- Conceptual Pedestrian Connection
(Combination of hard and soft landscaping)

Pedestrian Zone

Shared Use Path on One Side of Roadway

Shared Use Path on Both Sides of Roadway



Roundabout



Priority Pedestrian Crossings

Note: The road network shown shall not prescribe their exact alignment or locations but rather illustrate the need for an interconnected mobility network.

APPENDIX II

Illustrative Concept Plan

Riverview Town Centre
Special Area

Edmonton, Alberta