

THE CITY OF EDMONTON

BYLAW 20523

**CLOSURE OF A PORTION OF SURPLUS ROAD RIGHT-OF-WAY LOCATED ALONG
THE WEST SIDE OF 50 STREET NW, BETWEEN 72 AVENUE NW AND THE RAIL
LINE, DAVIES INDUSTRIAL EAST**

Whereas, pursuant to section 22 of the *Municipal Government Act*, R.S.A. 2000, c. M-26, a council of a municipality may by bylaw close road within the municipality; and

Whereas, pursuant to sections 22 and 606 of the *Municipal Government Act*, a bylaw closing a road must be advertised; and

Whereas, pursuant to section 22 of the *Municipal Government Act*, before a bylaw closing a road is passed, a person who claims to be prejudicially affected by the bylaw, or that person's agent must be given an opportunity to be heard by the council; and

Edmonton City Council enacts:

PART I - PURPOSE, DEFINITIONS AND INTERPRETATION

- | | | |
|--------------------|-----|---|
| PURPOSE | 1 | The purpose of this bylaw is to close a portion of road as set out in Schedule "A" to this bylaw. |
| DEFINITIONS | 2 | In this bylaw, unless the context otherwise requires: |
| | (a) | " City " means the municipal corporation of the City of Edmonton; |
| | (b) | " Council " means the Municipal Council of the City of Edmonton; |
| | (c) | " Registrar " means the Registrar of Titles as defined by the <i>Land Titles Act</i> , R.S.A. 2000, c. L-4 |

PART II - ROAD CLOSURE

3 All of that portion of road shown on Schedule “A” and generally described in Attachment 1 attached to and forming part of this bylaw, is hereby closed.

4 When the Registrar issues a certificate or certificates of title with respect to the former portion of road closed by this bylaw:

(a) the title or titles so issued shall except thereout all mines and minerals and the City will continue to own the mines and minerals if it owned them prior to the creation of the title or titles; and

(b) Attachment 1 is deemed to include the full legal description of the lands comprising the portion of road closed by this bylaw.

READ a first time this	day of	, A.D. 2023;
READ a second time this	day of	, A.D. 2023;
READ a third time this	day of	, A.D. 2023;
SIGNED and PASSED this	day of	, A.D. 2023.

THE CITY OF EDMONTON

MAYOR

CITY CLERK

BYLAW 20523

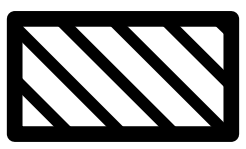
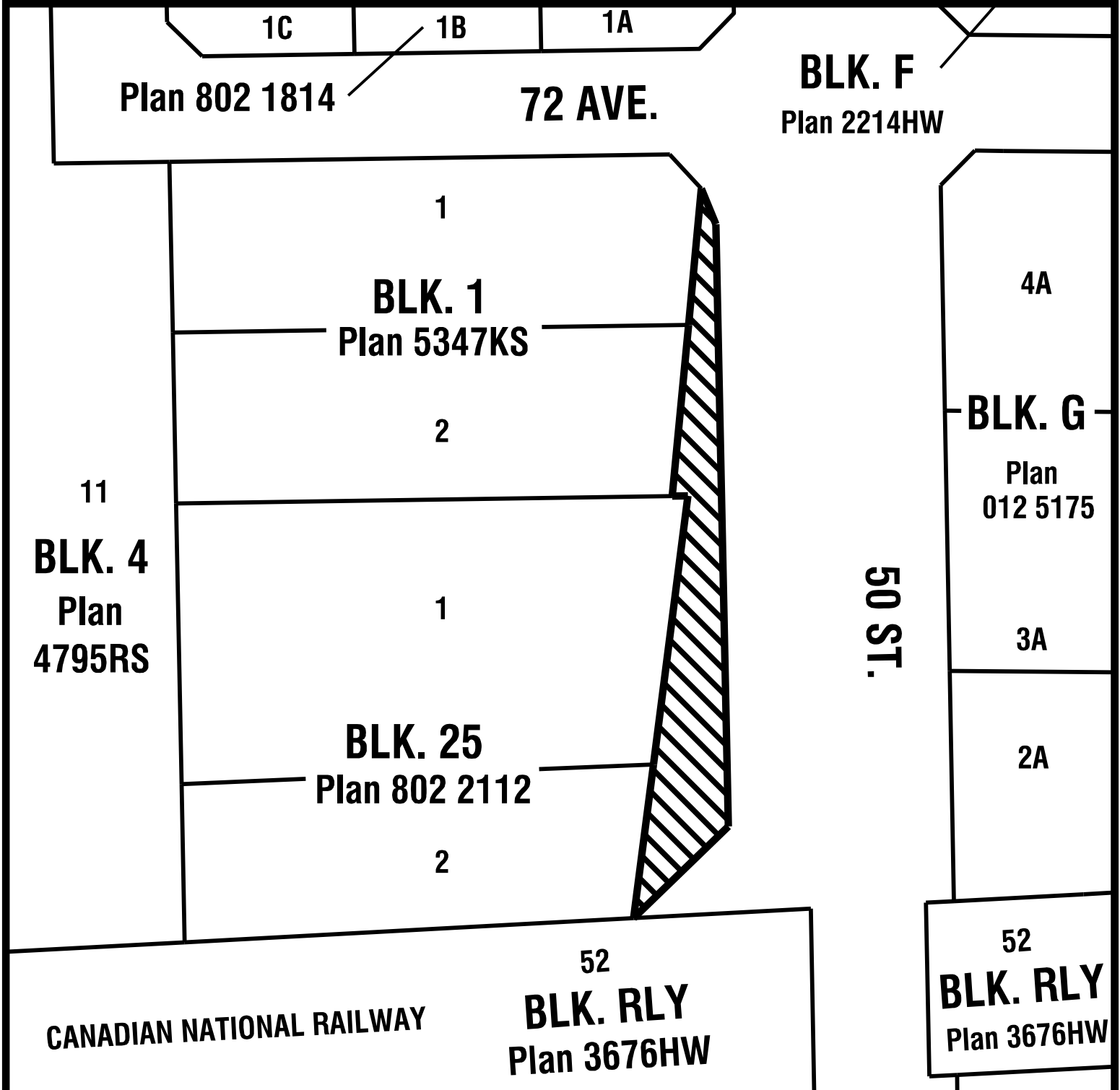

PROPOSED CLOSURE SHOWN AS



ATTACHMENT 1

FIRSTLY

ALL THAT PORTION OF ROAD PLAN 832 2911 LYING WITHIN AREA A, PLAN 232 _____ CONTAINING 0.008 HECTARES (0.020 ACRES) MORE OR LESS EXCEPTING THEREOUT ALL MINES AND MINERALS

SECONDLY

ALL THAT PORTION OF ROAD PLAN 832 2911 LYING WITHIN AREA B, PLAN 232 _____ CONTAINING 0.020 HECTARES (0.049 ACRES) MORE OR LESS EXCEPTING THEREOUT ALL MINES AND MINERALS

THIRDLY

ALL THAT PORTION OF ROAD PLAN 792 3080 LYING WITHIN AREA C, PLAN 232 _____ CONTAINING 0.044 HECTARES (0.109 ACRES) MORE OR LESS EXCEPTING THEREOUT ALL MINES AND MINERALS

FOURTHLY

ALL THAT PORTION OF ROAD PLAN 792 3080 LYING WITHIN AREA D, PLAN 232 _____ CONTAINING 0.026 HECTARES (0.064 ACRES) MORE OR LESS EXCEPTING THEREOUT ALL MINES AND MINERALS