

THE CITY OF EDMONTON

BYLAW 19795

CLOSURE OF LANES BOUNDED BY STONY PLAIN ROAD NW, 125 STREET NW AND 105 AVENUE NW, WESTMOUNT

Whereas, pursuant to section 22 of the *Municipal Government Act*, R.S.A. 2000, c. M-26, a council of a municipality may by bylaw close road within the municipality; and

Whereas, pursuant to sections 22 and 606 of the *Municipal Government Act*, a bylaw closing a road must be advertised; and

Whereas, pursuant to section 22 of the *Municipal Government Act*, before a bylaw closing a road is passed, a person who claims to be prejudicially affected by the bylaw, or that person's agent must be given an opportunity to be heard by the council; and

Edmonton City Council enacts:

PART I - PURPOSE, DEFINITIONS AND INTERPRETATION

- | | | |
|--------------------|-----|---|
| PURPOSE | 1 | The purpose of this bylaw is to close a portion of road as set out in Schedule "A" to this bylaw. |
| DEFINITIONS | 2 | In this bylaw, unless the context otherwise requires: |
| | (a) | " City " means the municipal corporation of the City of Edmonton; |
| | (b) | " Council " means the Municipal Council of the City of Edmonton; |
| | (c) | " Registrar " means the Registrar of Titles as defined by the <i>Land Titles Act</i> , R.S.A. 2000, c. L-4 |

PART II - ROAD CLOSURE

- 3 All of that portion of road shown on Schedule “A” and generally described in Attachment 1 attached to and forming part of this bylaw, is hereby closed.
- 4 When the Registrar issues a certificate or certificates of title with respect to the former portion of road closed by this bylaw:
- (a) the title or titles so issued shall except thereout all mines and minerals and the City will continue to own the mines and minerals if it owned them prior to the creation of the title or titles; and
 - (b) Attachment 1 is deemed to include the full legal description of the lands comprising the portion of road closed by this bylaw.

READ a first time this	day of	, A.D. 2023;
READ a second time this	day of	, A.D. 2023;
READ a third time this	day of	, A.D. 2023;
SIGNED and PASSED this	day of	, A.D. 2023.

THE CITY OF EDMONTON

MAYOR

CITY CLERK

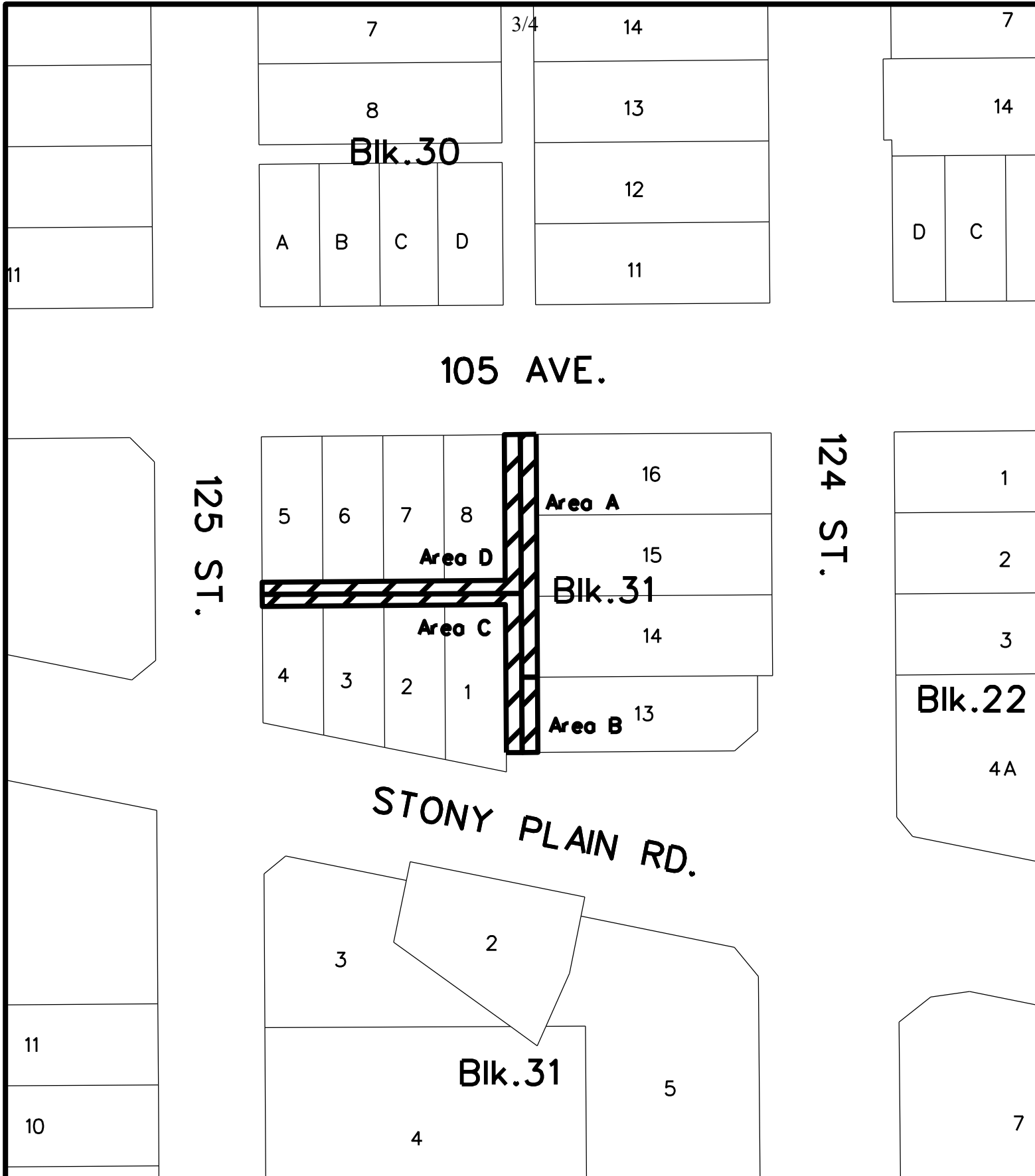

PROPOSED CLOSURE SHOWN AS

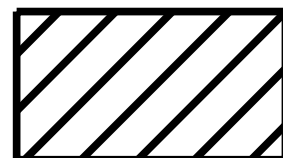

ATTACHMENT 1

PLAN RN22, BLOCK 31

ALL THAT PORTION OF UNNAMED LANE LYING WITHIN AREA A, PLAN 232 _____
AS SURVEYED BY JASON C. WORKMAN
EXCEPTING THEREOUT ALL ALL MINES AND MINERALS

AND

PLAN RN22, BLOCK 31

ALL THAT PORTION OF UNNAMED LANE LYING WITHIN AREA B, PLAN 232 _____
AS SURVEYED BY JASON C. WORKMAN
EXCEPTING THEREOUT ALL ALL MINES AND MINERALS

AND

PLAN RN22, BLOCK 31

ALL THAT PORTION OF UNNAMED LANE
AND

PLAN 2604AM, BLOCK 31

ALL THAT PORTION OF UNNAMED LANE
LYING WITHIN AREA C, PLAN 232 _____
AS SURVEYED BY JASON C. WORKMAN
EXCEPTING THEREOUT ALL MINES AND MINERALS

AND

PLAN RN22, BLOCK 31

ALL THAT PORTION OF UNNAMED LANE
AND

PLAN 2604AM, BLOCK 31

ALL THAT PORTION OF UNNAMED LANE
LYING WITHIN AREA D, PLAN 232 _____
AS SURVEYED BY JASON C. WORKMAN
EXCEPTING THEREOUT ALL MINES AND MINERALS