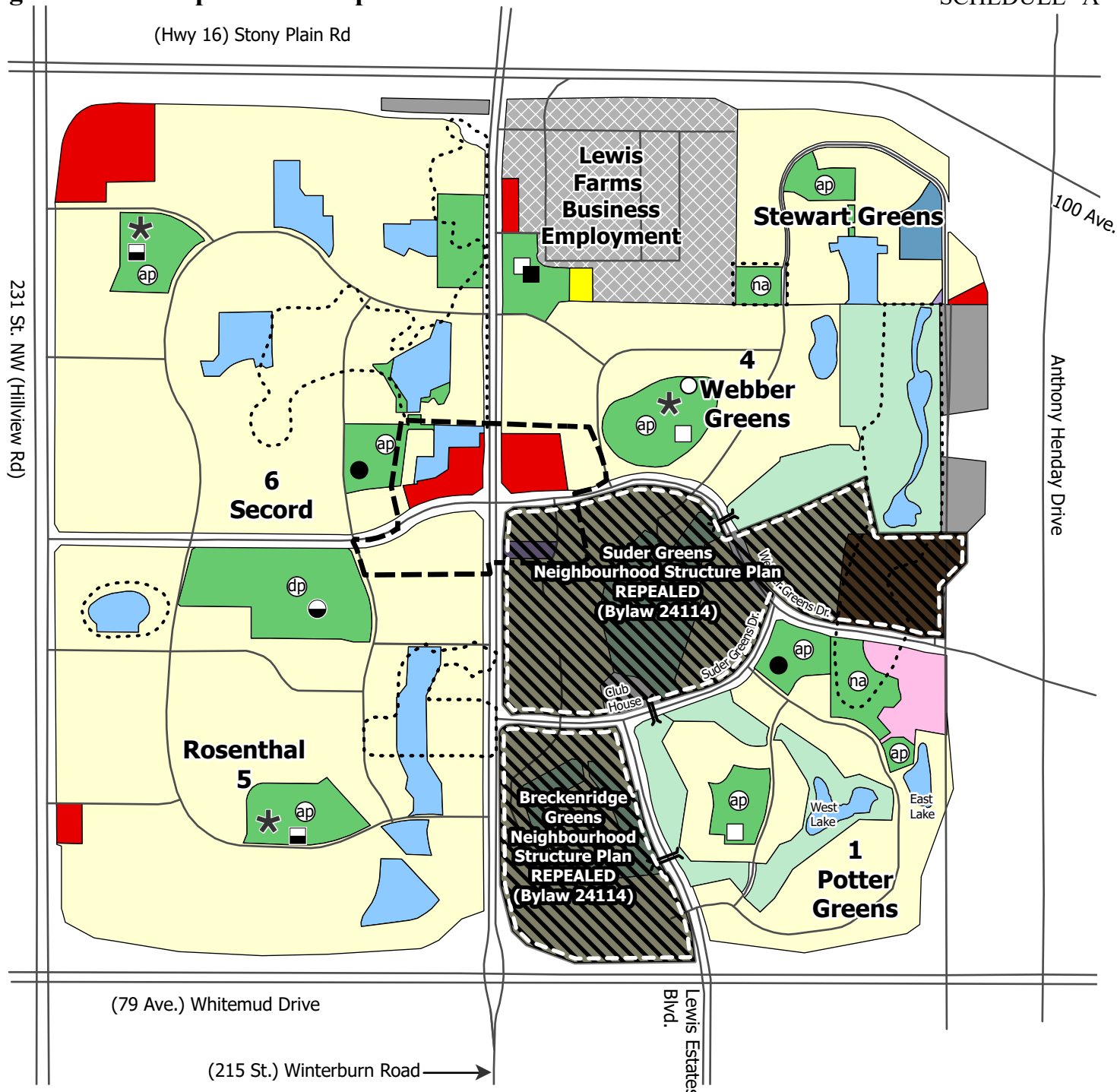

Figure 8.0 Development Concept



**BYLAW 24115
AMENDMENT TO
LEWIS FARMS
Area Structure Plan
(as amended)**



- | | | |
|---|----------------------|---------------------------------|
| Residential | Neighbourhood Park | Separate Elementary/Junior High |
| Mixed Use Area | District Park | Separate High School |
| Commercial | Natural Area Park | Public Elementary |
| Business Industrial | Stormwater Lake | Public Elementary/Junior High |
| Business Employment | Institutional | Public Junior High |
| Potential Private Recreation or Business Employment | Public Utility | Community Centre |
| Golf Course | Transit Terminal/TOD | Grade Separated Crossing |
| School Site | Community League | Natural Area |
| | Separate Elementary | |

Note: Location of collector roads and configuration of stormwater management facilities are subject to minor revisions during subdivision and rezoning of the neighbourhood and may not be developed exactly as illustrated.