

THE CITY OF EDMONTON

BYLAW 17561

CLOSURE OF A PORTION OF 153 AVENUE NW ROAD RIGHT-OF-WAY, KIRKNESS

Whereas, pursuant to section 22 of the *Municipal Government Act*, R.S.A. 2000, c. M-26, a council of a municipality may by bylaw close a road within the municipality; and

Whereas, pursuant to sections 22 and 606 of the *Municipal Government Act*, a bylaw closing a road must be advertised; and

Whereas, pursuant to section 22 of the *Municipal Government Act*, before a bylaw closing a road is passed, a person who claims to be prejudicially affected by the bylaw, or that person's agent must be given an opportunity to be heard by the council; and

Whereas, pursuant to sections 63 and 66 of the *Municipal Government Act*, a council may by bylaw authorize the revision of all or any of the bylaws of a municipality, and any of the provisions of the revised bylaws are substituted for the previous bylaws, when they have the same effect, operate retrospectively as well as prospectively and are deemed to come into force on the days on which the corresponding previous bylaws came into force;

Edmonton City Council enacts:

PART I - PURPOSE, DEFINITIONS AND INTERPRETATION

- PURPOSE** 1 The purpose of this bylaw is to close a portion of road as set out in Schedule "A" to this bylaw.
- DEFINITIONS** 2 In this bylaw, unless the context otherwise requires:
- (a) "**City**" means the municipal corporation of the City of Edmonton;
 - (b) "**Council**" means the Municipal Council of the City of Edmonton; and
 - (c) "**Registrar**" means the Registrar of Titles as defined by the *Land Titles Act*, R.S.A. 2000, c. L-4.

PART II - ROAD CLOSURE

- 3 All of that portion of road shown on Schedule "A" and generally described in Attachment 1 attached to and forming part of this bylaw, is hereby closed.
- 4 When the Registrar issues a certificate or certificates of title with respect to the former portion of road closed by this bylaw:
 - (a) the title or titles so issued shall except thereout all mines and minerals and the City will continue to own the mines and minerals if it owned them prior to the creation of the title or titles; and
 - (b) Attachment 1 is deemed to include the full legal description of the lands comprising the portion of road closed by this bylaw.

READ a first time this	14th	day of	March	, A. D. 2016;
READ a second time this	14th	day of	March	, A. D. 2016;
READ a third time this	14th	day of	March	, A. D. 2016;
SIGNED and PASSED this	14th	day of	March	, A. D. 2016.

}

THE CITY OF EDMONTON



MAYOR



A/CITY CLERK

BYLAW 17561

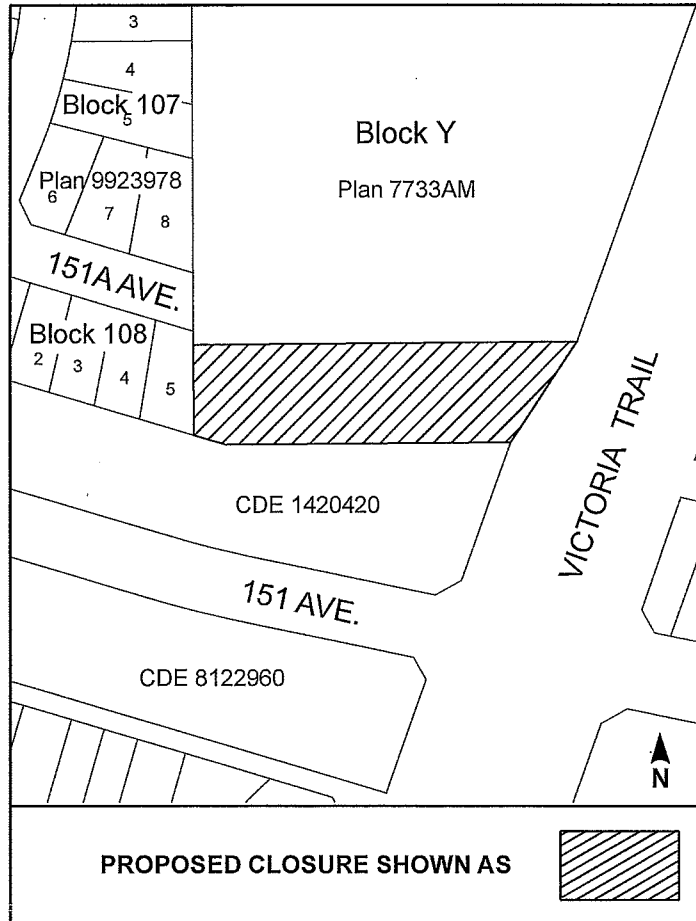

ATTACHMENT 1

Plan 854MC

All that portion of road lying within Area "A" on Plan 162_____

Excepting Thereout All Mines And Minerals