

Project Website Tree Planting Survey Results



PROJECT WEBSITE RESPONSES

Tree Planting Requirements for low-density residential development

Online Survey Results, December 2015



Tree planting requirements for low-density residential development: Project Website Survey Summary, December 2015

In several low-density residential zones in the City (eg. single detached residences, low-density infill, residential small lot) the Zoning Bylaw currently only requires builders and homeowners to install sod, or an equivalent ground cover such as washed gravel or flower beds. No trees or shrubs are required.

Do you consider yourself to be familiar with landscaping in Edmonton?

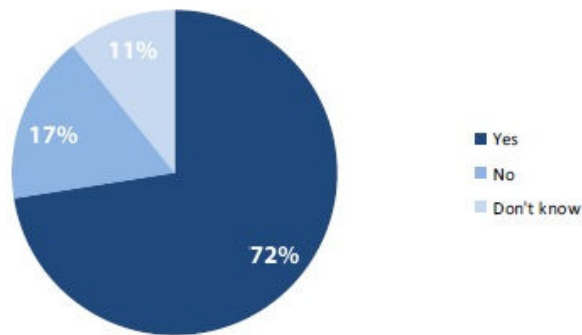

Total Respondents 149

Yes	108
No	25
Don't know	16

Tree planting requirements for low-density residential development: Insight Community Mixed Topic Survey Summary, December 2015

What type of landscaping do you think should be required on residential properties?

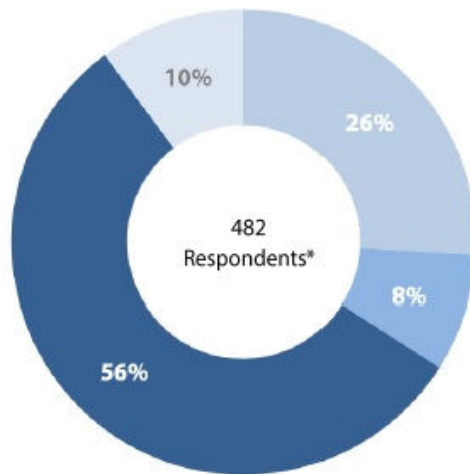





- Grass/sod is enough, no plantings should be required
- Every house should include trees and shrubs, and the amount of trees and shrubs should be the same for all lots, no matter what the size of the lot is.
- Every house should include trees and shrubs, and the amount of trees and shrubs should be based on the size of the lot.
- I don't know what type of landscaping should be required on residential properties

Grass/sod is enough, no plantings should be required	125
Every house should include trees and shrubs, and the amount of trees and shrubs should be the same for all lots, no matter what the size of the lot is.	39
Every house should include trees and shrubs, and the amount of trees and shrubs should be based on the size of the lot.	269
I don't know what type of landscaping should be required on residential properties	49

*Shortly after this survey launch, this question was modified to clarify language. At the time of survey launch, 232 survey participants responded to this question. These 232 responses were not included in the analysis of this question.

Tree planting requirements for low-density residential development: Project Website Survey Summary, December 2015

There are several methods the City can use to calculate how many trees and how many shrubs need to be planted on a lot. Different methods may produce different results. The City is considering four different options. The graphics below illustrate the minimum number of trees and shrubs that would be required using each for a typical lot size or house type. Please rate each of the following options...

Fixed Planting Amount	Depth of Front Yard	Lot Frontage	Housing Type
			
Example: 1 coniferous tree, 1 deciduous tree and 4 shrubs per unit	Example: 0.0 m to 3.0 m (1 tree, 4 shrubs)	Example: 10.1 m to 14.0 m (2 trees and 4 shrubs)	Example: Single family house (3 trees and 4 shrubs)

	Fixed Planting Amount	Depth of Front Yard	Lot Frontage	Housing Type
I really like it	11%	11%	19%	27%
I somewhat like it	25%	33%	39%	17%
I'm neutral about it	17%	20%	14%	18%
I somewhat don't like it	17%	14%	9%	18%
I don't like it at all	27%	19%	16%	17%
I don't know	3%	3%	3%	3%

Tree planting requirements for low-density residential development: Project Website Survey Summary, December 2015

Fixed Planting Amount

Example: 1 coniferous tree, 1 deciduous tree and 4 shrubs per unit

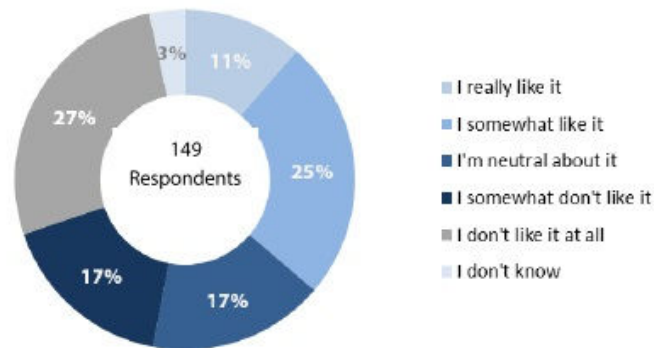
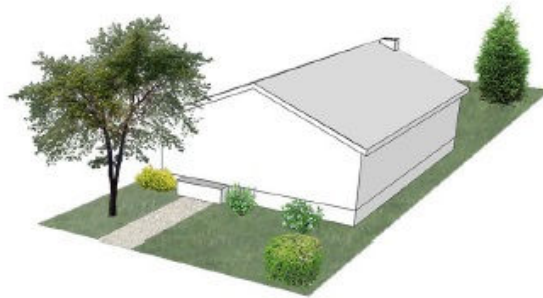

Tree planting requirements for low-density residential development: Project Website Survey Summary, December 2015

Depth of Front Yard (typically the front property line to front of house)
Example: 0.0 m to 3.0 m (1 tree, 4 shrubs)

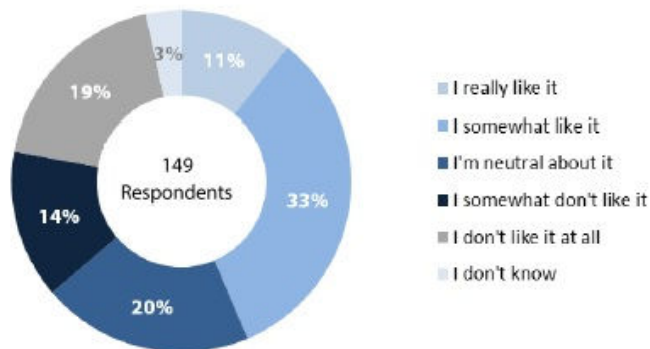
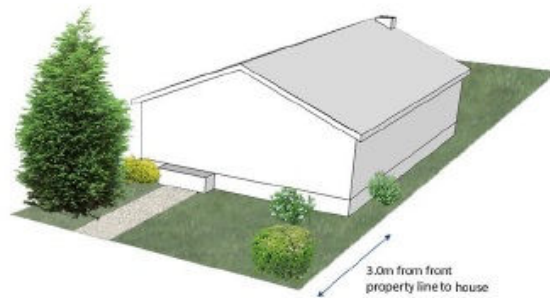

Tree planting requirements for low-density residential development: Project Website Survey Summary, December 2015

Lot Frontage (width of property)
Example: 10.1 m to 14.0 m (2 trees and 4 shrubs)

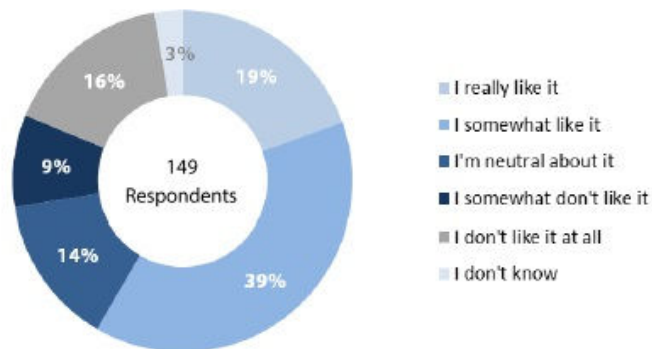

Tree planting requirements for low-density residential development: Project Website Survey Summary, December 2015

Housing Type

Example: Single family house (3 trees and 4 shrubs)

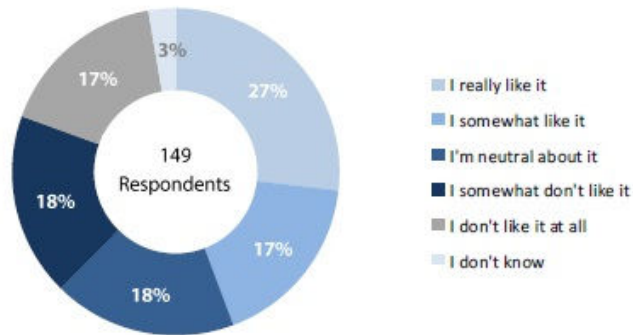
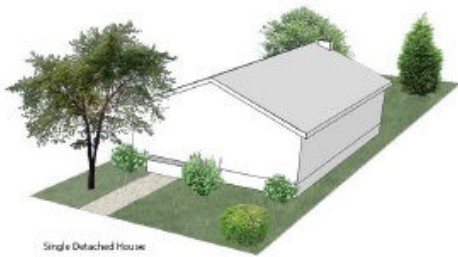

Tree planting requirements for low-density residential development: Project Website Survey Summary, December 2015

Please rate your level of agreement with the following statement: All housing of the same type (eg. all single family homes) should have the same landscaping requirements, no matter where they are located in the City.

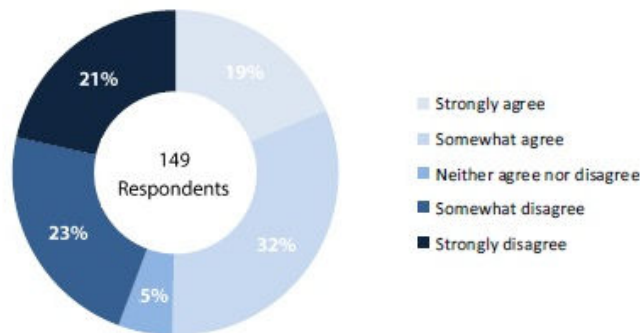

If trees and shrubs are required to be planted on all residential lots in the City, where do you think they should be planted?

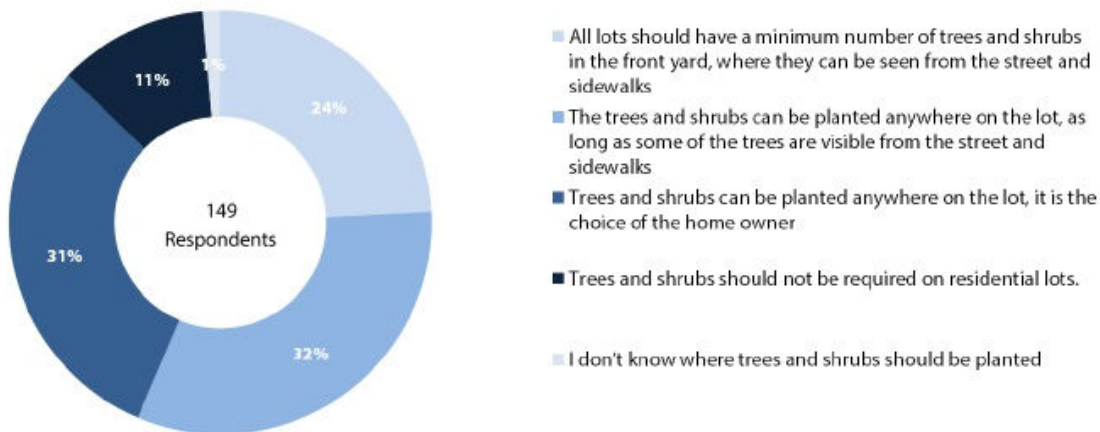

Tree planting requirements for low-density residential development: Project Website Survey Summary, December 2015

When redeveloping a lot, one way to keep the existing mature trees is to count them towards the required trees and shrubs. Keeping this in mind, please tell us whether you agree or disagree with the following statements:

Everything that can be done to keep the older trees should be done

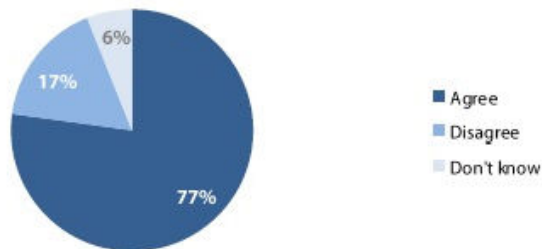

Preserving older trees should be the choice of the home owner

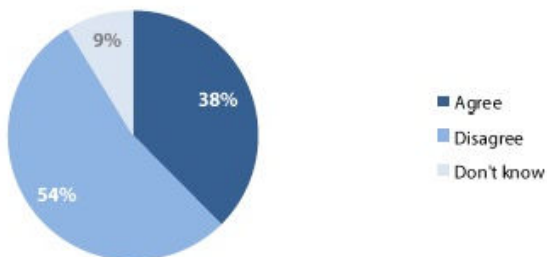

Tree planting requirements for low-density residential development: Project Website Survey Summary, December 2015

What do you think about the approach to preserve existing mature trees?

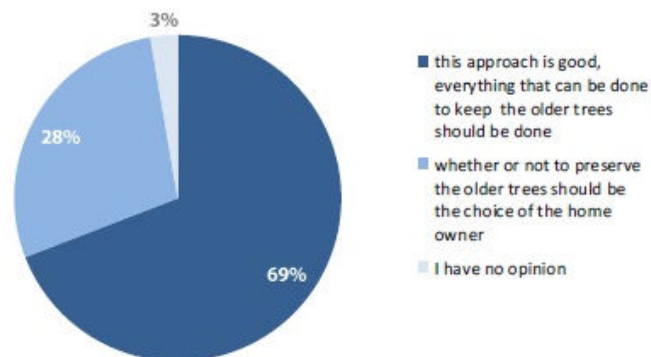

Do you have any other comments about the City requiring trees and shrubs to be planted on residential lots?

"Everything within reason needs to be done to protect old trees in established neighbourhoods. Development is good (new homes and businesses), but it can't be at the expense of the old growth that adds such character and health to the established areas of town."

"The maximum number of trimmed mature trees should be encouraged through municipal tax rebates."

"Existing trees in mature neighbourhoods ought to be preserved. Clear cutting of lots should not be permitted."

"The charm of older neighborhoods is primarily due to the existence of large mature trees. I would not likely buy into or live in an area without this canopy of trees."

Tree planting requirements for low-density residential development:
Project Website Survey Summary, December 2015

106 Comments Received

