

Bylaw 24115

A Bylaw to amend Bylaw 8733, as amended,
being the Lewis Farms Area Structure Plan,

WHEREAS pursuant to the authority granted to it by the Municipal Government Act, on June 14, 1988, the Municipal Council of the City of Edmonton passed Bylaw 8733, as amended, being the Lewis Farms Area Structure Plan; and

WHEREAS Administration has submitted an application to amend Bylaw 8733, as amended, the Lewis Farms Area Structure Plan; and

WHEREAS the Municipal Council of the City of Edmonton considers it desirable to amend the Lewis Farms Area Structure Plan;

NOW THEREFORE after due compliance with the relevant provisions of the Municipal Government Act, RSA 2000, ch. M-26, as amended, the Municipal Council of the City of Edmonton duly assembled enacts as follows:

1. That Bylaw 8733, as amended, being the Lewis Farms Area Structure Plan, is hereby further amended by:
 - a. Adding the following paragraph at the end of The Planning Unit subsection of Chapter One:

“The Breckenridge Greens Neighbourhood Structure Plan (Bylaw 9925) and the Suder Greens Neighbourhood Structure Plan (Bylaw 12949) were repealed upon third-reading of Bylaw 24114 by the Municipal Council of the City of Edmonton as part of the introduction of district plans. Those areas depicted in grey in the first map of this Area Structure Plan indicate areas where a Neighbourhood Structure Plan has been repealed. These areas are deemed to be exempt from the requirements of this Area Structure Plan. Any reference to text, tables, figures, schedules and maps associated with the Breckenridge Greens Neighbourhood Structure Plan or the Suder Greens Neighbourhood Structure Plan within this Area Structure Plan, including any references made in the Appendices to this plan, are no longer in force or effect.”
 - b. Deleting the map entitled “Bylaw 19958 Lewis Farms Area Structure Plan (as amended)” and replacing with the map entitled “Bylaw 24115 Amendment to Lewis Farms Area

Structure Plan (as amended) and Figure 8.0 Development Concept” before the Table of Contents, attached hereto as Schedule “A” and forming part of this bylaw.

- c. Removing Table 1: Land Use and Population Statistics, located in Appendix A - Statistical Profile and replacing with the following:

Refer to the Neighbourhood Structure Plans in effect for land use and population statistics. There is no proposed population density for the area identified in the Lewis Farms Business Employment Neighbourhood Structure Plan as it is proposed to be a non-residential area for business and employment activities to take place within.”

- d. Removing Table 13: Municipal Reserve and Table 14: Allocation of Municipal Reserve and Summary - Municipal Reserve by Sector, located in Appendix A - Statistical Profile
- e. Deleting “Figure 8.0 Development Concept” and replacing it with “Bylaw 24115 Amendment to Lewis Farms Area Structure Plan (as amended) and Figure 8.0 Development Concept” attached hereto as Schedule “A” and forming part of this bylaw.

READ a first time this	25th day of June	, A. D. 2024;
READ a second time this	25th day of June	, A. D. 2024;
READ a third time this	2nd day of October	, A. D. 2024;
SIGNED and PASSED this	2nd day of October	, A. D. 2024.

THE CITY OF EDMONTON



MAYOR



CITY CLERK

Figure 8.0 Development Concept

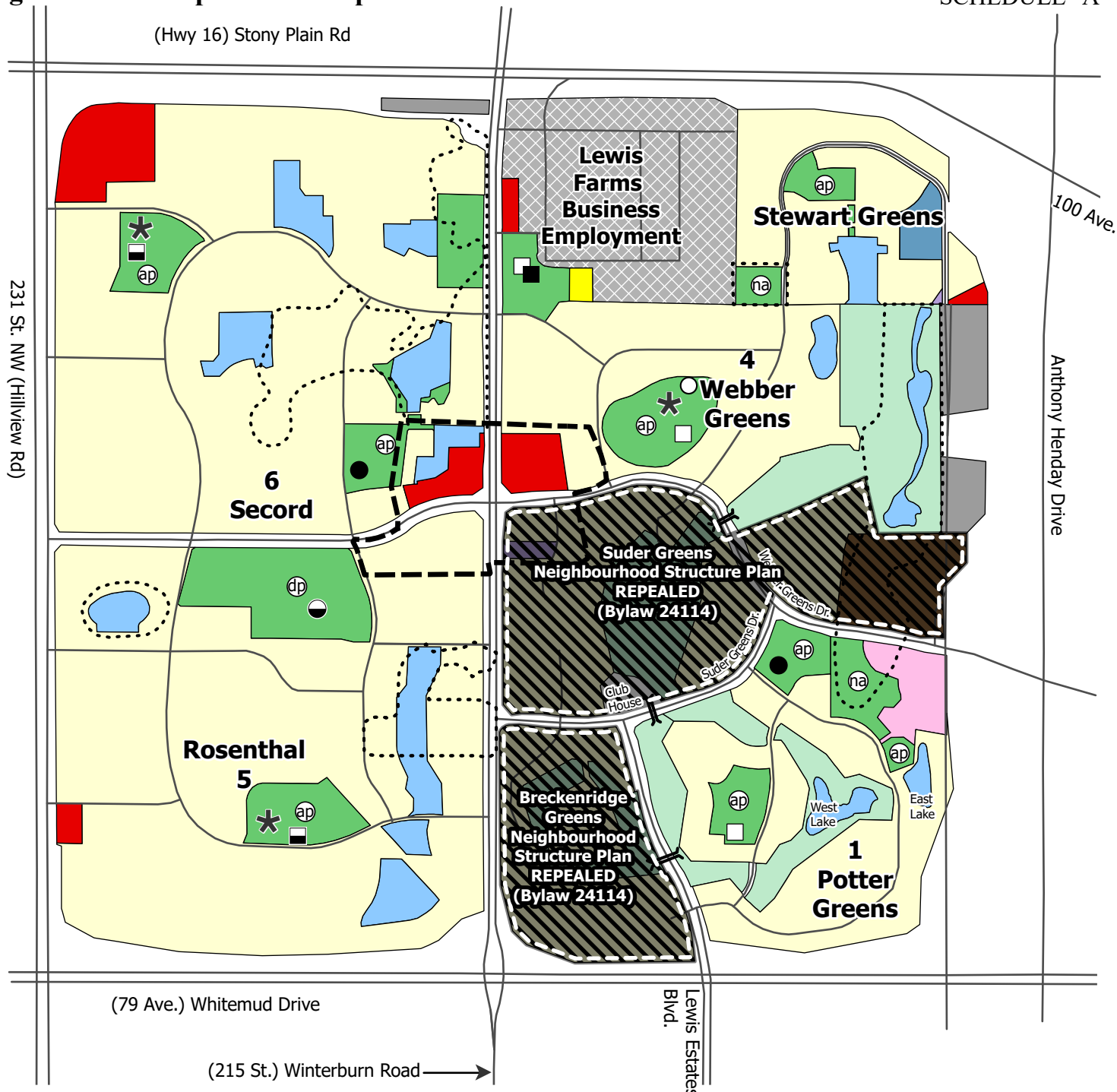

**BYLAW 24115
AMENDMENT TO
LEWIS FARMS
Area Structure Plan
(as amended)**



- | | | |
|---|----------------------|---------------------------------|
| Residential | Neighbourhood Park | Separate Elementary/Junior High |
| Mixed Use Area | District Park | Separate High School |
| Commercial | Natural Area Park | Public Elementary |
| Business Industrial | Stormwater Lake | Public Elementary/Junior High |
| Business Employment | Institutional | Public Junior High |
| Potential Private Recreation or Business Employment | Public Utility | Community Centre |
| Golf Course | Transit Terminal/TOD | Grade Separated Crossing |
| School Site | Community League | Natural Area |
| | Separate Elementary | |

Note: Location of collector roads and configuration of stormwater management facilities are subject to minor revisions during subdivision and rezoning of the neighbourhood and may not be developed exactly as illustrated.