

Bylaw 21004
A Bylaw to amend Bylaw 8733, as amended,
being the Lewis Farms Area Structure Plan

WHEREAS pursuant to the provision of the Planning Act, City Council on June 14, 1988 passed Bylaw 8733, as amended, being the Lewis Farms Area Structure Plan; and

WHEREAS Council found it desirable to amend the Lewis Farms Area Structure Plan through the passage of Bylaws 10881, 12183, 12184, 12488, 13661, 13807, 14579, 14673, 14676, 15364, 15761, 15917, 16273, 18046, 18162, 18677, 18875, 19028, 19076, 19297, 19039, 19958, and 24115; and

WHEREAS an application was received by Administration to further amend the Lewis Farms Area Structure Plan;

NOW THEREFORE after due compliance with the relevant provisions of the Municipal Government Act RSA 2000, ch. M-26, as amended, the Municipal Council of the City of Edmonton duly assembled enacts as follows:

1. That Bylaw 8733, as amended, the Lewis Farms Area Structure Plan is hereby further amended as follows:
 - a. Deleting the map “Bylaw 24115 - Lewis Farms Area Structure Plan” and replacing it with the map “Bylaw 21004 - Amendment to Lewis Farms Area Structure Plan”, attached hereto as Schedule “A” and deleting the “amendment area” indicator, and forming part of this bylaw.
 - b. Deleting “Figure 8.0 - Development Concept” and replacing it with “Figure 8.0 - Development Concept” attached hereto as Schedule “B”, and forming part of this bylaw.
 - c. Deleting “Figure 9.1 West Development Sector Walkway and Transit Plan” and replacing it with “Figure 9.1 West Development Sector Walkway and Transit Plan” attached hereto as Schedule “C”, and forming part of this bylaw.

d. Deleting “Figure 10.1 West Development Sector Engineering Systems” and replacing it with “Figure 10.1 West Development Sector Engineering Systems” attached hereto as Schedule “D”, and forming part of this bylaw.

READ a first time this	24th day of January	, A. D. 2025;
READ a second time this	24th day of January	, A. D. 2025;
READ a third time this	24th day of January	, A. D. 2025;
SIGNED and PASSED this	24th day of January	, A. D. 2025.

THE CITY OF EDMONTON

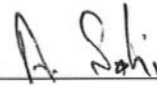

MAYOR



CITY CLERK

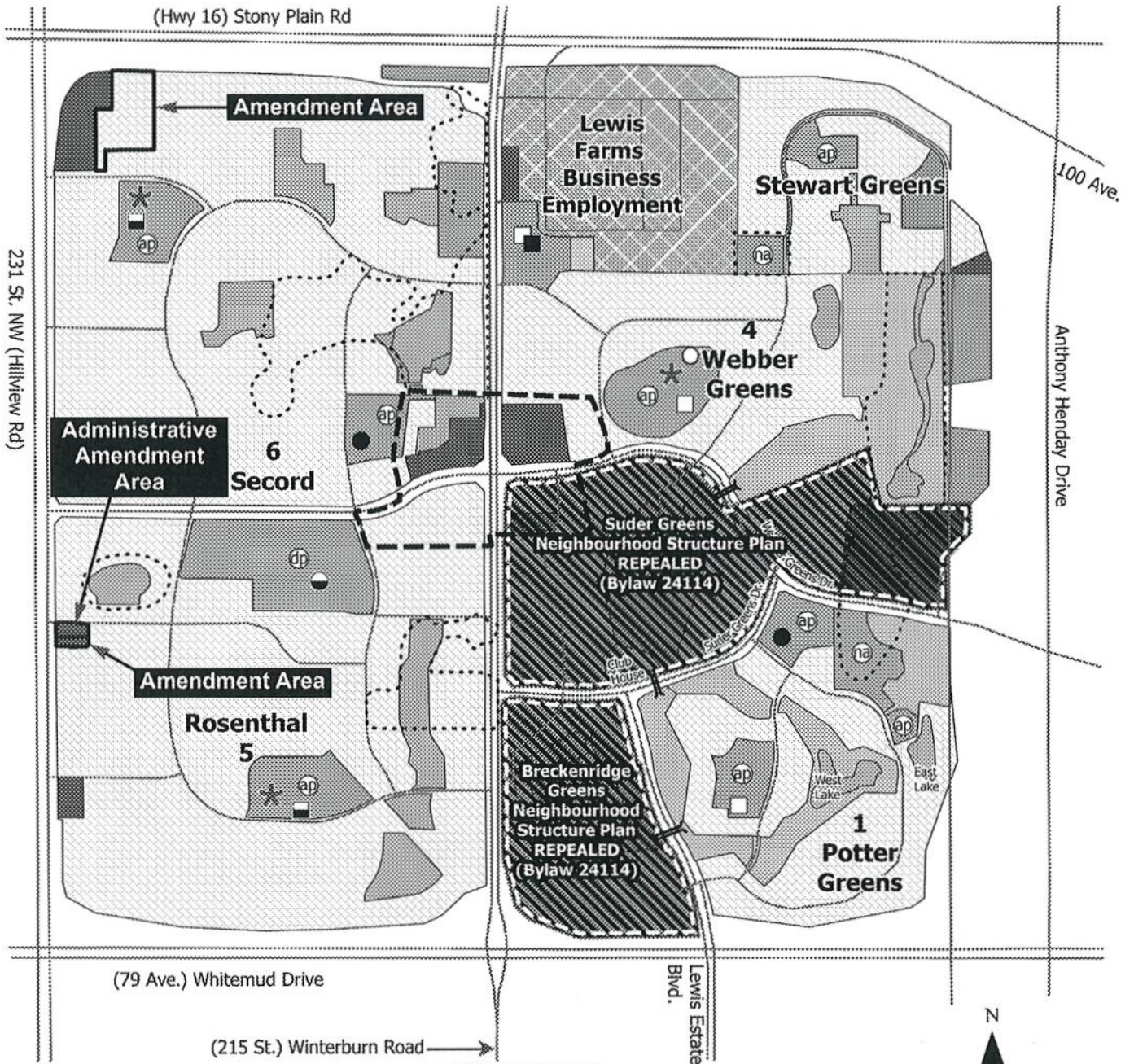

**BYLAW 21004
AMENDMENT TO
LEWIS FARMS
Area Structure Plan
(as amended)**

- | | | |
|---|----------------------|---------------------------------|
| Residential | Stormwater Lake | Separate Elementary/Junior High |
| Golf Course | Commercial | Separate High School |
| School Site | Business Industrial | Public Elementary |
| Neighbourhood Park | Business Employment | Public Elementary/Junior High |
| District Park | Transit Terminal/TOD | Public Junior High |
| Natural Area Park | Institutional | Community Centre |
| Potential Private Recreation or Business Employment | Mixed Use Area | Grade Separated Crossing |
| Public Utility | Community League | Natural Area |
| | Separate Elementary | Amendment Area |

Note: Location of collector roads and configuration of stormwater management facilities are subject to minor revisions during subdivision and rezoning of the neighbourhood and may not be developed exactly as illustrated.



- | | | | | | |
|--|---|--|----------------------|--|---------------------------------|
| | Residential | | Stormwater Lake | | Separate Elementary/Junior High |
| | Golf Course | | Commercial | | Separate High School |
| | School Site | | Business Industrial | | Public Elementary |
| | Neighbourhood Park | | Business Employment | | Public Elementary/Junior High |
| | District Park | | Transit Terminal/TOD | | Public Junior High |
| | Natural Area Park | | Institutional | | Community Centre |
| | Potential Private Recreation or Business Employment | | Mixed Use Area | | Grade Separated Crossing |
| | Public Utility | | Community League | | Natural Area |
| | | | Separate Elementary | | |

Note: Location of collector roads and configuration of stormwater management facilities are subject to minor revisions during subdivision and rezoning of the neighbourhood and may not be developed exactly as illustrated.

Figure 9.1 West Development Sector Walkway and Transit Plan

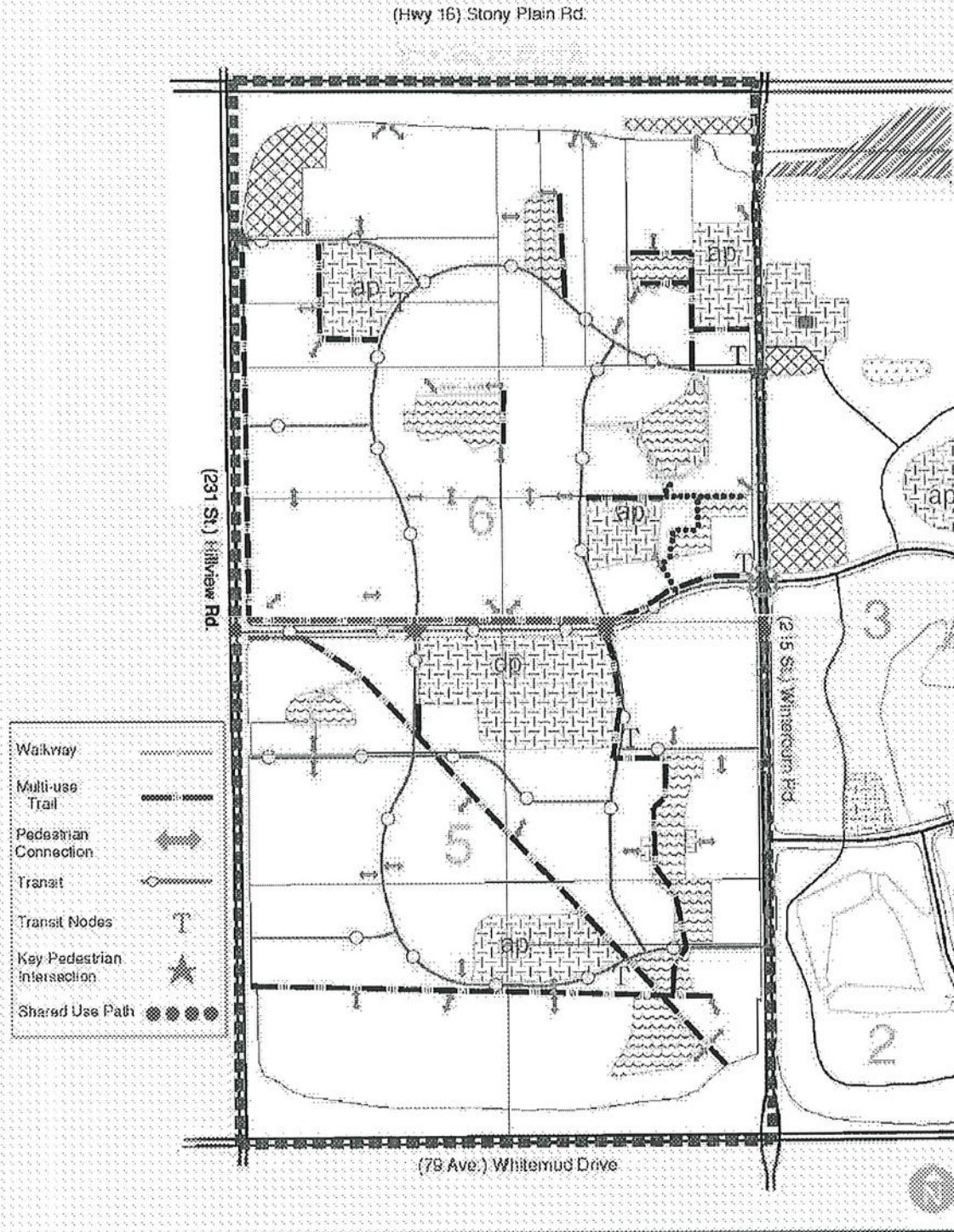

Lewis Farms Area Structure Plan
FIGURE 9.1 - Walking and Transit plan

Figure 10.1 West Development Sector Engineering Systems

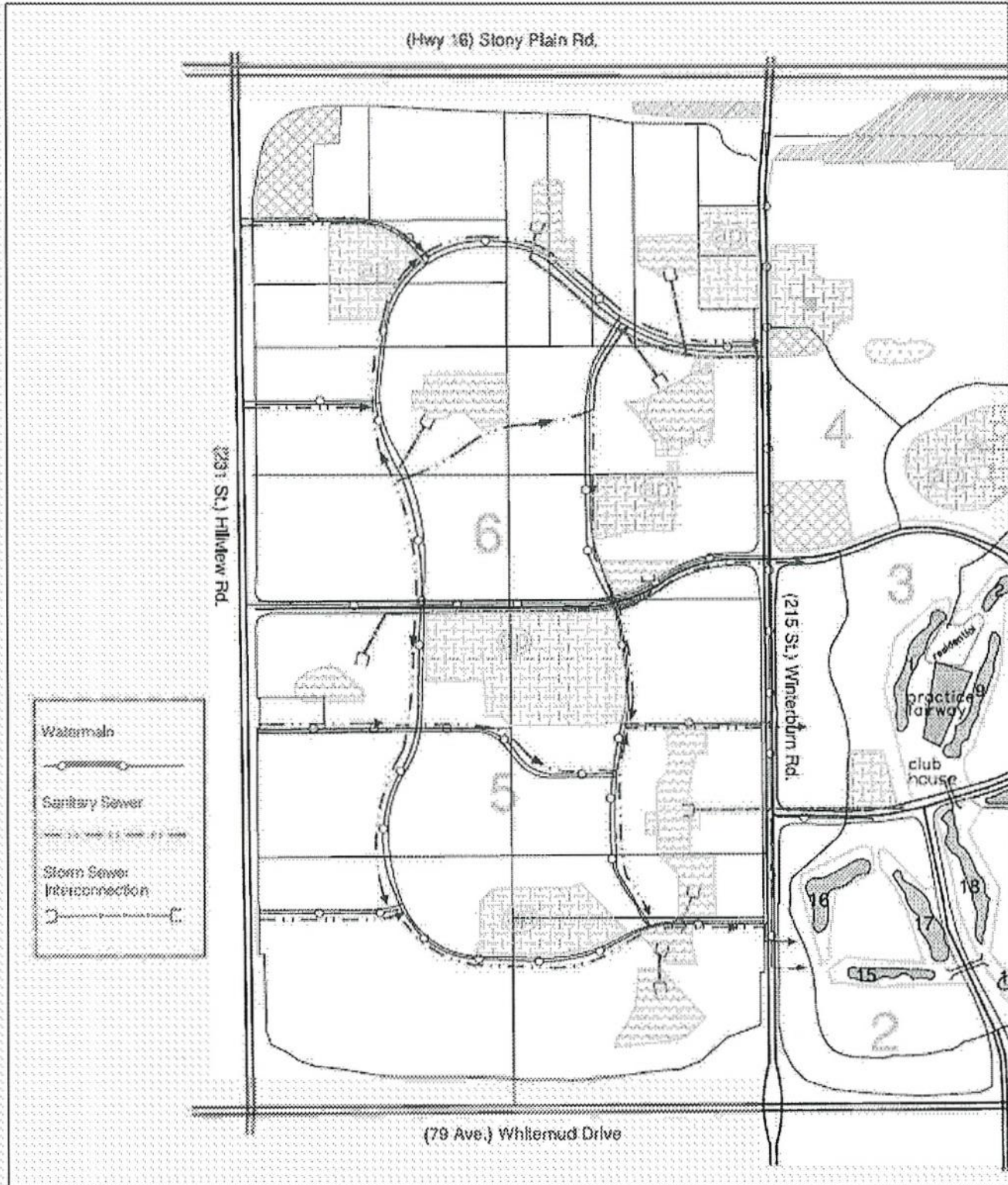

City of Edmonton, Planning and Development Department, 10000 104th Street, Edmonton, Alberta T5C 2G5



**LEWIS FARMS
AREA STRUCTURE PLAN
AMENDMENT
Servicing Plan**