

Bylaw 21042

A Bylaw to amend Charter Bylaw 20001, as amended,  
The Edmonton Zoning Bylaw  
Amendment No. 182

WHEREAS a portion of SW-7-52-25-4; located at 3921 - Winterburn Road NW, Edgemont, Edmonton, Alberta, is specified on the Zoning Map as Agriculture Zone (AG); and

WHEREAS an application was made to rezone the above described property to Neighbourhood Parks and Services Zone (PSN), Public Utility Zone (PU), Medium Scale Residential Zone (RM h16), Small Scale Flex Residential Zone (RSF), and Small-Medium Scale Transition Residential Zone (RSM h14);

NOW THEREFORE after due compliance with the relevant provisions of the Municipal Government Act RSA 2000, ch. M-26, as amended, the Municipal Council of the City of Edmonton duly assembled enacts as follows:

1. The Zoning Map, being Part 1.20 to Charter Bylaw 20001 The Edmonton Zoning Bylaw is hereby amended by rezoning the lands legally described as a portion of SW-7-52-25-4, located at 3921 - Winterburn Road NW, neighbourhood name, Edmonton, Alberta, which lands are shown on the sketch plan attached as Schedule "A", from Agriculture Zone (AG) to Neighbourhood Parks and Services Zone (PSN), Public Utility Zone (PU), Medium Scale Residential Zone (RM h16), Small Scale Flex Residential Zone (RSF), and Small-Medium Scale Transition Residential Zone (RSM h14).

READ a first time this	day of	, A. D. 2025;
READ a second time this	day of	, A. D. 2025;
READ a third time this	day of	, A. D. 2025;
SIGNED and PASSED this	day of	, A. D. 2025.

THE CITY OF EDMONTON

---





MAYOR

---

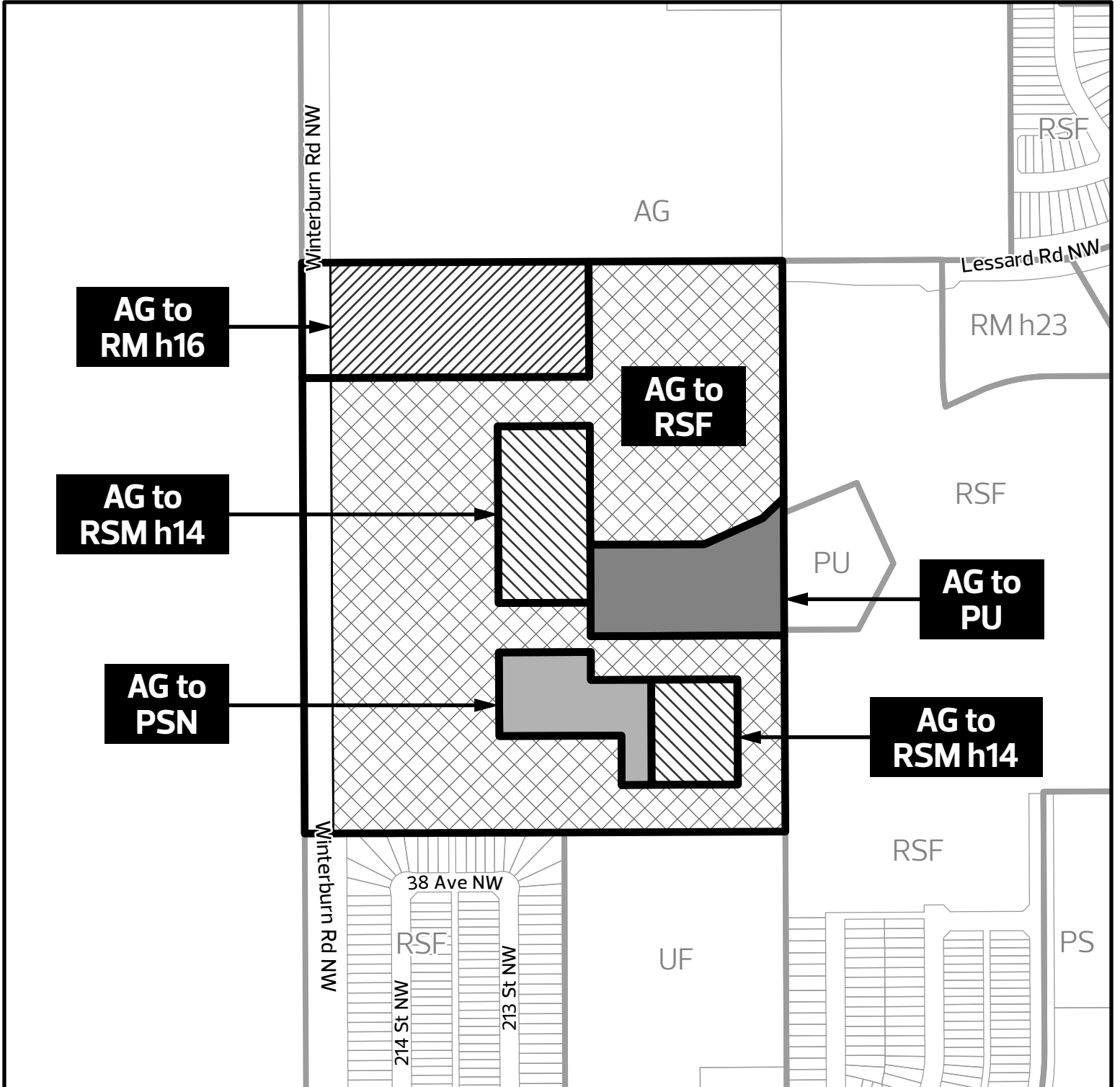
CITY CLERK

# BYLAW 21042



- |   |              |   |               |
|---|--------------|---|---------------|
|  | AG to PSN    |  | AG to RSF     |
|  | AG to PU     |  | AG to RSM h14 |
|  | AG to RM h16 |   |               |

