

**THE CITY OF EDMONTON**

**BYLAW 21177**

**CLOSURE OF A PORTION OF 101A AVENUE (JUDY PADUA WAY)**

Whereas, pursuant to section 22 of the *Municipal Government Act*, R.S.A. 2000, c. M-26, a council of a municipality may by bylaw close road within the municipality; and

Whereas, pursuant to sections 22 and 606 of the *Municipal Government Act*, a bylaw closing a road must be advertised; and

Whereas, pursuant to section 22 of the *Municipal Government Act*, before a bylaw closing a road is given second reading, council must hold a public hearing; and

Edmonton City Council enacts:

**PART I - PURPOSE, DEFINITIONS AND INTERPRETATION**

<b>PURPOSE</b>	1	The purpose of this bylaw is to close a portion of road as set out in Schedule “A” to this bylaw.
<b>DEFINITIONS</b>	2	In this bylaw, unless the context otherwise requires: <ul style="list-style-type: none"><li>(a) “<b>City</b>” means the municipal corporation of the City of Edmonton;</li><li>(b) “<b>Council</b>” means the Municipal Council of the City of Edmonton;</li><li>(c) “<b>Registrar</b>” means the Registrar of Titles as defined by the <i>Land Titles Act</i>, R.S.A. 2000, c. L-4</li></ul>

**PART II - ROAD CLOSURE**

- 3 All of that portion of road shown on Schedule “A” and generally described in Attachment 1 attached to and forming part of this bylaw, is hereby closed.
- 4 When the Registrar issues a certificate or certificates of title with respect to the former portion of road closed by this bylaw:
- (a) the title or titles so issued shall except thereout all mines and minerals and the City will continue to own the mines and minerals if it owned them prior to the creation of the title or titles; and
  - (b) Attachment 1 is deemed to include the full legal description of the lands comprising the portion of road closed by this bylaw.

READ a first time this	day of	, A.D. 2025;
READ a second time this	day of	, A.D. 2025;
READ a third time this	day of	, A.D. 2025;
SIGNED and PASSED this	day of	, A.D. 2025.

THE CITY OF EDMONTON

\_\_\_\_\_  
MAYOR

\_\_\_\_\_  
CITY CLERK

**BYLAW 21177**

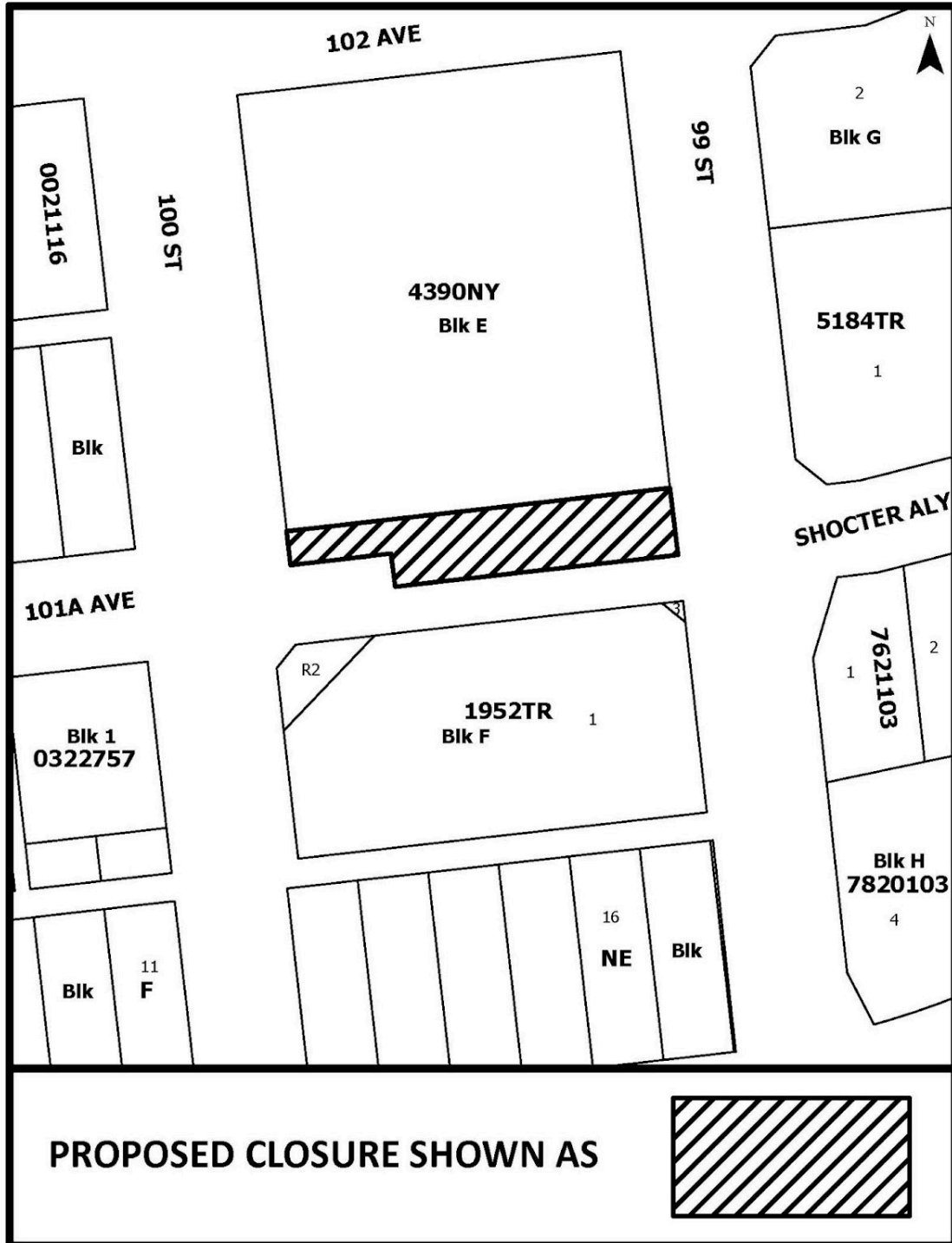

## **ATTACHMENT 1**

PLAN 4390NY

ALL THAT PORTION OF 101A AVENUE

LYING WITHIN AREA A AS SHOWN ON PLAN \_\_\_\_\_

EXCEPTING THEREOUT ALL MINES AND MINERALS