

Charter Bylaw 21232

A Charter Bylaw to amend Charter Bylaw 24001,
being the North Central District Plan

WHEREAS pursuant to the authority granted to it by the Municipal Government Act, as amended by the *City of Edmonton Charter, 2018 Regulation, AR 39/2018*, on October 2, 2024, the Municipal Council of the City of Edmonton passed Charter Bylaw 24001, being the North Central District Plan; and

WHEREAS Council found it desirable from time to time to amend the North Central District Plan; and

WHEREAS Council has amended the North Central District Plan, through the passage of Charter Bylaw 21101; and

WHEREAS an application was received by Administration to amend the North Central District Plan;

NOW THEREFORE after due compliance with the relevant provisions of the Municipal Government Act, RSA 2000, c. M-26, as amended, and as amended by the City of Edmonton Charter, 2018 Regulation, AR 39/2018, the Municipal Council of the City of Edmonton duly assembled enacts as follows:

1. That Charter Bylaw 24001, being the North Central District Plan, is hereby amended as follows:
 - a. Deleting a portion of “Map 1: Heritage and Culture”, excluding the legend, as shown on Schedule “A” and replacing it with the equivalent portion of “Map 1: Heritage and Culture”, excluding the legend, as shown on Schedule “B” attached hereto and forming part of this Charter Bylaw;
 - b. Deleting a portion of “Map 2: Activating Growth to 1.25 Million”, excluding the legend, as shown on Schedule “C” and replacing it with the equivalent portion of

- “Map 2: Activating Growth to 1.25 Million”, excluding the legend, as shown on Schedule “D” attached hereto and forming part of this Charter Bylaw;
- c. Deleting a portion of “Map 3: Nodes and Corridors”, excluding the legend, as shown on Schedule “E” and replacing it with the equivalent portion of “Map 3: Nodes and Corridors”, excluding the legend, as shown on Schedule “F” attached hereto and forming part of this Charter Bylaw;
 - d. Deleting a portion of “Map 4: Land Use Concept to 1.25 Million”, excluding the legend, as shown on Schedule “G” and replacing it with the equivalent portion of “Map 4: Land Use Concept to 1.25 Million”, excluding the legend, as shown on Schedule “H” attached hereto and forming part of this Charter Bylaw; and
 - e. Deleting a portion of “Map 5: Open Space and Natural Areas to 1.25 Million”, excluding the legend, as shown on Schedule “I” and replacing it with the equivalent portion of “Map 5: Open Space and Natural Areas to 1.25 Million”, excluding the legend, as shown on Schedule “J” attached hereto and forming part of this Charter Bylaw.

READ a first time this	30th day of June	, A. D. 2025;
READ a second time this	30th day of June	, A. D. 2025;
READ a third time this	30th day of June	, A. D. 2025;
SIGNED and PASSED this	30th day of June	, A. D. 2025.

THE CITY OF EDMONTON



MAYOR



 CITY CLERK

Schedule "A - J"

Charter Bylaw 21232

Amendment Area

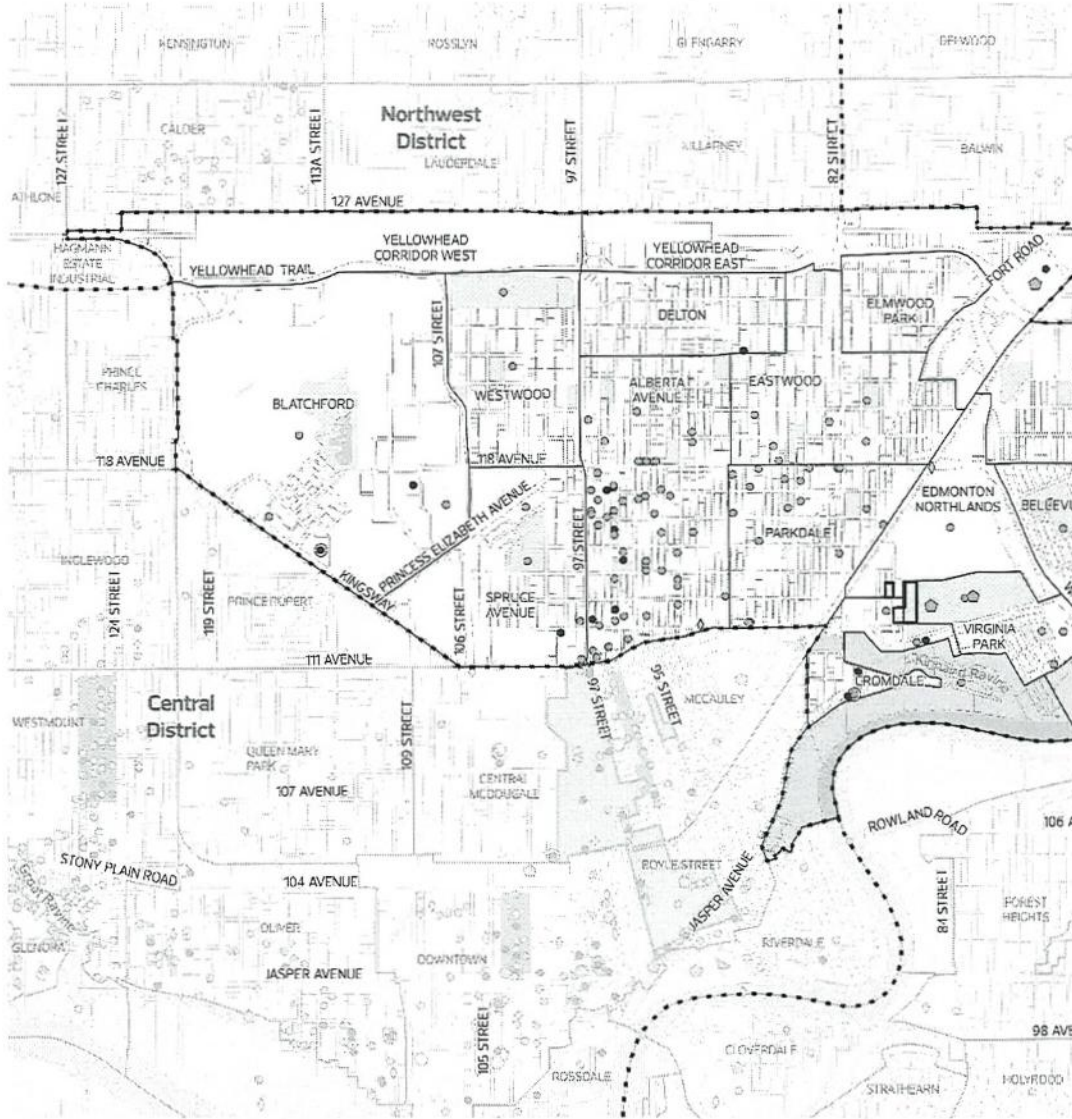

General Information

- Municipal Boundary
- Adjacent Jurisdiction Boundary
- District Plan Boundary
- Neighbourhood Boundary

Transportation/Utility Corridor

- Waterbody
- North Saskatchewan River Valley and Ravine System
- Open Area

City-Owned Public Art

- Art Work
- Multiple Art Works

Built Heritage Sites

- Inventory of Historic Resources in Edmonton
- Municipal Historic Resource
- Provincial Historic Resource

Heritage Character Areas

- Municipal
- Provincial

Cultural Features

- Known Indigenous Cultural Heritage Feature
- Other Cultural Area

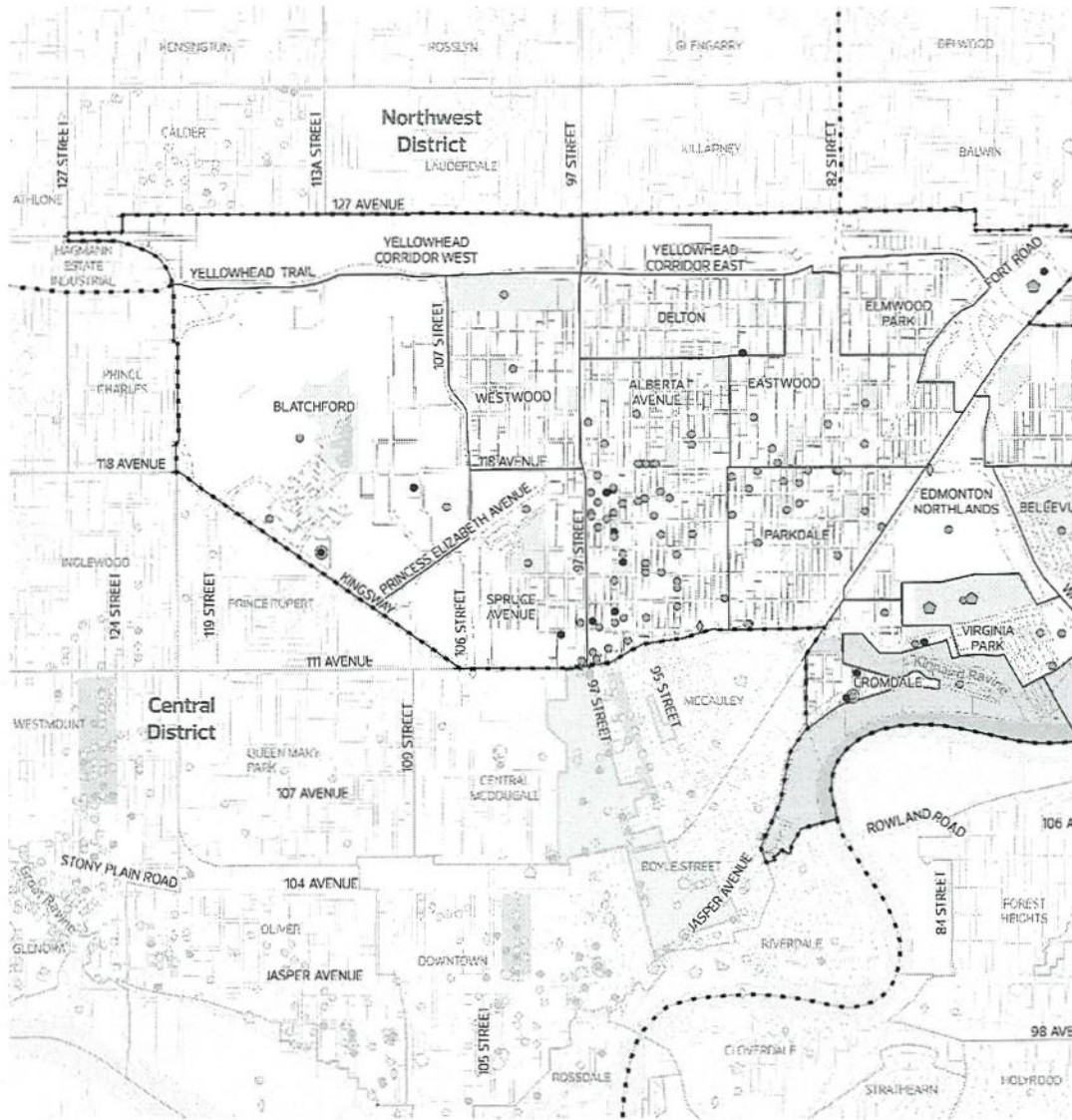

General Information

- Municipal Boundary
- - - Adjacent Jurisdiction Boundary
- ... District Plan Boundary
- ▭ Neighbourhood Boundary

- ▬ Transportation/Utility Corridor
- ▬ Waterbody
- ▬ North Saskatchewan River Valley and Ravine System
- ▬ Open Area

City-Owned Public Art

- ◊ Art Work
- ◊ Multiple Art Works

Built Heritage Sites

- Inventory of Historic Resources in Edmonton
- Municipal Historic Resource
- Provincial Historic Resource

Heritage Character Areas

- ▬ Municipal
- ▬ Provincial

Cultural Features

- ▬ Known Indigenous Cultural Heritage Feature
- ▬ Other Cultural Area

Parcel mapping may not exist exactly as illustrated and is subject to revision during subdivision and rezoning.

Scale: 1:45,000

0 0.25 0.5 Km

Data Updated: 2024 03 01

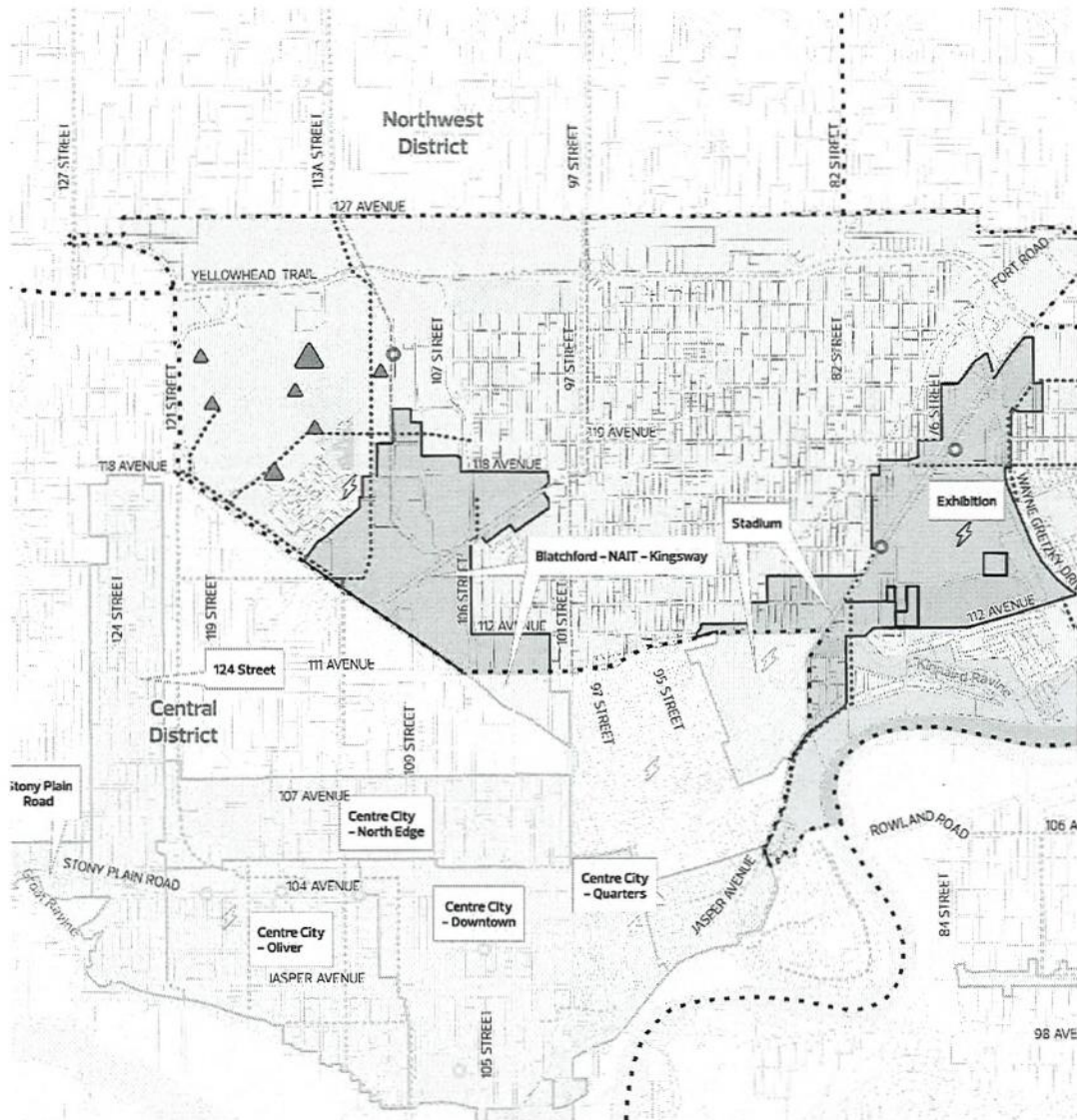

General Information

- Municipal Boundary
- Adjacent Jurisdiction Boundary
- District Plan Boundary
- Transportation/Utility Corridor

- Waterbody
- North Saskatchewan River Valley and Ravine System
- Open Area
- Future Non-Residential Area

Pattern Areas

- Rodeveloping Area
- Developing Area
- Future Growth Area

Priority Growth Areas

- Priority Growth Area

Planned Improvements

- Citywide Mass Transit - Planned
- Mass Transit Station - Planned
- District Connector Bike Route - Planned
- Habitat Greenway
- Urban Greenway

Planned Municipal Park*

- Small (<3 ha)
- Medium (3 ha - 10 ha)
- Large (>10 ha)

District Energy Opportunity Areas

- Current
- Planned

*Small Planned Municipal Park not shown for areas with Area Structure Plans in effect.

Parcel mapping may not exist exactly as illustrated and is subject to revision during subdivision and rezoning.
Scale: 1:45,000
Data Updated: 2024 03 01

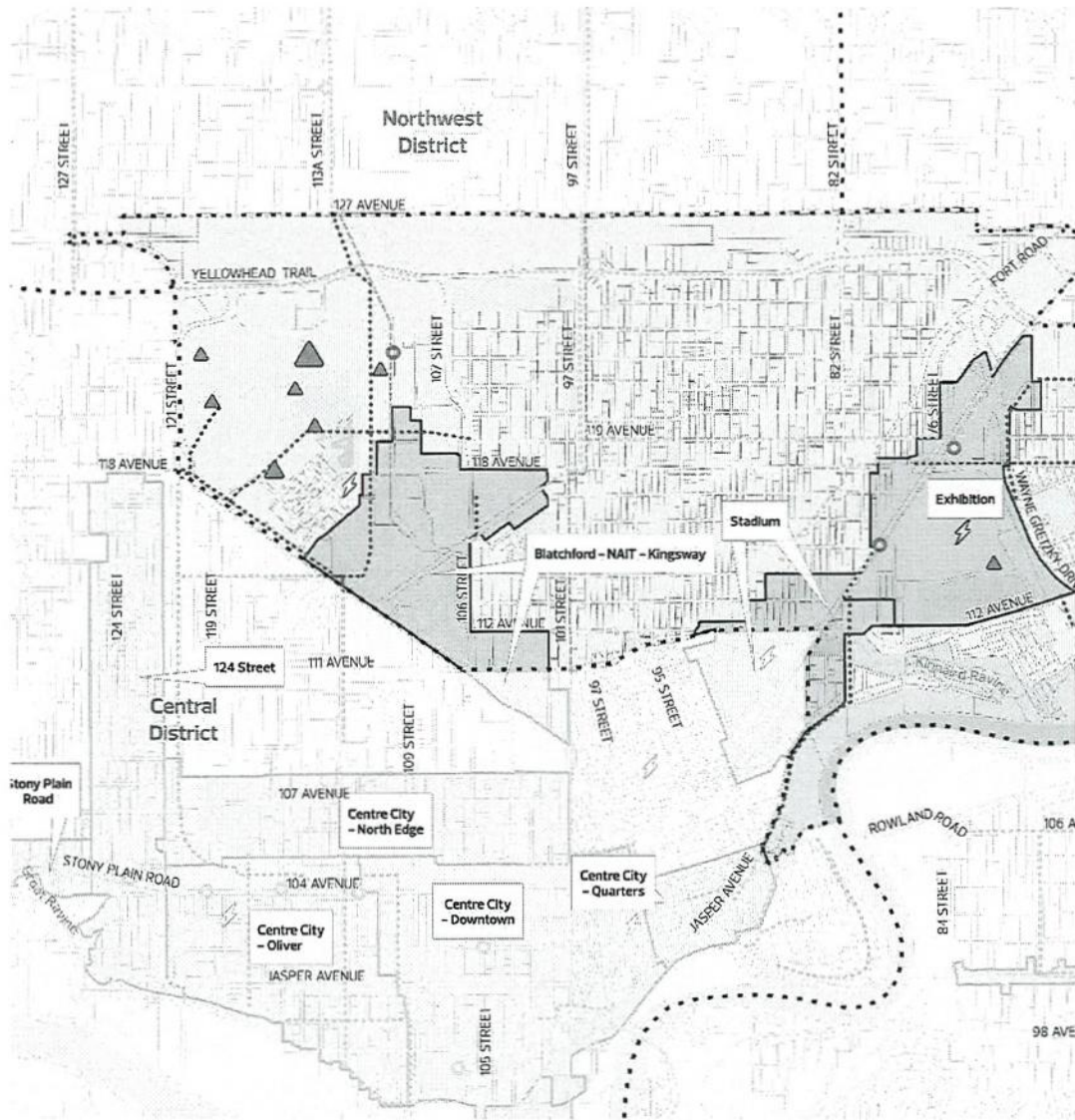

General Information

- Municipal Boundary
- Adjacent Jurisdiction Boundary
- District Plan Boundary
- Transportation/Utility Corridor

Waterbody

- North Saskatchewan River Valley and Ravine System
- Open Area
- Future Non-Residential Area

Pattern Areas

- Redeveloping Area
- Developing Area
- Future Growth Area

Priority Growth Areas

- Priority Growth Area

Planned Improvements

- Citywide Mass Transit - Planned
- Mass Transit Station - Planned
- District Connector Bike Route - Planned
- Habitat Greenway
- Urban Greenway

Planned Municipal Park*

- Small (<3 ha)
- Medium (3 ha - 10 ha)
- Large (>10 ha)

District Energy Opportunity Areas

- Current
- Planned

*Small Planned Municipal Park not shown for areas with Area Structure Plans in effect.

Parcel mapping may not exist exactly as illustrated and is subject to revision during subdivision and rezoning.
 Scale: 1:45,000
 Data Updated: 2024 03 01

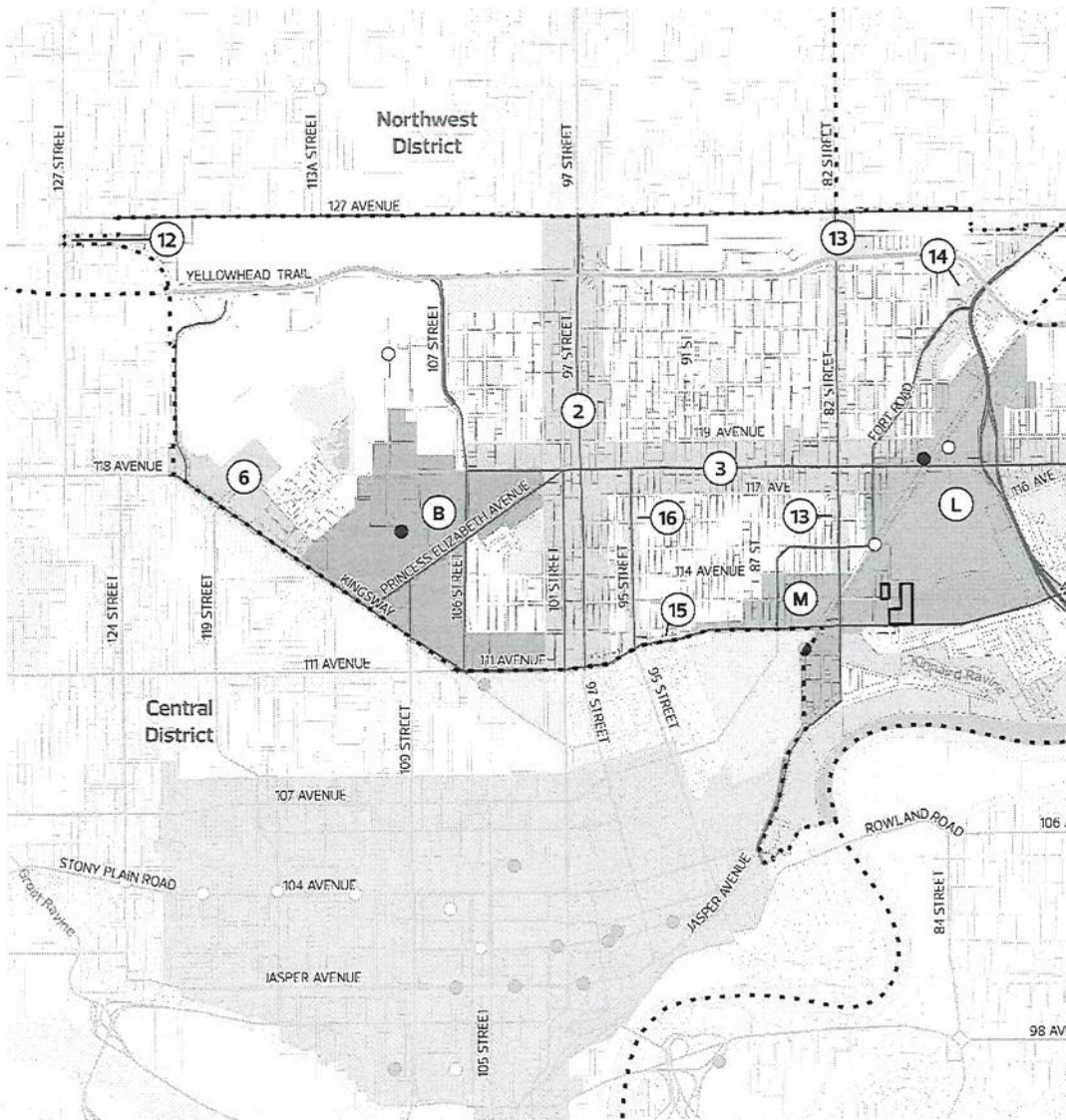

General Information

- Municipal Boundary
- Adjacent Jurisdiction Boundary
- District Plan Boundary
- Transportation/Utility Corridor
- Arterial Roadway
- Freeway/Expressway/Highway

- Waterbody
- North Saskatchewan River Valley and Ravine System
- Open Area

Transit

- Mass Transit Station - Current
- Mass Transit Station - Planned

Nodes and Corridors

- Centre City
- Major Node
- Blatchford-NAIT-Kingsway

- District Node
- Exhibition
- Stadium

- Primary Corridor
- 97 Street
- 118 Avenue
- Kingsway/118 Avenue

- Secondary Corridor
- 127 Street
- 82 Street
- Fort Road
- 111 Avenue
- 95 Street

Letter/number labels as per The City Plan

Note that some roadway alignments are conceptual. Refer to additional Plans in Effect, where applicable, for details.

Parcel mapping may not exist exactly as illustrated and is subject to revision during subdivision and rezoning.
Scale: 1:45,000
Data Updated: 2024 03 01

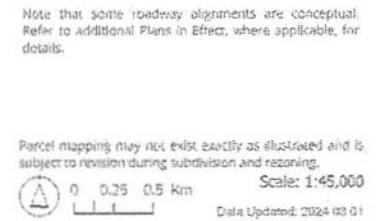

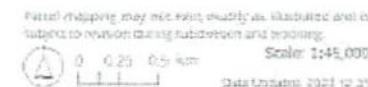

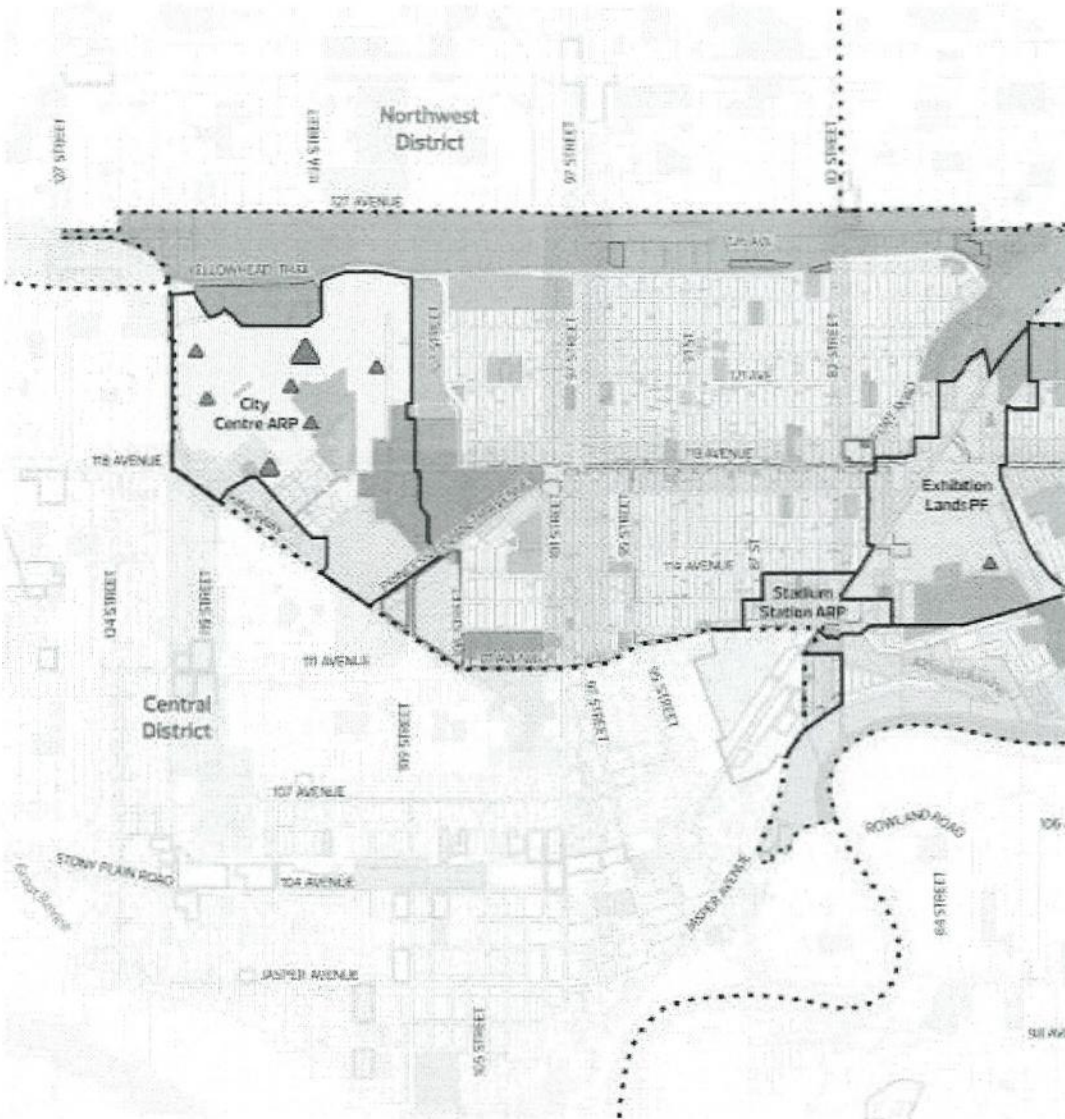

General Information

- Municipal Boundary
- Adjacent Jurisdiction Boundary
- District Plan Boundary
- Plan in Effect - Area Structure Plan/area Redevelopment Plan*
- Plan in Effect - Other*

General Land Use

- Urban Mix
- Commercial/Industrial Employment
- Institutional Employment
- Future Non-Residential Area

- Open Space - Current
- Urban Service
- Agriculture
- Waterbody
- North Saskatchewan River Valley and Ravine System

Planned Municipal Park**

- Small (<3 ha)
- Medium (3 ha - 10 ha)
- Large (>10 ha)

Development Areas

- Node or Corridor Area
- Non-Residential Intensification Area

Design Influences

- Large Site
- Commercial Frontage

*Prior to 2022 boundaries, see map and conceptual Conceptual Plan in Effect for details.
**Planned Municipal Park (PMP) shown for areas with Area Structure Plans in effect.

Future mapping may not exactly reflect this map and is subject to redistricting submissions and numbering.
Scale: 1:45,000
Data Updated: 2022-12-31

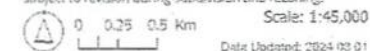

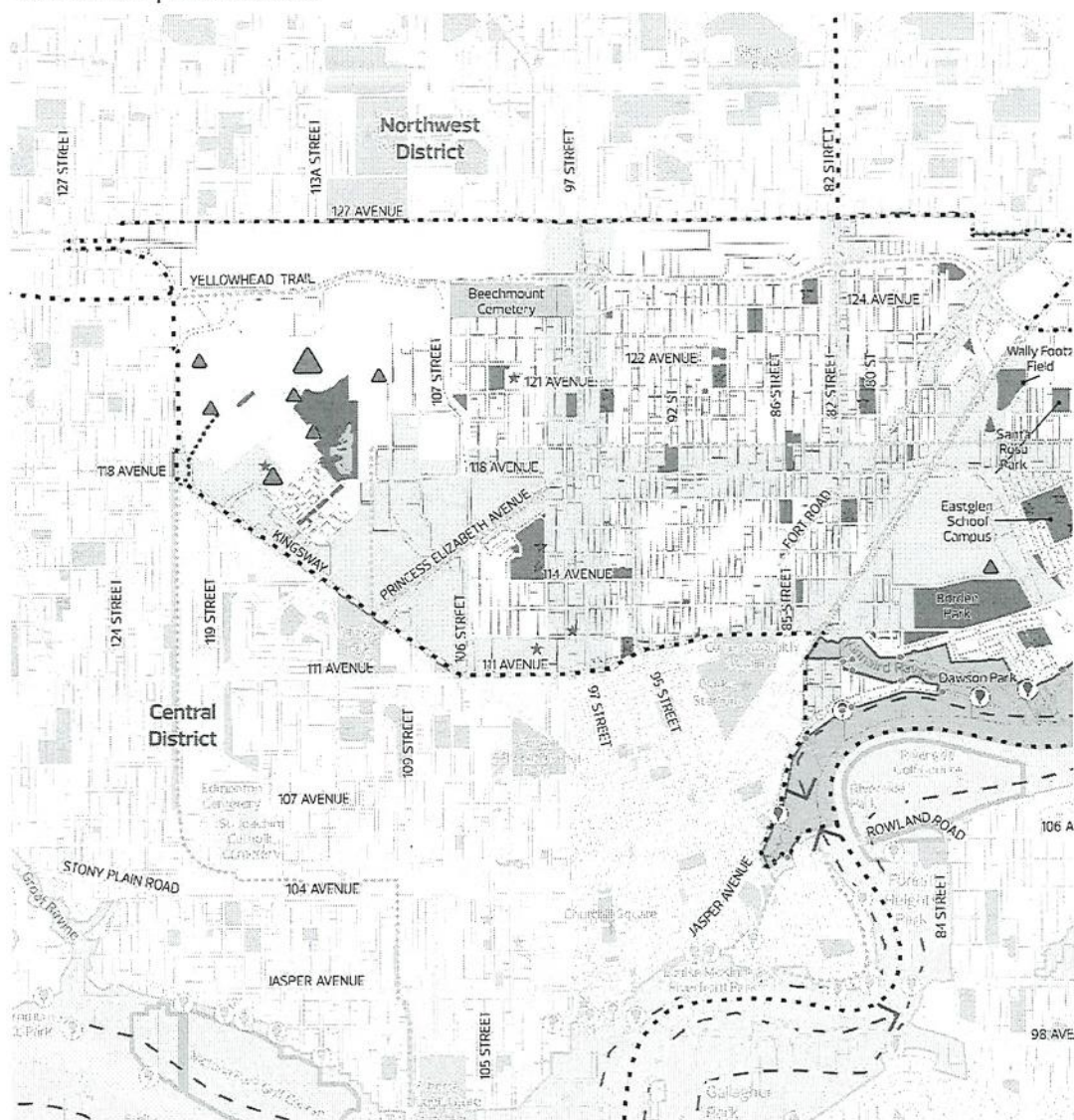

General Information

- Municipal Boundary
- - - Adjacent Jurisdiction Boundary
- ... District Plan Boundary
- Node or Corridor Area
- Transportation/Utility Corridor*

Open Space Connectors and Features

- River Valley Viewpoint - Current
- River Valley Viewpoint - Planned
- River Valley Trail Access

- North Saskatchewan River Valley and Ravine System
- Habitat Greenway
- Urban Greenway
- Major Ecological Connection

Municipal Open Space

- Park - Current**
- Open Space - Supplementary*
- Municipal Golf Course
- Municipal Cemetery

Planned Municipal Park***

- Small (<3 ha)
- Medium (3 ha - 10 ha)
- Large (>10 ha)

Community Assets

- ★ Recreation Centre
- ★ School

Non-Municipal Open Space

- Open Space - Other
- Provincial Park/Protected Area
- Private Golf Course
- Private Cemetery

Other Open Spaces

- Special Purpose Facility

*Transportation/Utility Corridor is not comprehensive and for illustrative purposes only.

**Park - Current and Open Space - Supplementary may include Urban Service Uses.

***Planned Municipal Park locations are conceptual. Refer to the Plan in Effect or other applicable plans for details. Small Planned Municipal Park not shown for areas with Area Structure Plans in effect.

Parcel mapping may not exist exactly as illustrated and is subject to revision during subdivision and rezoning.

0 0.25 0.5 Km

Scale: 1:45,000

Data Updated: 2024 03 01