

Bylaw 21213

A Bylaw to amend Charter Bylaw 20001, as amended,
The Edmonton Zoning Bylaw
Amendment No. 263

WHEREAS Plan 1948RS Blk 3 Lot 1; located at 100 - Windermere Crescent NW, Windermere, Edmonton, Alberta, is specified on the Zoning Map as Rural Residential Zone (RR); and

WHEREAS an application was made to rezone the above described property to Small Scale Flex Residential Zone (RSF) and River Valley Zone (A);

NOW THEREFORE after due compliance with the relevant provisions of the Municipal Government Act RSA 2000, ch. M-26, as amended, the Municipal Council of the City of Edmonton duly assembled enacts as follows:

1. The Zoning Map, being Part 1.20 to Charter Bylaw 20001 The Edmonton Zoning Bylaw is hereby amended by rezoning the lands legally described as Plan 1948RS Blk 3 Lot 1; located at 100 - Windermere Crescent NW, Windermere, Edmonton, Alberta, which lands are shown on the sketch plan attached as Schedule "A", from Rural Residential Zone (RR) to Small Scale Flex Residential Zone (RSF) and River Valley Zone (A).

READ a first time this	29th day of August	, A. D. 2025;
READ a second time this	29th day of August	, A. D. 2025;
READ a third time this	29th day of August	, A. D. 2025;
SIGNED and PASSED this	29th day of August	, A. D. 2025.

THE CITY OF EDMONTON





MAYOR

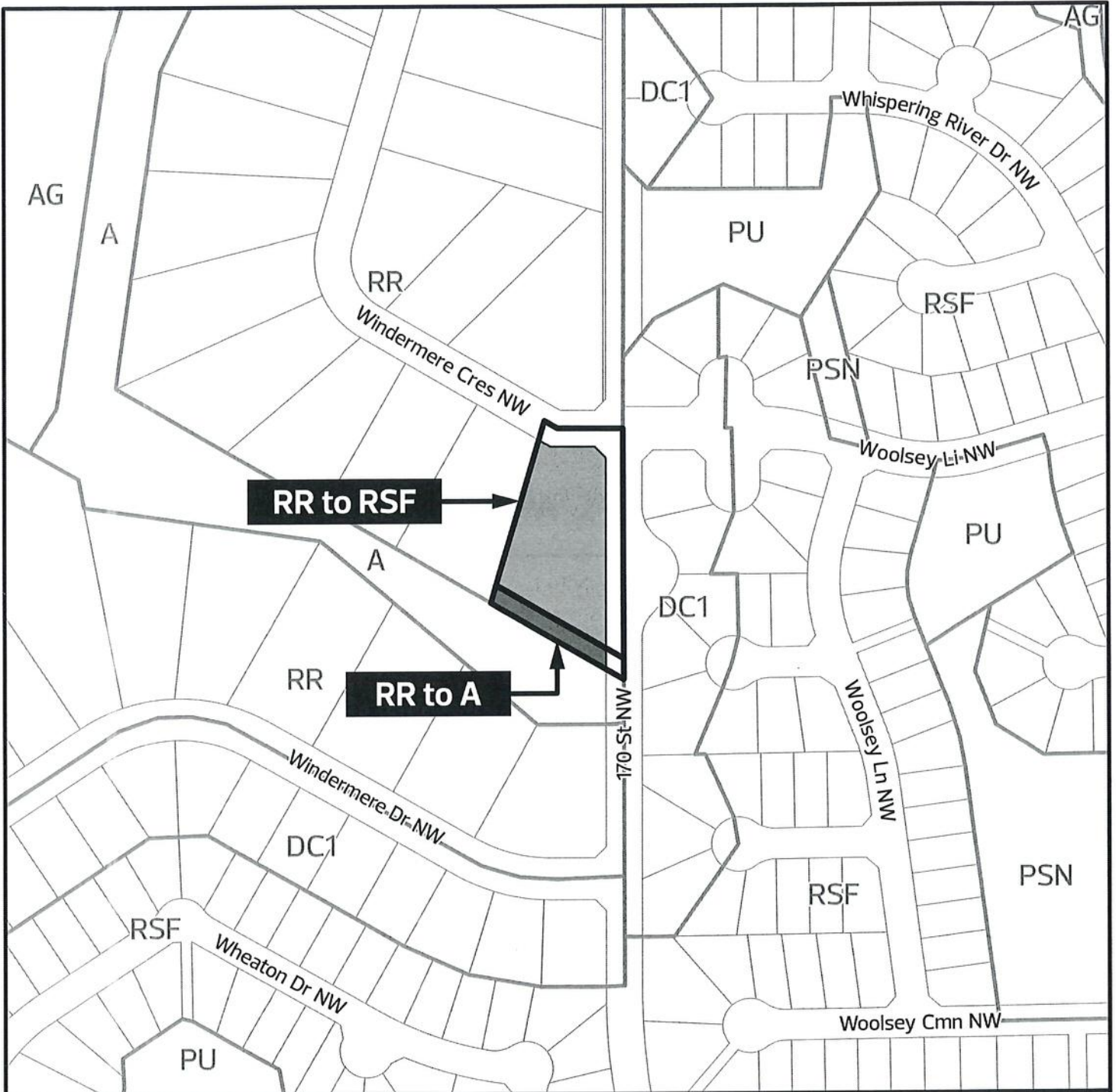

CITY CLERK

BYLAW 21213



-  RR to RSF
-  RR to A

