

**THE CITY OF EDMONTON**

**BYLAW 19183**

**CLOSURE OF A PORTION OF ROAD RIGHT-OF-WAY WEST OF 122 STREET NW  
BETWEEN 105 AVENUE NW AND STONY PLAIN ROAD NW, WESTMOUNT**

Whereas, pursuant to section 22 of the *Municipal Government Act*, R.S.A. 2000, c. M-26, a council of a municipality may by bylaw close a road within the municipality; and

Whereas, pursuant to sections 22 and 606 of the *Municipal Government Act*, a bylaw closing a road must be advertised; and

Whereas, pursuant to section 22 of the *Municipal Government Act*, before a bylaw closing a road is passed, a person who claims to be prejudicially affected by the bylaw, or that person's agent must be given an opportunity to be heard by the council; and

Edmonton City Council enacts:

**PART I - PURPOSE, DEFINITIONS AND INTERPRETATION**

- PURPOSE**                    1            The purpose of this bylaw is to close a portion of road as set out in Schedule “A” to this bylaw.
- DEFINITIONS**                2            In this bylaw, unless the context otherwise requires:
- (a)        “**City**” means the municipal corporation of the City of Edmonton;
  - (b)        “**Council**” means the Municipal Council of the City of Edmonton;
  - (c)        “**Registrar**” means the Registrar of Titles as defined by the *Land Titles Act*, R.S.A. 2000, c. L-4

**PART II - ROAD CLOSURE**

- 3 All of that portion of road shown on Schedule “A” and generally described in Attachment 1 attached to and forming part of this bylaw, is hereby closed.
- 4 When the Registrar issues a certificate or certificates of title with respect to the former portion of road closed by this bylaw:
  - (a) the title or titles so issued shall except thereout all mines and minerals and the City will continue to own the mines and minerals if it owned them prior to the creation of the title or titles; and
  - (b) Attachment 1 is deemed to include the full legal description of the lands comprising the portion of road closed by this bylaw.

READ a first time this	day of	, A.D. 2020;
READ a second time this	day of	, A.D. 2020;
READ a third time this	day of	, A.D. 2020;
SIGNED and PASSED this	day of	, A.D. 2020.

THE CITY OF EDMONTON

\_\_\_\_\_  
MAYOR

\_\_\_\_\_  
CITY CLERK

BYLAW 19183

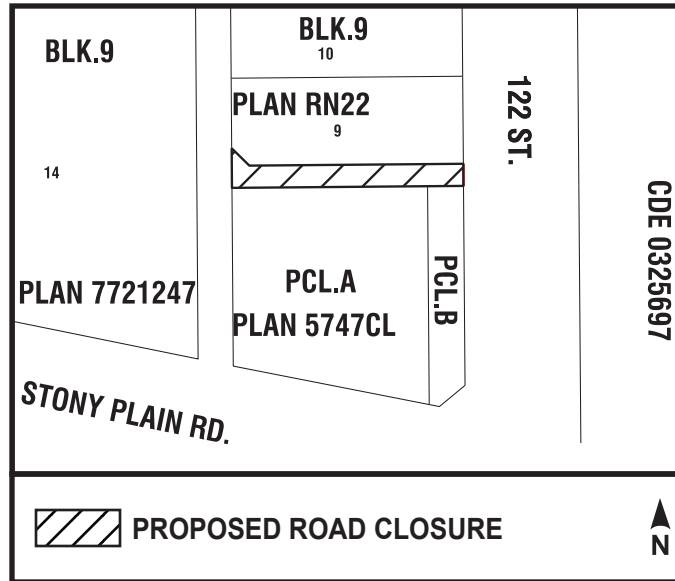

**ATTACHMENT 1**

PLAN RN22  
BLOCK 9  
ALL THAT PORTION OF LANE  
LYING WITHIN PLAN 202 \_\_\_\_\_  
**EXCEPTING THEREOUT ALL MINES AND MINERALS**

AND

PLAN 9021703  
ALL THAT PORTION OF CORNER CUT OFF  
LYING WITHIN PLAN 202 \_\_\_\_\_  
**EXCEPTING THEREOUT ALL MINES AND MINERALS**