

Charter Bylaw 19187

A Bylaw to amend Bylaw 12800, as amended,
The Edmonton Zoning Bylaw
Amendment No. 2969

WHEREAS a portion of Lots B and C, Plan 5687NY, located at 19807 and 20033 - 34 Street NW, Edmonton Energy and Technology Park, Edmonton, Alberta, are specified on the Zoning Map and Appendix 1 to Section 970 Special Area Edmonton Energy and Technology Park as (AG) Agricultural Zone; and

WHEREAS an application was made to rezone the above described properties to (EETIM) Edmonton Energy and Technology Medium Industrial Zone;

NOW THEREFORE after due compliance with the relevant provisions of the Municipal Government Act RSA 2000, ch. M-26, as amended, the Municipal Council of the City of Edmonton duly assembled enacts as follows:

1. The Zoning Map, being Part III to Bylaw 12800 The Edmonton Zoning Bylaw is hereby amended by rezoning the lands legally described as a portion of Lots B and C, Plan 5687NY, located at 19807 and 20033 - 34 Street NW, Edmonton Energy and Technology Park, Edmonton, Alberta, which lands are shown on the sketch plan attached as Schedule "A", (AG) Agricultural Zone and (EETIM) Edmonton Energy and Technology Medium Industrial Zone.

2. The Edmonton Zoning Bylaw is hereby further amended by deleting from it Appendix 1 to Section 970 Special Area Edmonton Energy and Technology Park and substituting therefore as Appendix 1 the map annexed hereto as Schedule "B".

READ a first time this	10th	day of	March	, A. D. 2020;
READ a second time this	10th	day of	March	, A. D. 2020;
READ a third time this	10th	day of	March	, A. D. 2020;
SIGNED and PASSED this	10th	day of	March	, A. D. 2020.

THE CITY OF EDMONTON



MAYOR

CITY CLERK

CHARTER BYLAW 19187

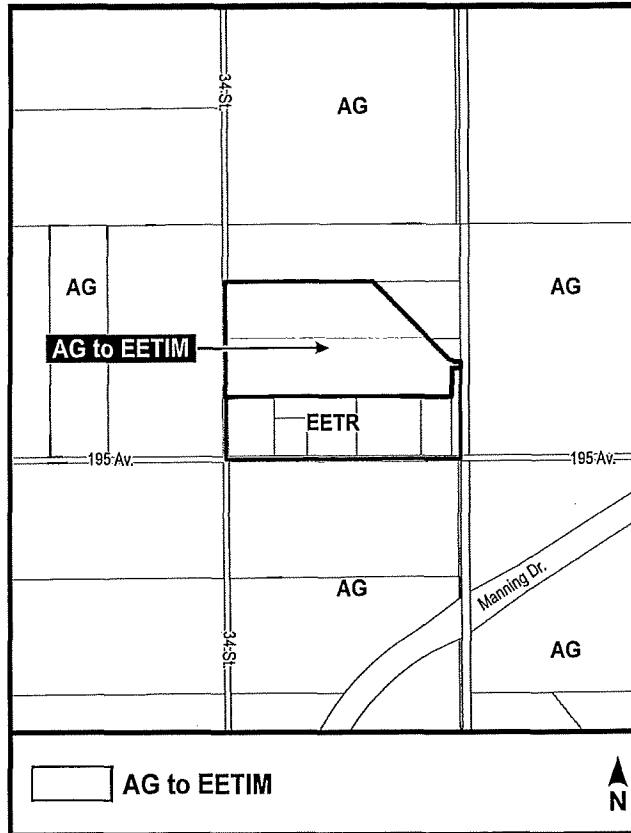

Special Area, Edmonton Energy and Technology Park

Appendix I to Section 970 of Bylaw 12800

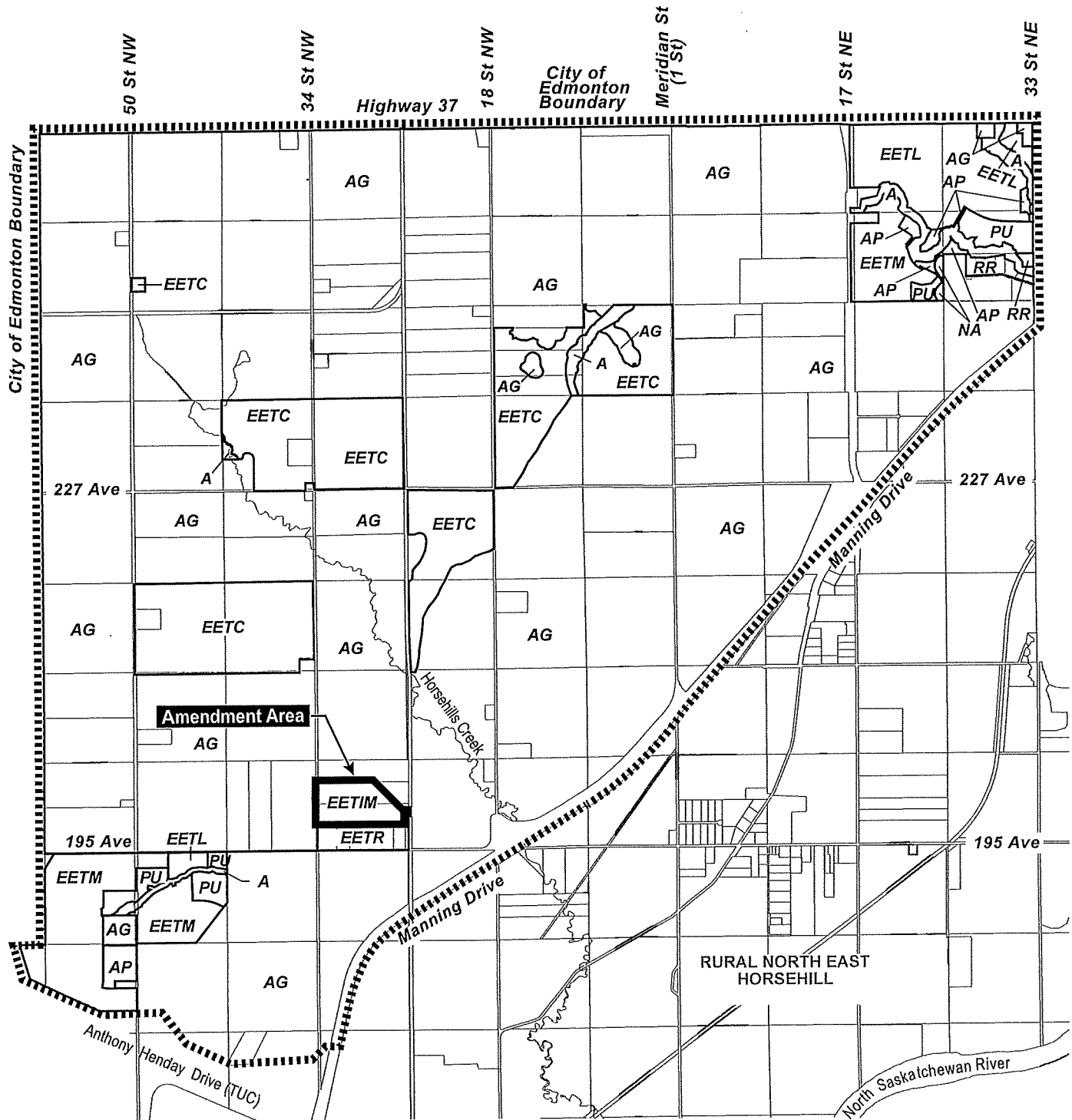

----- Special Zoning Area
 ———— Amendment Area

Notes:

- ★ Designation applied to site with altered or specific development regulations in accordance with Section 970 of Zoning Bylaw.
- ★ Indicates Service Commercial Node.