

THE CITY OF EDMONTON

BYLAW 19134

**CLOSURE OF A PORTION OF THE LANE EAST OF 101 STREET NW AND NORTH
OF 97 AVENUE NW, ROSSDALE**

Whereas, pursuant to section 22 of the *Municipal Government Act*, R.S.A. 2000, c. M-26, a council of a municipality may by bylaw close road within the municipality; and

Whereas, pursuant to sections 22 and 606 of the *Municipal Government Act*, a bylaw closing a road must be advertised; and

Whereas, pursuant to section 22 of the *Municipal Government Act*, before a bylaw closing a road is passed, a person who claims to be prejudicially affected by the bylaw, or that person's agent must be given an opportunity to be heard by the council; and

Edmonton City Council enacts:

PART I - PURPOSE, DEFINITIONS AND INTERPRETATION

- | | | |
|--------------------|-----|---|
| PURPOSE | 1 | The purpose of this bylaw is to close a portion of road as set out in Schedule “A” to this bylaw. |
| DEFINITIONS | 2 | In this bylaw, unless the context otherwise requires: |
| | (a) | “ City ” means the municipal corporation of the City of Edmonton; |
| | (b) | “ Council ” means the Municipal Council of the City of Edmonton; |
| | (c) | “ Registrar ” means the Registrar of Titles as defined by the <i>Land Titles Act</i> , R.S.A. 2000, c. L-4 |

PART II - ROAD CLOSURE

- 3 All of that portion of road shown on Schedule “A” and generally described in Attachment 1 attached to and forming part of this bylaw, is hereby closed.
- 4 When the Registrar issues a certificate or certificates of title with respect to the former portion of road closed by this bylaw:
- (a) the title or titles so issued shall except thereout all mines and minerals and the City will continue to own the mines and minerals if it owned them prior to the creation of the title or titles; and
 - (b) Attachment 1 is deemed to include the full legal description of the lands comprising the portion of road closed by this bylaw.

READ a first time this	day of	, A.D. 2020;
READ a second time this	day of	, A.D. 2020;
READ a third time this	day of	, A.D. 2020;
SIGNED and PASSED this	day of	, A.D. 2020.

THE CITY OF EDMONTON

MAYOR

CITY CLERK

BYLAW 19134

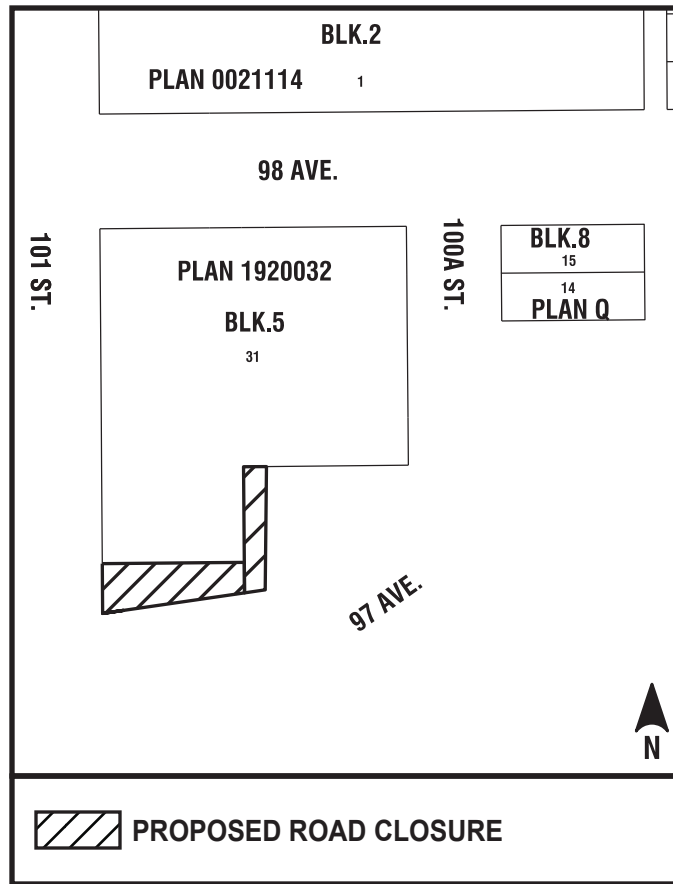

ATTACHMENT 1

Firstly

Plan Q

All that portion of lane shown contained within Area “A”

Plan 192 _____, as surveyed by Ben de Jong, ALS

Secondly

Plan 5796RS

All that portion of road shown contained within Area “B”

Plan 192 _____, as surveyed by Ben de Jong, ALS

Excepting thereout all mines and minerals