

## Map and Legal Description of Subject Properties

Property Number	Municipal Address(es)	Approval to Commence Expropriation Report Date, Number and Property Number
1(W47)	10004 - 156 Street NW	February 5, 2019 - Integrated Infrastructure Services CR_6631 Property 5A
2(W47A)	10008 - 156 Street NW	February 5, 2019 - Integrated Infrastructure Services CR_6631 Property 5B
3(W132)	13530 Stony Plain Road NW	April 16, 2019 - Integrated Infrastructure Services CR_6870 Property 9
4(W136)	10320 - 134 Street NW	April 16, 2019 - Integrated Infrastructure Services CR_6870 Property 11
5(W174)	10360 - 111 Street NW	March 12, 2019 - Integrated Infrastructure Services CR_6781 Property 4
6(W186)	10536 - 102 Avenue NW	March 12, 2019 - Integrated Infrastructure Services CR_6781 Property 6
7(W194)	14319 Stony Plain Road NW	April 16, 2019 - Integrated Infrastructure Services CR_6870 Property 6
8(W197)	10225 - 138 Street NW	July 3, 2019 - Integrated Infrastructure Services CR_7121 Property 1
9(W204)	13210 Stony Plain Road NW	April 16, 2019 - Integrated Infrastructure Services CR_6870 Property 13

**Attachment #1**

10(W251)	17104 - 86 Avenue NW	December 10, 2019 - Integrated Infrastructure Services CR_7391 Property 32
11(W285)	9935 - 156 Street NW	February 5, 2019 - Integrated Infrastructure Services CR_6631 Properties 4A and 4B
12(W291)	12225 Stony Plain Road NW	February 5, 2019 - Integrated Infrastructure Services CR_6631 Property 13
13(W292)	10350 - 122 Street NW	February 5, 2019 - Integrated Infrastructure Services CR_6631 Property 14
14(W191)	9509 -156 Street NW	October 23, 2018 - Integrated Infrastructure Services CR_6154 Property 5
15(W190&190A)	1 Meadowlark Park Shopping Centre NW	April 16, 2019 - Integrated Infrastructure Services CR_6870 Properties 1A and 1B

**Map and Legal Description, including Registered/Non-Registered Interests of Properties**

Approval is sought, pursuant to the *Expropriation Act*, to expropriate all of the lands, rights, titles and interests, expressed or implied, of the “owners” (as defined in the *Expropriation Act*);

- 1) existing now; and
- 2) as may become known to the expropriating authority,

as particularly described, in the Properties shown and legally described as:

**PROPERTY 1: FEE SIMPLE ESTATE, together with all registered and non-registered interests in the land, but excepting out the leasehold interest of each and every tenant in possession of or occupation of the land**

Municipal Address: **10004 - 156 Street NW, Edmonton, AB**

Legal Description: PLAN 2586AZ  
BLOCK ONE-C (1C)  
LOT ONE (1)

EXCEPTING THEREOUT:  
0.014 HECTARES (0.03 ACRES) MORE OR LESS, AS SHOWN ON ROAD PLAN 8221370  
EXCEPTING THEREOUT ALL MINES AND MINERALS

Registered Owner: TASTY MILL HOLDINGS LTD.

Certificate of Title No: 922 071 145 +1 (North Alberta Land Registration District)

Registered Interests: Nil

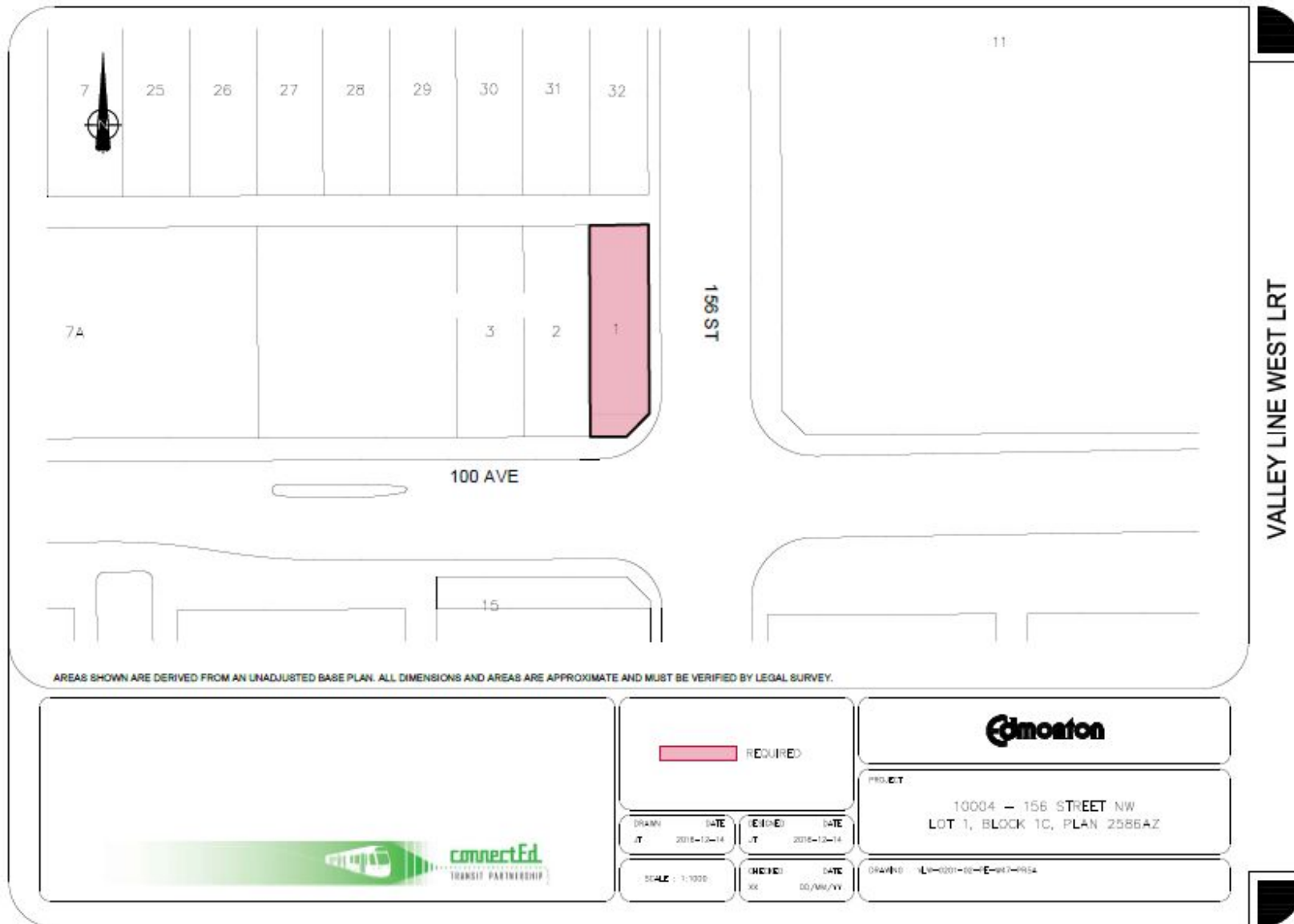

**PROPERTY 2:**        **FEE SIMPLE ESTATE, together with all registered and non-registered interests in the land, but excepting out the leasehold interest of each and every tenant in possession of or occupation of the land**

Municipal Address:    **10008 - 156 Street NW, Edmonton, AB**  
 Legal Description:    PLAN 2586AZ  
                               BLOCK 1C  
                               LOTS 2 AND 3  
                               EXCEPTING THEREOUT ALL MINES AND MINERALS  
 Registered Owner:    TASTY MILL HOLDINGS LTD.  
 Certificate of Title No: 922 071 145 (North Alberta Land Registration District)

**Registered Interests:**

<b>Registration No.</b>	<b>Name</b>	<b>Registration Type</b>
2437UE	TASTY MILL HOLDINGS LTD.	EASEMENT
832 273 589	298675 ALBERTA LTD.	CAVEAT RE: ASSIGNMENT OF LEASE
912 058 571	PROVINCE OF ALBERTA TREASURY BRANCHES	CAVEAT RE: ASSIGNMENT OF LEASE
912 060 970	WILD ROSE (ENTERPRISES) LIMITED.	CAVEAT RE: LEASE

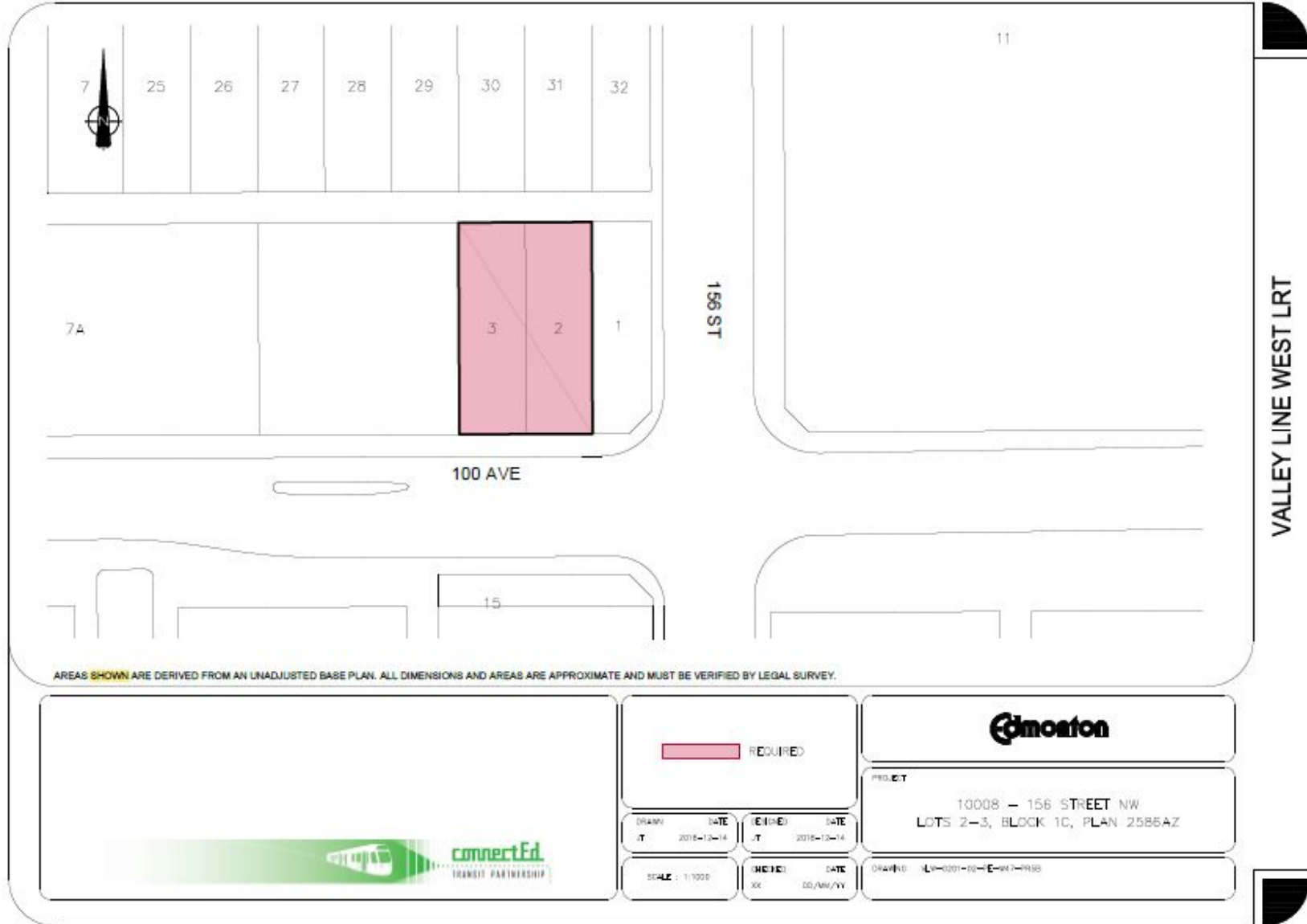

**PROPERTY 3:**

Municipal Address: **13530 Stony Plain Rd NW, Edmonton, AB**  
 Legal Description: PLAN 2177AH  
 BLOCK 93  
 LOTS C AND D  
 EXCEPTING THEREOUT ALL MINES AND MINERALS  
 Registered Owner: XXXXXX  
 Estate: Fee Simple  
 Certificate of Title No: 132 039 945 (North Alberta Land Registration District)  
 Land Area Required: Approximately 39.291m<sup>2</sup>, more or less

Known Improvements  
 within Area of Land

Required: Landscaping, concrete walkway

**Registered Interests:**

Registration No.	Name	Registration Type
122 154 911	ALBERTA TREASURY BRANCHES.	MORTGAGE

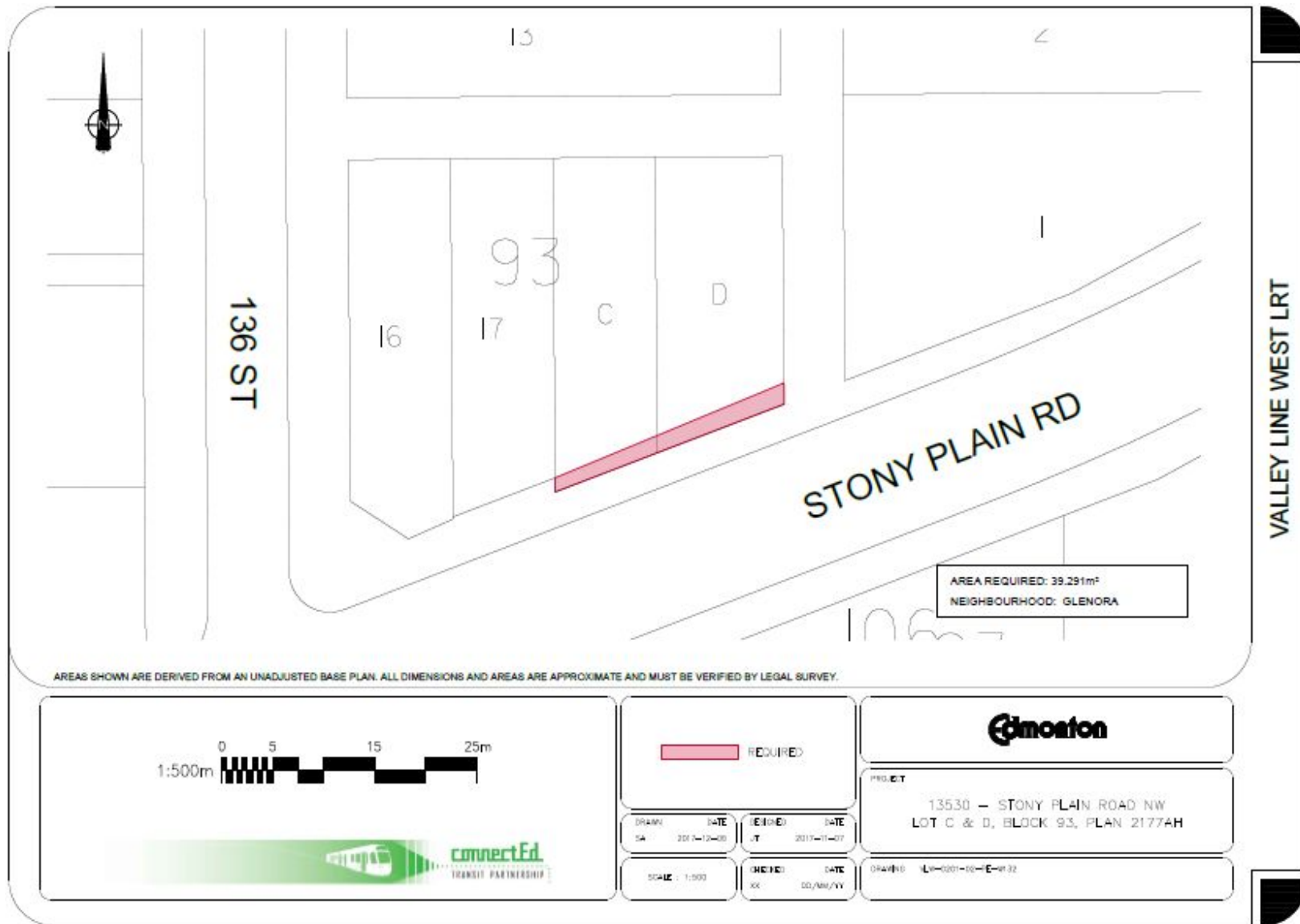



**PROPERTY 4:**

Municipal Address: **10320 - 134 Street NW, Edmonton, AB**  
 Legal Description: PLAN 2803AF  
 BLOCK 107  
 LOT 2  
 EXCEPTING THEREOUT ALL MINES AND MINERALS  
 Registered Owner: XXXXXX and XXXXXX  
 Estate: Fee Simple  
 Certificate of Title No: 192 247 268 (North Alberta Land Registration District)  
 Land Area Required: Approximately 49.637m<sup>2</sup>, more or less

Known Improvements  
 within Area of Land

Required: Landscaping, concrete walkway, fence

**Registered Interests:**

Registration No.	Name	Registration Type
4387AI	XXXXXX	CAVEAT
192 247 269	THE TORONTO DOMINION BANK.	MORTGAGE

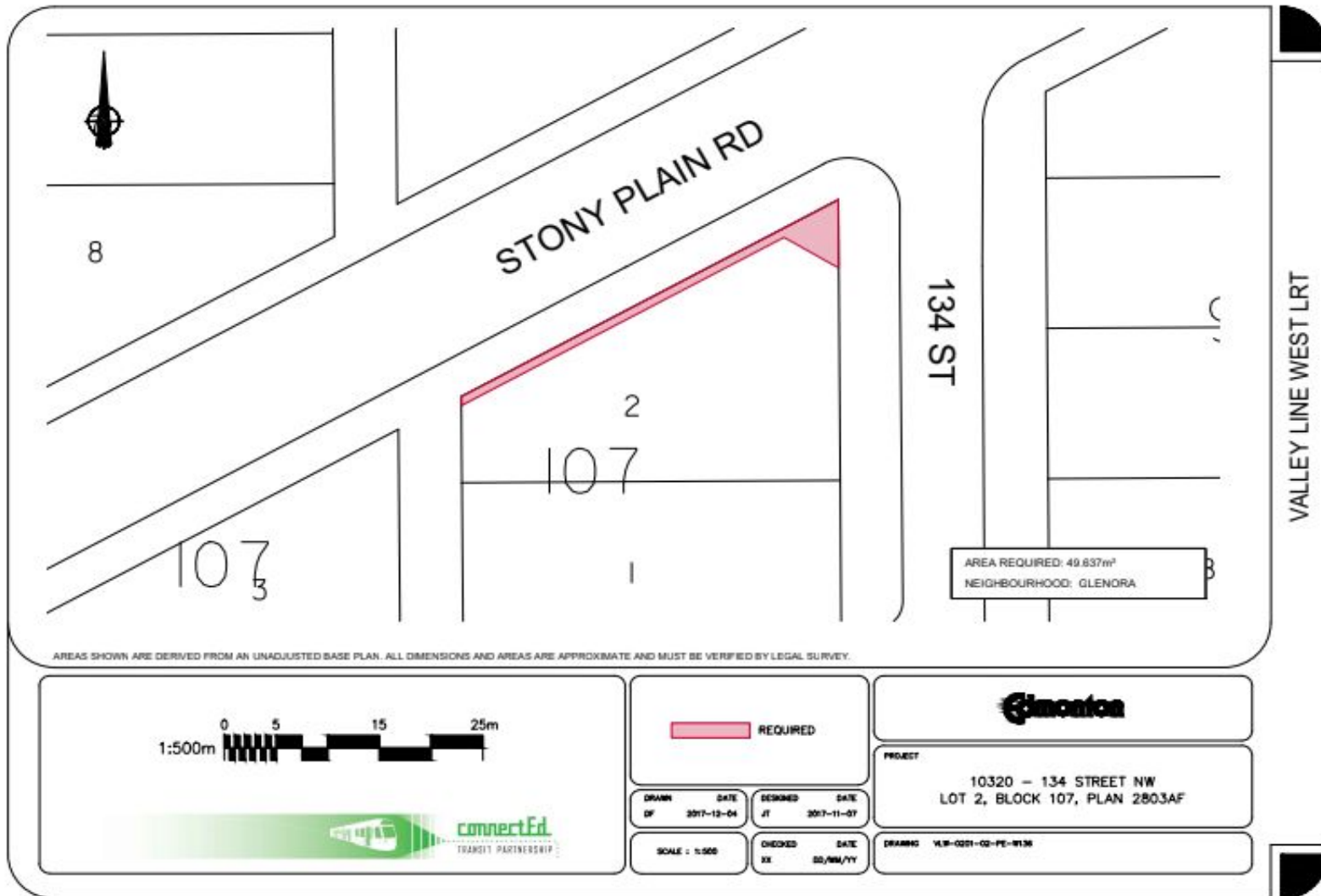

**PROPERTY 5:**

Municipal Address: **10360 - 111 Street NW, Edmonton, AB**  
Legal Description: PLAN 1282RS  
BLOCK 11  
LOT 125A  
EXCEPTING THEREOUT ALL MINES AND MINERALS  
Registered Owner: 1796668 Alberta Ltd.  
Estate: Fee Simple  
Certificate of Title No: 142 065 939 (North Alberta Land Registration District)  
Land Area Required: Approximately 0.0018 hectares, more or less

Known Improvements  
within Area of Land  
Required: Landscaping

**Registered Interests: Nil**

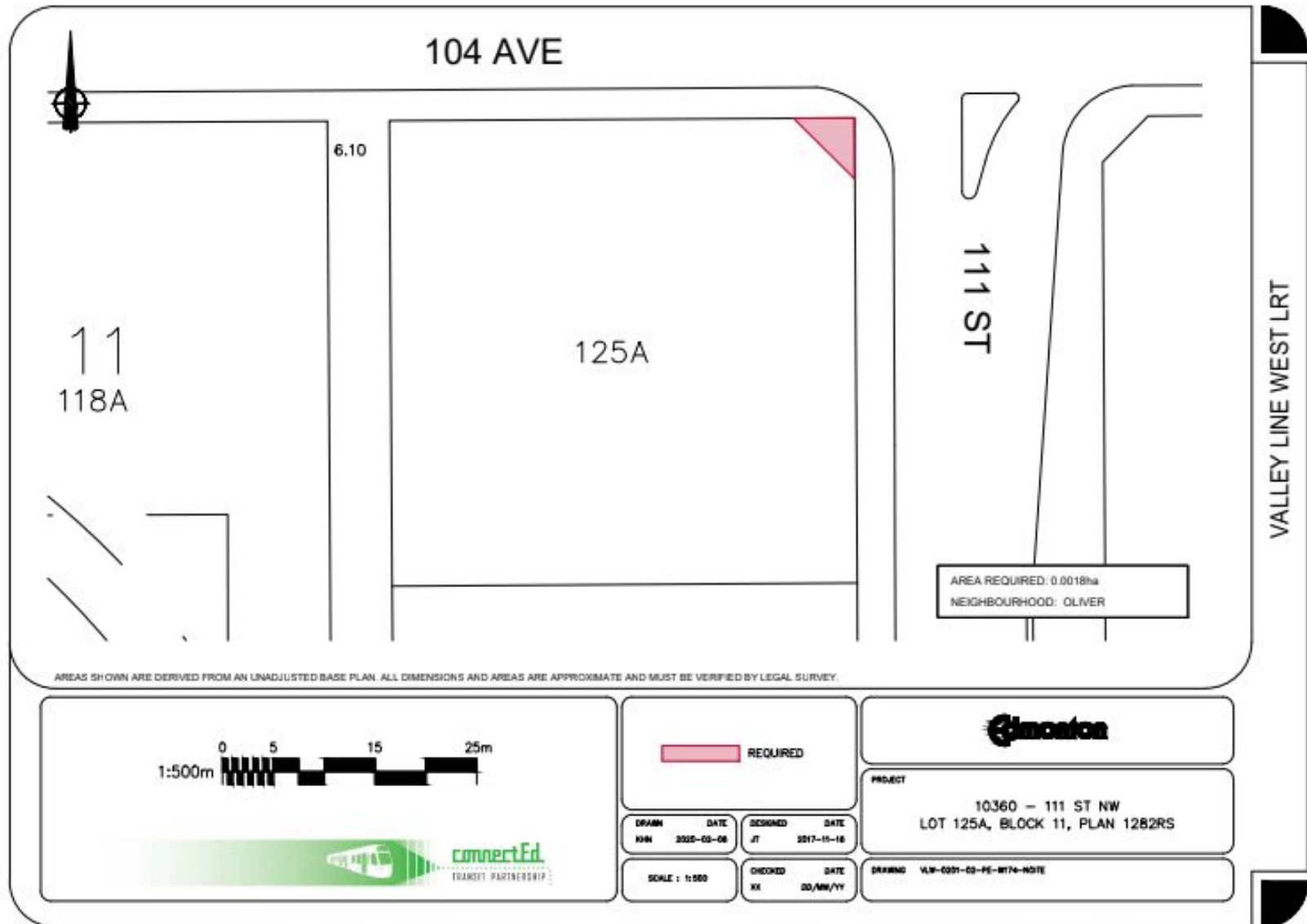

**PROPERTY 6:**Municipal Address: **10536 - 102 Avenue NW, Edmonton, AB**Legal Description: PLAN B2  
BLOCK 5  
LOT 143  
EXCEPTING THEREOUT ALL MINES AND MINERALSPLAN B2  
BLOCK 5  
LOT 144  
EXCEPTING THEREOUT ALL MINES AND MINERALS

Registered Owner: 1160821 Alberta Ltd.

Estate: Fee Simple

Certificate of Title No: 052 301 846 +2 and 052 301 846 (North Alberta Land Registration District)

Land Area Required: Approximately 103.521m<sup>2</sup>, more or lessKnown Improvements  
within Area of Land

Required: Landscaping, Paving, Concrete Walkway, Sign

**Registered Interests:**

Registration No.	Name	Registration Type
072 249 983	CANADIAN WESTERN BANK.	MORTGAGE
072 249 984	CANADIAN WESTERN BANK.	CAVEAT RE: ASSIGNMENT OF RENTS AND LEASES
172 087 337	CORTNI SCHMIDT PROFESSIONAL CORPORATION.	CAVEAT RE: LEASE INTEREST
172 108 940	CANADIAN WESTERN BANK.	AMENDING AGREEMENT

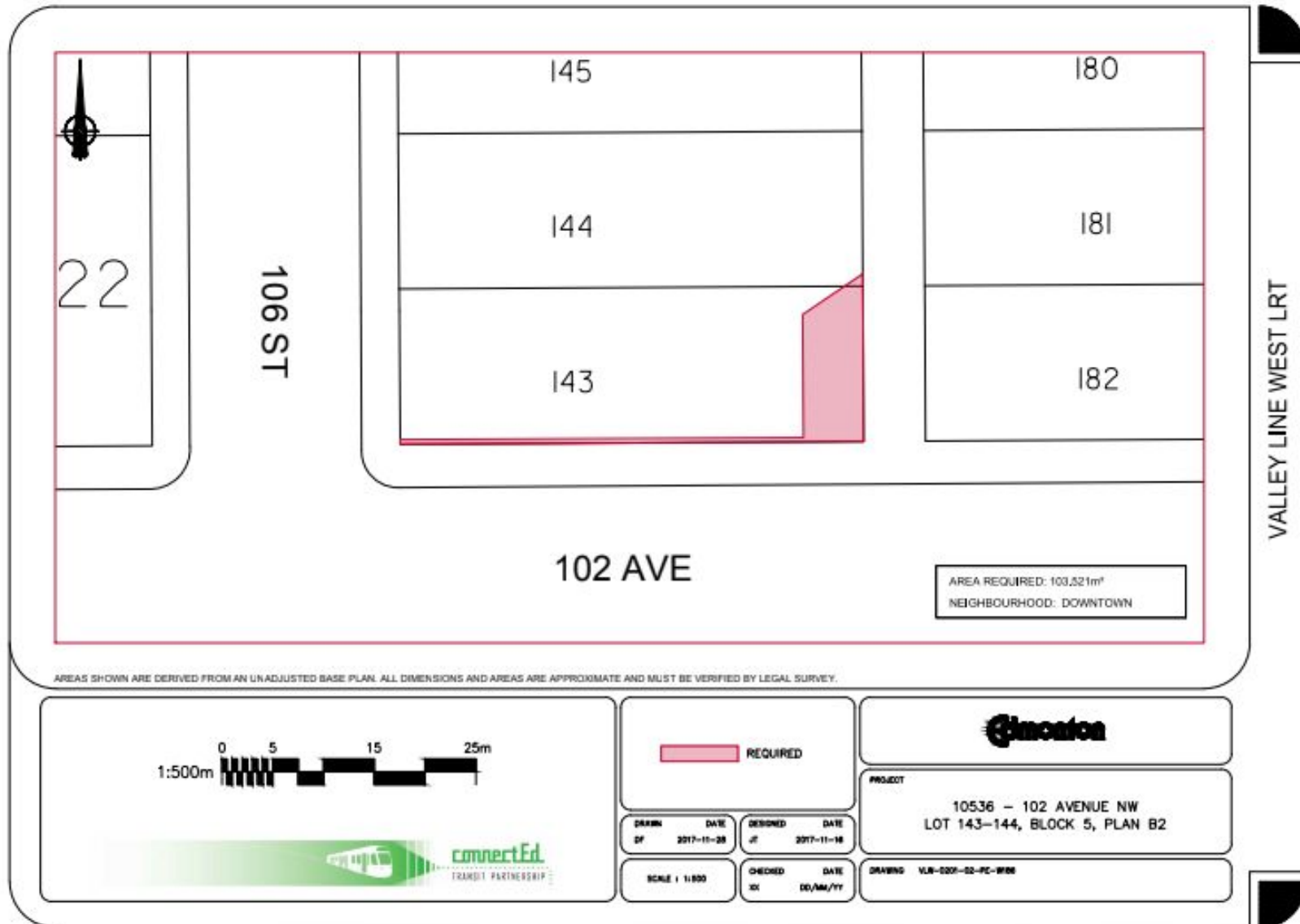

**PROPERTY 7:**

**Municipal Address:** 14319 Stony Plain Road NW, Edmonton, AB

**Legal Description:** CONDOMINIUM PLAN 0624188

UNIT 1

AND 1567 UNDIVIDED ONE TEN THOUSANDTH SHARES IN THE  
COMMON PROPERTY  
EXCEPTING THEREOUT ALL MINES AND MINERALS  
CONDOMINIUM PLAN 0624188

UNIT 2

AND 1316 UNDIVIDED ONE TEN THOUSANDTH SHARES IN THE  
COMMON PROPERTY  
EXCEPTING THEREOUT ALL MINES AND MINERALS  
CONDOMINIUM PLAN 0624188

UNIT 3

AND 1329 UNDIVIDED ONE TEN THOUSANDTH SHARES IN THE  
COMMON PROPERTY  
EXCEPTING THEREOUT ALL MINES AND MINERALS  
CONDOMINIUM PLAN 0624188

UNIT 4

AND 1502 UNDIVIDED ONE TEN THOUSANDTH SHARES IN THE  
COMMON PROPERTY  
EXCEPTING THEREOUT ALL MINES AND MINERALS  
CONDOMINIUM PLAN 0624188

UNIT 5

AND 1462 UNDIVIDED ONE TEN THOUSANDTH SHARES IN THE  
COMMON PROPERTY  
EXCEPTING THEREOUT ALL MINES AND MINERALS  
CONDOMINIUM PLAN 0624188

UNIT 6

AND 1316 UNDIVIDED ONE TEN THOUSANDTH SHARES IN THE  
COMMON PROPERTY

EXCEPTING THEREOUT ALL MINES AND MINERALS  
 CONDOMINIUM PLAN 0624188  
 UNIT 7  
 AND 1508 UNDIVIDED ONE TEN THOUSANDTH SHARES IN THE  
 COMMON PROPERTY  
 EXCEPTING THEREOUT ALL MINES AND MINERALS

Estate: Fee Simple  
 Certificates of Title: Unit 1: 192 305 124 (North Alberta Land Registration District)  
 Unit 2: 122 248 381 (North Alberta Land Registration District)  
 Unit 3: 132 145 229 (North Alberta Land Registration District)  
 Unit 4: 192 148 828 (North Alberta Land Registration District)  
 Unit 5: 092 350 606 (North Alberta Land Registration District)  
 Unit 6: 192 300 505 (North Alberta Land Registration District)  
 Unit 7: 092 192 092 (North Alberta Land Registration District)

Registered Owners: Unit 1: WM. S. CONNAUTON PROFESSIONAL CORPORATION.  
 Unit 2: XXXX  
 Unit 3: XXXX  
 Unit 4: XXXX and XXXX, as joint tenants  
 Unit 5: XXXX  
 Unit 6: ERIN BRISTOW PROFESSIONAL CORPORATION.  
 Unit 7: XXXX and XXXX, as joint tenants

Known Improvements  
 within Area of  
 Land Required: Landscaping, Underground sprinkler  
 Land Area Required: Approximately 0.0020 hectares, more or less

**Registered Interests for Unit 1:** Nil

**Registered Interests for Unit 2:**

Registration No.	Name	Registration Type
------------------	------	-------------------



122 248 382	ING Bank of Canada	Mortgage
-------------	--------------------	----------

**Registered Interests for Unit 3:**

Registration No.	Name	Registration Type
132 145 230	Royal Bank of Canada	Mortgage

**Registered Interests for Unit 4:**

Registration No.	Name	Registration Type
192 251 173	Royal Bank of Canada	Mortgage

**Registered Interests for Unit 5:**

Registration No.	Name	Registration Type
092 350 606	ATB Financial	Mortgage

**Registered Interests for Unit 6:**

Registration No.	Name	Registration Type
192 300 506	Canadian Imperial Bank of Commerce	Mortgage

**Registered Interests for Unit 7:**

Registration No.	Name	Registration Type
092 192 093	Royal Bank of Canada	Mortgage

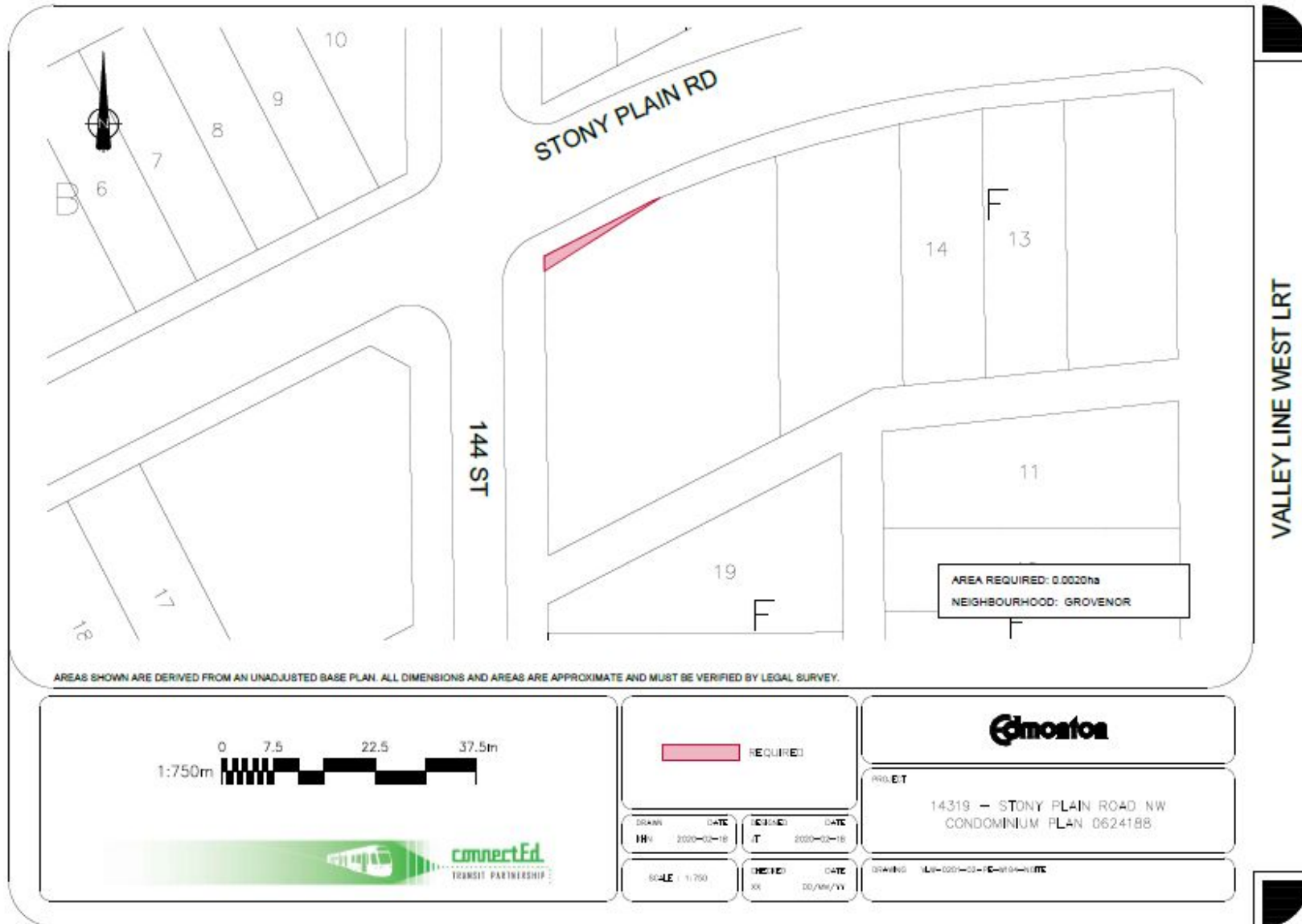

**PROPERTY 8:**

Municipal Address: **10225 - 138 Street NW, Edmonton, AB**  
 Legal Description: PLAN 2803AF  
 BLOCK 110  
 LOT 4  
 EXCEPTING THEREOUT ALL MINES AND MINERALS  
 Registered Owners: XXXX and XXXX  
 Estate: Fee Simple  
 Certificate of Title No: 152 393 186 (North Alberta Land Registration District)  
 Land Area Required: Approximately 5.199m<sup>2</sup>, more or less

Known Improvements  
 within Area of Land

Required: Landscaping, Wall

**Registered Interests:**

Registration No.	Name	Registration Type
4387AI	XXXX or successor	Caveat
152 393 187	The Toronto Dominion Bank	Mortgage

**Unregistered potential owners known at this time: Nil**

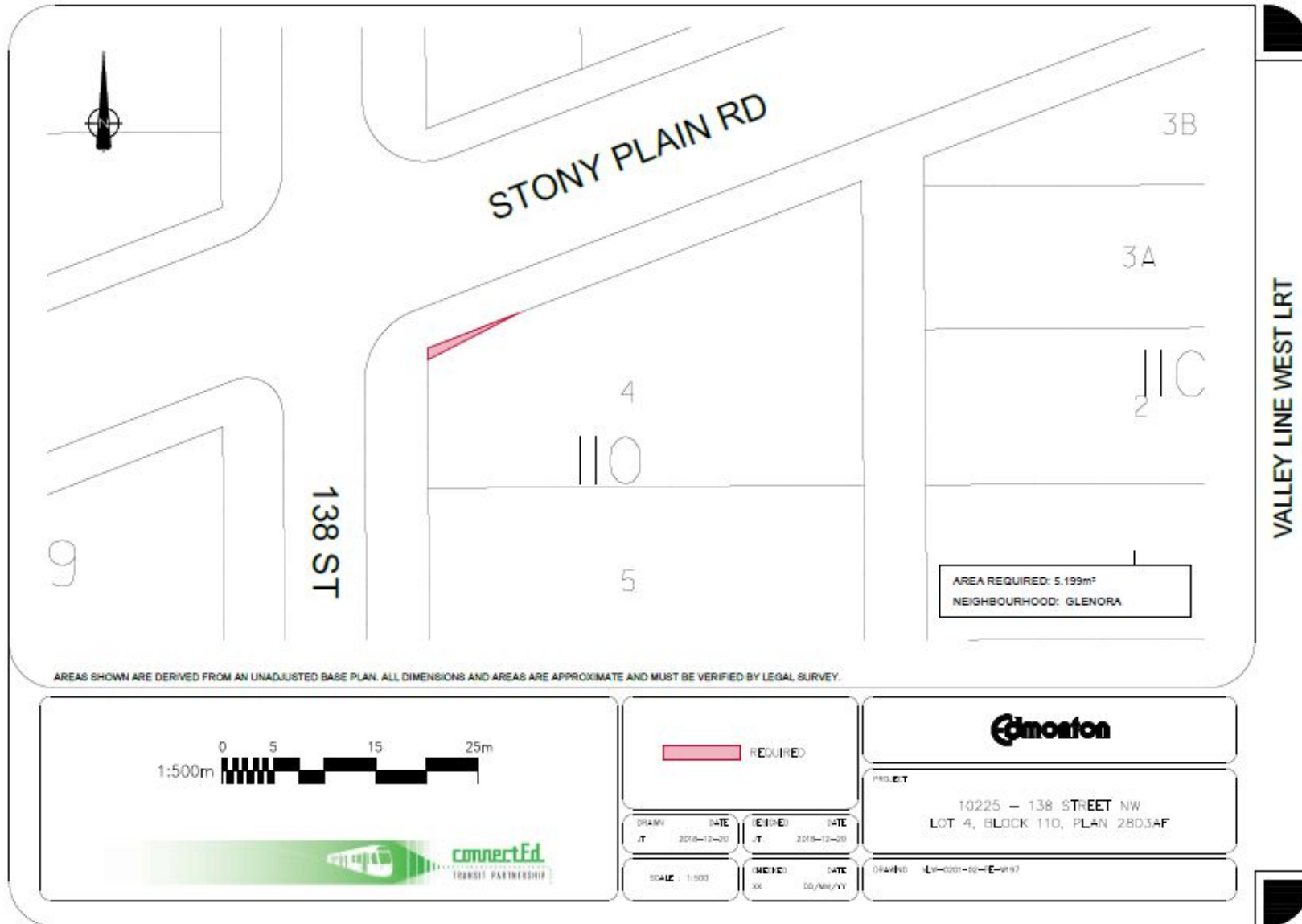

**PROPERTY 9:**

Municipal Address: **13210 Stony Plain Road NW, Edmonton, AB**  
 Legal Description: PLAN 3875P  
 BLOCK 79  
 LOT 1  
 EXCEPTING THEREOUT ALL MINES AND MINERALS  
 Registered Owner: XXXXXX  
 Estate: Fee Simple  
 Certificate of Title No: 152 311 490 (North Alberta Land Registration District)  
 Land Area Required: Approximately 45.854m<sup>2</sup>, more or less

Known Improvements  
 within Area of Land  
 Required: Landscaping, Sidewalk, Gate

**Registered Interests:**

Registration No.	Name	Registration Type
152 311 491	FIRST NATIONAL FINANCIAL GP CORPORATION.	MORTGAGE

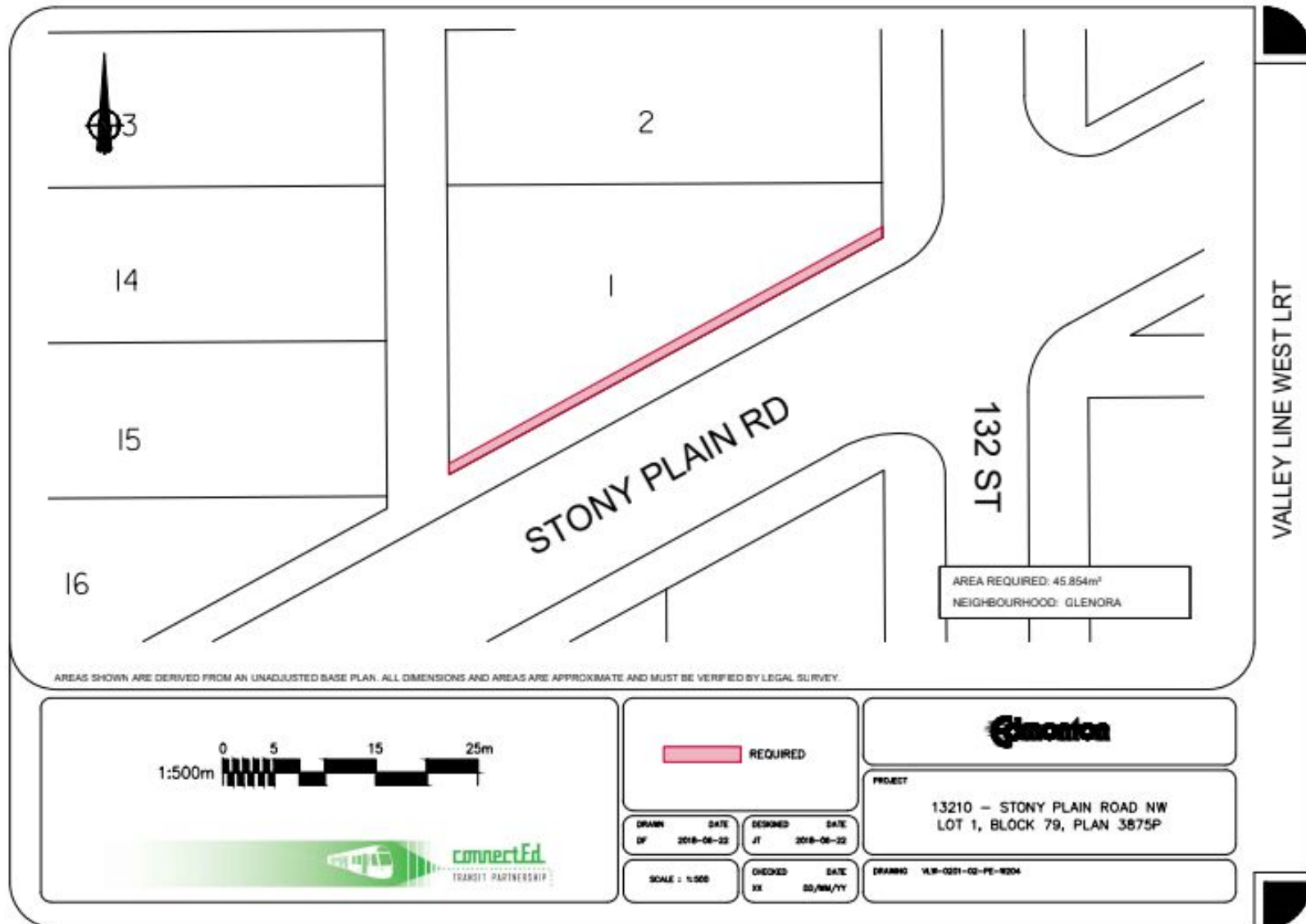

**PROPERTY 10:**

Municipal Address: **17104 - 86 Avenue NW, Edmonton, AB**

Legal Description: UNIT 1  
CONDOMINIUM PLAN CD5982  
AND 149 UNDIVIDED ONE TEN THOUSANDTH SHARES IN THE COMMON PROPERTY  
EXCEPTING THEREOUT ALL MINES AND MINERALS

UNIT 2  
CONDOMINIUM PLAN CD5982  
AND 149 UNDIVIDED ONE TEN THOUSANDTH SHARES IN THE COMMON PROPERTY  
EXCEPTING THEREOUT ALL MINES AND MINERALS

UNIT 3  
CONDOMINIUM PLAN CD5982  
AND 136 UNDIVIDED ONE TEN THOUSANDTH SHARES IN THE COMMON PROPERTY  
EXCEPTING THEREOUT ALL MINES AND MINERALS

UNIT 4  
CONDOMINIUM PLAN CD5982  
AND 136 UNDIVIDED ONE TEN THOUSANDTH SHARES IN THE COMMON PROPERTY  
EXCEPTING THEREOUT ALL MINES AND MINERAL

UNIT 5  
CONDOMINIUM PLAN CD5982  
AND 136 UNDIVIDED ONE TEN THOUSANDTH SHARES IN THE COMMON PROPERTY  
EXCEPTING THEREOUT ALL MINES AND MINERAL

UNIT 6  
CONDOMINIUM PLAN CD5982  
AND 136 UNDIVIDED ONE TEN THOUSANDTH SHARES IN THE COMMON PROPERTY  
EXCEPTING THEREOUT ALL MINES AND MINERAL

UNIT 7  
CONDOMINIUM PLAN CD5982  
AND 136 UNDIVIDED ONE TEN THOUSANDTH SHARES IN THE COMMON PROPERTY  
EXCEPTING THEREOUT ALL MINES AND MINERAL

UNIT 8  
CONDOMINIUM PLAN CD5982  
AND 136 UNDIVIDED ONE TEN THOUSANDTH SHARES IN THE COMMON PROPERTY  
EXCEPTING THEREOUT ALL MINES AND MINERAL

UNIT 9  
CONDOMINIUM PLAN CD5982  
AND 136 UNDIVIDED ONE TEN THOUSANDTH SHARES IN THE COMMON PROPERTY  
EXCEPTING THEREOUT ALL MINES AND MINERAL

UNIT10  
CONDOMINIUM PLAN CD5982  
AND 136 UNDIVIDED ONE TEN THOUSANDTH SHARES IN THE COMMON PROPERTY  
EXCEPTING THEREOUT ALL MINES AND MINERAL

UNIT11  
CONDOMINIUM PLAN CD5982  
AND 149 UNDIVIDED ONE TEN THOUSANDTH SHARES IN THE COMMON PROPERTY  
EXCEPTING THEREOUT ALL MINES AND MINERALS

UNIT12  
CONDOMINIUM PLAN CD5982  
AND 149 UNDIVIDED ONE TEN THOUSANDTH SHARES IN THE COMMON PROPERTY  
EXCEPTING THEREOUT ALL MINES AND MINERALS

UNIT13  
CONDOMINIUM PLAN CD5982  
AND 144 UNDIVIDED ONE TEN THOUSANDTH SHARES IN THE COMMON PROPERTY



EXCEPTING THEREOUT ALL MINES AND MINERALS  
UNIT14  
CONDOMINIUM PLAN CD5982  
AND 144 UNDIVIDED ONE TEN THOUSANDTH SHARES IN THE COMMON PROPERTY  
EXCEPTING THEREOUT ALL MINES AND MINERALS

UNIT15  
CONDOMINIUM PLAN CD5982  
AND 134 UNDIVIDED ONE TEN THOUSANDTH SHARES IN THE COMMON PROPERTY  
EXCEPTING THEREOUT ALL MINES AND MINERALS

UNIT16  
CONDOMINIUM PLAN CD5982  
AND 134 UNDIVIDED ONE TEN THOUSANDTH SHARES IN THE COMMON PROPERTY  
EXCEPTING THEREOUT ALL MINES AND MINERALS

UNIT17  
CONDOMINIUM PLAN CD5982  
AND 134 UNDIVIDED ONE TEN THOUSANDTH SHARES IN THE COMMON PROPERTY  
EXCEPTING THEREOUT ALL MINES AND MINERALS

UNIT18  
CONDOMINIUM PLAN CD5982  
AND 134 UNDIVIDED ONE TEN THOUSANDTH SHARES IN THE COMMON PROPERTY  
EXCEPTING THEREOUT ALL MINES AND MINERALS

UNIT19  
CONDOMINIUM PLAN CD5982  
AND 134 UNDIVIDED ONE TEN THOUSANDTH SHARES IN THE COMMON PROPERTY  
EXCEPTING THEREOUT ALL MINES AND MINERALS

UNIT 20  
CONDOMINIUM PLAN CD5982

AND 134 UNDIVIDED ONE TEN THOUSANDTH SHARES IN THE COMMON PROPERTY  
EXCEPTING THEREOUT ALL MINES AND MINERALS

UNIT 21  
CONDOMINIUM PLAN CD5982  
AND 134 UNDIVIDED ONE TEN THOUSANDTH SHARES IN THE COMMON PROPERTY  
EXCEPTING THEREOUT ALL MINES AND MINERALS

UNIT 22  
CONDOMINIUM PLAN CD5982  
AND 134 UNDIVIDED ONE TEN THOUSANDTH SHARES IN THE COMMON PROPERTY  
EXCEPTING THEREOUT ALL MINES AND MINERALS

UNIT 23  
CONDOMINIUM PLAN CD5982  
AND 144 UNDIVIDED ONE TEN THOUSANDTH SHARES IN THE COMMON PROPERTY  
EXCEPTING THEREOUT ALL MINES AND MINERALS

UNIT 24  
CONDOMINIUM PLAN CD5982  
AND 144 UNDIVIDED ONE TEN THOUSANDTH SHARES IN THE COMMON PROPERTY  
EXCEPTING THEREOUT ALL MINES AND MINERALS

UNIT 25  
CONDOMINIUM PLAN CD5982  
AND 149 UNDIVIDED ONE TEN THOUSANDTH SHARES IN THE COMMON PROPERTY  
EXCEPTING THEREOUT ALL MINES AND MINERALS

UNIT 26  
CONDOMINIUM PLAN CD5982  
AND 149 UNDIVIDED ONE TEN THOUSANDTH SHARES IN THE COMMON PROPERTY  
EXCEPTING THEREOUT ALL MINES AND MINERALS

UNIT 27  
CONDOMINIUM PLAN CD5982  
AND 136 UNDIVIDED ONE TEN THOUSANDTH SHARES IN THE COMMON PROPERTY  
EXCEPTING THEREOUT ALL MINES AND MINERALS

UNIT 28  
CONDOMINIUM PLAN CD5982  
AND 136 UNDIVIDED ONE TEN THOUSANDTH SHARES IN THE COMMON PROPERTY  
EXCEPTING THEREOUT ALL MINES AND MINERALS

UNIT 29  
CONDOMINIUM PLAN CD5982  
AND 136 UNDIVIDED ONE TEN THOUSANDTH SHARES IN THE COMMON PROPERTY  
EXCEPTING THEREOUT ALL MINES AND MINERALS

UNIT 30  
CONDOMINIUM PLAN CD5982  
AND 136 UNDIVIDED ONE TEN THOUSANDTH SHARES IN THE COMMON PROPERTY  
EXCEPTING THEREOUT ALL MINES AND MINERALS

UNIT 31  
CONDOMINIUM PLAN CD5982  
AND 136 UNDIVIDED ONE TEN THOUSANDTH SHARES IN THE COMMON PROPERTY  
EXCEPTING THEREOUT ALL MINES AND MINERALS

UNIT 32  
CONDOMINIUM PLAN CD5982  
AND 136 UNDIVIDED ONE TEN THOUSANDTH SHARES IN THE COMMON PROPERTY  
EXCEPTING THEREOUT ALL MINES AND MINERALS

UNIT 33  
CONDOMINIUM PLAN CD5982  
AND 136 UNDIVIDED ONE TEN THOUSANDTH SHARES IN THE COMMON PROPERTY

EXCEPTING THEREOUT ALL MINES AND MINERALS

UNIT 34

CONDOMINIUM PLAN CD5982

AND 136 UNDIVIDED ONE TEN THOUSANDTH SHARES IN THE COMMON PROPERTY  
EXCEPTING THEREOUT ALL MINES AND MINERALS

UNIT 35

CONDOMINIUM PLAN CD5982

AND 149 UNDIVIDED ONE TEN THOUSANDTH SHARES IN THE COMMON PROPERTY  
EXCEPTING THEREOUT ALL MINES AND MINERALS

UNIT 36

CONDOMINIUM PLAN CD5982

AND 149 UNDIVIDED ONE TEN THOUSANDTH SHARES IN THE COMMON PROPERTY  
EXCEPTING THEREOUT ALL MINES AND MINERALS

UNIT 37

CONDOMINIUM PLAN CD5982

AND 144 UNDIVIDED ONE TEN THOUSANDTH SHARES IN THE COMMON PROPERTY  
EXCEPTING THEREOUT ALL MINES AND MINERALS

UNIT 38

CONDOMINIUM PLAN CD5982

AND 144 UNDIVIDED ONE TEN THOUSANDTH SHARES IN THE COMMON PROPERTY  
EXCEPTING THEREOUT ALL MINES AND MINERALS

UNIT 39

CONDOMINIUM PLAN CD5982

AND 134 UNDIVIDED ONE TEN THOUSANDTH SHARES IN THE COMMON PROPERTY  
EXCEPTING THEREOUT ALL MINES AND MINERALS

UNIT40

CONDOMINIUM PLAN CD5982  
AND 134 UNDIVIDED ONE TEN THOUSANDTH SHARES IN THE COMMON PROPERTY  
EXCEPTING THEREOUT ALL MINES AND MINERALS

UNIT 41  
CONDOMINIUM PLAN CD5982  
AND 134 UNDIVIDED ONE TEN THOUSANDTH SHARES IN THE COMMON PROPERTY  
EXCEPTING THEREOUT ALL MINES AND MINERALS

UNIT 42  
CONDOMINIUM PLAN CD5982  
AND 134 UNDIVIDED ONE TEN THOUSANDTH SHARES IN THE COMMON PROPERTY  
EXCEPTING THEREOUT ALL MINES AND MINERALS

UNIT 43  
CONDOMINIUM PLAN CD5982  
AND 134 UNDIVIDED ONE TEN THOUSANDTH SHARES IN THE COMMON PROPERTY  
EXCEPTING THEREOUT ALL MINES AND MINERALS

UNIT 44  
CONDOMINIUM PLAN CD5982  
AND 134 UNDIVIDED ONE TEN THOUSANDTH SHARES IN THE COMMON PROPERTY  
EXCEPTING THEREOUT ALL MINES AND MINERALS

UNIT 45  
CONDOMINIUM PLAN CD5982  
AND 134 UNDIVIDED ONE TEN THOUSANDTH SHARES IN THE COMMON PROPERTY  
EXCEPTING THEREOUT ALL MINES AND MINERALS

UNIT 46  
CONDOMINIUM PLAN CD5982  
AND 134 UNDIVIDED ONE TEN THOUSANDTH SHARES IN THE COMMON PROPERTY  
EXCEPTING THEREOUT ALL MINES AND MINERALS

UNIT 47  
CONDOMINIUM PLAN CD5982  
AND 144 UNDIVIDED ONE TEN THOUSANDTH SHARES IN THE COMMON PROPERTY  
EXCEPTING THEREOUT ALL MINES AND MINERALS

UNIT 48  
CONDOMINIUM PLAN CD5982  
AND 144 UNDIVIDED ONE TEN THOUSANDTH SHARES IN THE COMMON PROPERTY  
EXCEPTING THEREOUT ALL MINES AND MINERALS

UNIT 49  
CONDOMINIUM PLAN CD5982  
AND 149 UNDIVIDED ONE TEN THOUSANDTH SHARES IN THE COMMON PROPERTY  
EXCEPTING THEREOUT ALL MINES AND MINERALS

UNIT 50  
CONDOMINIUM PLAN CD5982  
AND 149 UNDIVIDED ONE TEN THOUSANDTH SHARES IN THE COMMON PROPERTY  
EXCEPTING THEREOUT ALL MINES AND MINERALS

UNIT 51  
CONDOMINIUM PLAN CD5982  
AND 136 UNDIVIDED ONE TEN THOUSANDTH SHARES IN THE COMMON PROPERTY  
EXCEPTING THEREOUT ALL MINES AND MINERALS

UNIT52  
CONDOMINIUM PLAN CD5982  
AND 136 UNDIVIDED ONE TEN THOUSANDTH SHARES IN THE COMMON PROPERTY  
EXCEPTING THEREOUT ALL MINES AND MINERALS

UNIT 53  
CONDOMINIUM PLAN CD5982  
AND 136 UNDIVIDED ONE TEN THOUSANDTH SHARES IN THE COMMON PROPERTY

EXCEPTING THEREOUT ALL MINES AND MINERALS

UNIT 54  
CONDOMINIUM PLAN CD5982  
AND 136 UNDIVIDED ONE TEN THOUSANDTH SHARES IN THE COMMON PROPERTY  
EXCEPTING THEREOUT ALL MINES AND MINERALS

UNIT55  
CONDOMINIUM PLAN CD5982  
AND 136 UNDIVIDED ONE TEN THOUSANDTH SHARES IN THE COMMON PROPERTY  
EXCEPTING THEREOUT ALL MINES AND MINERALS

UNIT 56  
CONDOMINIUM PLAN CD5982  
AND 136 UNDIVIDED ONE TEN THOUSANDTH SHARES IN THE COMMON PROPERTY  
EXCEPTING THEREOUT ALL MINES AND MINERALS

UNIT 57  
CONDOMINIUM PLAN CD5982  
AND 136 UNDIVIDED ONE TEN THOUSANDTH SHARES IN THE COMMON PROPERTY  
EXCEPTING THEREOUT ALL MINES AND MINERALS

UNIT 58  
CONDOMINIUM PLAN CD5982  
AND 136 UNDIVIDED ONE TEN THOUSANDTH SHARES IN THE COMMON PROPERTY  
EXCEPTING THEREOUT ALL MINES AND MINERALS

UNIT 59  
CONDOMINIUM PLAN CD5982  
AND 149 UNDIVIDED ONE TEN THOUSANDTH SHARES IN THE COMMON PROPERTY  
EXCEPTING THEREOUT ALL MINES AND MINERALS

UNIT 60

CONDOMINIUM PLAN CD5982  
AND 149 UNDIVIDED ONE TEN THOUSANDTH SHARES IN THE COMMON PROPERTY  
EXCEPTING THEREOUT ALL MINES AND MINERALS

UNIT 61  
CONDOMINIUM PLAN CD5982  
AND 145 UNDIVIDED ONE TEN THOUSANDTH SHARES IN THE COMMON PROPERTY  
EXCEPTING THEREOUT ALL MINES AND MINERALS

UNIT 62  
CONDOMINIUM PLAN CD5982  
AND 145 UNDIVIDED ONE TEN THOUSANDTH SHARES IN THE COMMON PROPERTY  
EXCEPTING THEREOUT ALL MINES AND MINERALS

UNIT 63  
CONDOMINIUM PLAN CD5982  
AND 134 UNDIVIDED ONE TEN THOUSANDTH SHARES IN THE COMMON PROPERTY  
EXCEPTING THEREOUT ALL MINES AND MINERALS

UNIT 64  
CONDOMINIUM PLAN CD5982  
AND 134 UNDIVIDED ONE TEN THOUSANDTH SHARES IN THE COMMON PROPERTY  
EXCEPTING THEREOUT ALL MINES AND MINERALS

UNIT 65  
CONDOMINIUM PLAN CD5982  
AND 134 UNDIVIDED ONE TEN THOUSANDTH SHARES IN THE COMMON PROPERTY  
EXCEPTING THEREOUT ALL MINES AND MINERALS

UNIT 66  
CONDOMINIUM PLAN CD5982  
AND 134 UNDIVIDED ONE TEN THOUSANDTH SHARES IN THE COMMON PROPERTY  
EXCEPTING THEREOUT ALL MINES AND MINERALS



UNIT 67  
CONDOMINIUM PLAN CD5982  
AND 134 UNDIVIDED ONE TEN THOUSANDTH SHARES IN THE COMMON PROPERTY  
EXCEPTING THEREOUT ALL MINES AND MINERALS

UNIT 68  
CONDOMINIUM PLAN CD5982  
AND 134 UNDIVIDED ONE TEN THOUSANDTH SHARES IN THE COMMON PROPERTY  
EXCEPTING THEREOUT ALL MINES AND MINERALS

UNIT 69  
CONDOMINIUM PLAN CD5982  
AND 134 UNDIVIDED ONE TEN THOUSANDTH SHARES IN THE COMMON PROPERTY  
EXCEPTING THEREOUT ALL MINES AND MINERALS

UNIT 70  
CONDOMINIUM PLAN CD5982  
AND 134 UNDIVIDED ONE TEN THOUSANDTH SHARES IN THE COMMON PROPERTY  
EXCEPTING THEREOUT ALL MINES AND MINERALS

UNIT 71  
CONDOMINIUM PLAN CD5982  
AND 145 UNDIVIDED ONE TEN THOUSANDTH SHARES IN THE COMMON PROPERTY  
EXCEPTING THEREOUT ALL MINES AND MINERALS

UNIT 72  
CONDOMINIUM PLAN CD5982  
AND 145 UNDIVIDED ONE TEN THOUSANDTH SHARES IN THE COMMON PROPERTY  
EXCEPTING THEREOUT ALL MINES AND MINERALS

Certificate of Title No: Unit 1: 012 411 256 (North Alberta Land Registration District)  
Unit 2: 082 205 312 +1 (North Alberta Land Registration District)  
Unit 3: 082 205 312 +1 (North Alberta Land Registration District)

Unit 4: 122 047 654 (North Alberta Land Registration District)  
Unit 5: 042 563 500 (North Alberta Land Registration District)  
Unit 6: 152 301 240 (North Alberta Land Registration District)  
Unit 7: 132 075 558 (North Alberta Land Registration District)  
Unit 8: 172 206 999 (North Alberta Land Registration District)  
Unit 9: 112 294 566 (North Alberta Land Registration District)  
Unit 10: 002 013 737 (North Alberta Land Registration District)  
Unit 11: 162 042 174 (North Alberta Land Registration District)  
Unit 12: 902 364 790 (North Alberta Land Registration District)  
Unit 13: 832 248 811 (North Alberta Land Registration District)  
Unit 14: 012 155 866 (North Alberta Land Registration District)  
Unit 15: 002 357 793 (North Alberta Land Registration District)  
Unit 16: 072 340 149 (North Alberta Land Registration District)  
Unit 17: 192 299 989 (North Alberta Land Registration District)  
Unit 18: 182 141 881 (North Alberta Land Registration District)  
Unit 19: 172 210 832 (North Alberta Land Registration District)  
Unit 20: 072 661 695 (North Alberta Land Registration District)  
Unit 21: 182 165 524 (North Alberta Land Registration District)  
Unit 22: 042 478 387 (North Alberta Land Registration District)  
Unit 23: 122 334 842 (North Alberta Land Registration District)  
Unit 24: 172 079 792 (North Alberta Land Registration District)  
Unit 25: 012 275 539 (North Alberta Land Registration District)  
Unit 26: 162 157 515 (North Alberta Land Registration District)  
Unit 27: 182 187 644 (North Alberta Land Registration District)  
Unit 28: 182 212 491 (North Alberta Land Registration District)  
Unit 29: 182 152 327 (North Alberta Land Registration District)  
Unit 30: 072 632 743 (North Alberta Land Registration District)  
Unit 31: 082 402 924 (North Alberta Land Registration District)  
Unit 32: 032 102 451 (North Alberta Land Registration District)  
Unit 33: 192 248 267 (North Alberta Land Registration District)  
Unit 34: 022 202 735 (North Alberta Land Registration District)  
Unit 35: 992 388 324 (North Alberta Land Registration District)  
Unit 36: 082 381 523 (North Alberta Land Registration District)

- Unit 37: 182 266 025 (North Alberta Land Registration District)
- Unit 38: 042 369 252 (North Alberta Land Registration District)
- Unit 39: 002 017 170 (North Alberta Land Registration District)
- Unit 40: 062 148 591 (North Alberta Land Registration District)
- Unit 41: 132 006 505 (North Alberta Land Registration District)
- Unit 42: 082 192 582 (North Alberta Land Registration District)
- Unit 43: 172 229 598 (North Alberta Land Registration District)
- Unit 44: 042 220 266 (North Alberta Land Registration District)
- Unit 45: 122 339 758 (North Alberta Land Registration District)
- Unit 46: 152 305 512 (North Alberta Land Registration District)
- Unit 47: 012 037 047 (North Alberta Land Registration District)
- Unit 48: 992 388 321 (North Alberta Land Registration District)
- Unit 49: 122 211 010 (North Alberta Land Registration District)
- Unit 50: CDE10196 (North Alberta Land Registration District)
- Unit 51: 012 096 107 (North Alberta Land Registration District)
- Unit 52: 172 306 941 (North Alberta Land Registration District)
- Unit 53: 102 173 673 (North Alberta Land Registration District)
- Unit 54: 172 179 482 (North Alberta Land Registration District)
- Unit 55: 132 292 600 (North Alberta Land Registration District)
- Unit 56: 992 162 105 (North Alberta Land Registration District)
- Unit 57: 052 566 779 (North Alberta Land Registration District)
- Unit 58: 132 156 106 (North Alberta Land Registration District)
- Unit 59: 892 061 875 (North Alberta Land Registration District)
- Unit 60: 152 065 387 (North Alberta Land Registration District)
- Unit 61: 152 176 210 (North Alberta Land Registration District)
- Unit 62: 172 164 947 (North Alberta Land Registration District)
- Unit 63: 002 253 984 (North Alberta Land Registration District)
- Unit 64: 082 229 387 (North Alberta Land Registration District)
- Unit 65: 022 031 362 (North Alberta Land Registration District)
- Unit 66: 172 179 495 (North Alberta Land Registration District)
- Unit 67: 182 035 011 (North Alberta Land Registration District)
- Unit 68: 132 295 630 (North Alberta Land Registration District)
- Unit 69: 162 315 837 (North Alberta Land Registration District)

Unit 70: 082 113 836 (North Alberta Land Registration District)  
Unit 71: 172 198 203 (North Alberta Land Registration District)  
Unit 72: 182 306 572 (North Alberta Land Registration District)

Estate: Units 1 to 72: Fee Simple  
Registered Owners: Unit 1: XXXX XXXX and XXXX XXXX, as joint tenants  
Unit 2: XXXX XXXX  
Unit 3: XXXX XXXX and XXXX XXXX, as joint tenants  
Unit 4: XXXX XXXX  
Unit 5: XXXX XXXX  
Unit 6: XXXX XXXX and XXXX XXXX, as joint tenants  
Unit 7: XXXX XXXX  
Unit 8: DAN DEVELOPMENTS LTD.  
Unit 9: XXXX XXXX and XXXX XXXX, as joint tenants  
Unit 10: 809146 ALBERTA LTD.  
Unit 11: XXXX XXXX and XXXX XXXX, as joint tenants  
Unit 12: XXXX XXXX  
Unit 13: XXXX XXXX  
Unit 14: XXXX XXXX and XXXX XXXX, as joint tenants  
Unit 15: XXXX XXXX and XXXX XXXX, as joint tenants  
Unit 16: XXXX XXXX  
Unit 17: DAN DEVELOPMENTS LTD.  
Unit 18: XXXX XXXX  
Unit 19: DAN DEVELOPMENTS LTD.  
Unit 20: XXXX XXXX  
Unit 21: XXXX XXXX  
Unit 22: XXXX XXXX  
Unit 23: XXXX XXXX  
Unit 24: XXXX XXXX and XXXX XXXX, as joint tenants  
Unit 25: BORAV DEVELOPMENT LTD.  
Unit 26: XXXX XXXX  
Unit 27: A. OSKIN PROFESSIONAL CORPORATION.  
Unit 28: A. OSKIN PROFESSIONAL CORPORATION.

Unit 29: XXXX XXXX and XXXX XXXX, as joint tenants  
Unit 30: XXXX XXXX and XXXX XXXX, as joint tenants  
Unit 31: XXXX XXXX  
Unit 32: XXXX XXXX  
Unit 33: DAN DEVELOPMENTS LTD.  
Unit 34: BORAV DEVELOPMENT LTD.  
Unit 35: 809146 ALBERTA LTD.  
Unit 36: XXXX XXXX  
Unit 37: A. OSKIN PROFESSIONAL CORPORATION.  
Unit 38: XXXX XXXX  
Unit 39: BORAV DEVELOPMENT LTD.  
Unit 40: BORAV DEVELOPMENT LTD.  
Unit 41: XXXX XXXX and XXXX XXXX, as joint tenants  
Unit 42: XXXX XXXX and XXXX XXXX, as joint tenants  
Unit 43: OSKIN PROFESSIONAL CORPORATION.  
Unit 44: XXXX XXXX and XXXX XXXX, as joint tenants  
Unit 45: XXXX XXXX and XXXX XXXX, as joint tenants  
Unit 46: XXXX XXXX  
Unit 47: BORAV DEVELOPMENT LTD.  
Unit 48: 809146 ALBERTA LTD.  
Unit 49: XXXX XXXX and XXXX XXXX, as joint tenants  
Unit 50: XXXX XXXX  
Unit 51: BORAV DEVELOPMENT LTD.  
Unit 52: A. OSKIN PROFESSIONAL CORPORATION.  
Unit 53: XXXX XXXX  
Unit 54: DAN DEVELOPMENTS LTD.  
Unit 55: XXXX XXXX and XXXX XXXX, as joint tenants  
Unit 56: XXXX XXXX  
Unit 57: XXXX XXXX  
Unit 58: XXXX XXXX  
Unit 59: XXXX XXXX  
Unit 60: XXXX XXXX  
Unit 61: XXXX XXXX and XXXX XXXX, as joint tenants

Unit 62: DAN DEVELOPMENTS LTD.  
 Unit 63: 809146 ALBERTA LTD.  
 Unit 64: XXXX XXXX  
 Unit 65: BORAV DEVELOPMENT LTD.  
 Unit 66: DAN DEVELOPMENTS LTD.  
 Unit 67: XXXX XXXX and XXXX XXXX, as joint tenants  
 Unit 68: XXXX XXXX and XXXX XXXX, as joint tenants  
 Unit 69: XXXX XXXX and XXXX XXXX, as joint tenants  
 Unit 70: XXXX XXXX and XXXX XXXX, as joint tenants  
 Unit 71: DAN DEVELOPMENTS LTD.  
 Unit 72: DAN DEVELOPMENTS LTD.

Land Area Required: Approximately 0.0096 hectares, more or less.  
 Improvements within required area: Landscaping

**Registered Interests for Unit 1:**

Registration No.	Name	Registration Type
072 683 331	ROYAL BANK OF CANADA.	MORTGAGE

**Registered Interests for Unit 2:**

Registration No.	Name	Registration Type
982 350 256	CONDOMINIUM PLAN NO. CD5982.	CAVEAT

**Registered Interests for Unit 3:** Nil

**Registered Interests for Unit 4:** Nil

**Registered Interests for Unit 5:**

Registration No.	Name	Registration Type
112 000 679	THE TORONTO DOMINION BANK.	MORTGAGE

**Registered Interests for Unit 6:**

Registration No.	Name	Registration Type
152 301 241	CANADIAN IMPERIAL BANK OF COMMERCE.	MORTGAGE

**Registered Interests for Unit 7:**

Registration No.	Name	Registration Type
132 075 559	SERVUS CREDIT UNION LTD.	MORTGAGE

**Registered Interests for Unit 8:**

Registration No.	Name	Registration Type
182 095 841	CANADIAN WESTERN BANK.	MORTGAGE
182 095 842	CANADIAN WESTERN BANK.	CAVEAT

**Registered Interests for Unit 9:**

Registration No.	Name	Registration Type
112 294 567	MCAP SERVICE CORPORATION.	MORTGAGE

**Registered Interests for Unit 10:**

Registration No.	Name	Registration Type
962 177 348	ALBERTA TREASURY BRANCHES.	MORTGAGE

**Registered Interests for Unit 11:**

Registration No.	Name	Registration Type
162 042 175	COMPUTERSHARE TRUST COMPANY OF CANADA.	MORTGAGE

**Registered Interests for Unit 12: Nil****Registered Interests for Unit 13:**

Registration No.	Name	Registration Type
CDE6150	CMHC.	MORTGAGE

**Registered Interests for Unit 14:**

Registration No.	Name	Registration Type
072 065 837	THE TORONTO DOMINION BANK.	MORTGAGE

**Registered Interests for Unit 15: Nil****Registered Interests for Unit 16:**

Registration No.	Name	Registration Type
072 340 150	THE TORONTO DOMINION BANK.	MORTGAGE

**Registered Interests for Unit 17: Nil****Registered Interests for Unit 18:**

Registration No.	Name	Registration Type
------------------	------	-------------------



182 141 882	ATB FINANCIAL.	MORTGAGE
182 141 883	ATB FINANCIAL.	CAVEAT

**Registered Interests for Unit 19:**

Registration No.	Name	Registration Type
182 095 841	CANADIAN WESTERN BANK.	MORTGAGE
182 095 842	CANADIAN WESTERN BANK.	CAVEAT

**Registered Interests for Unit 20:**

Registration No.	Name	Registration Type
142 197 995	BANK OF MONTREAL.	MORTGAGE
142 197 996	BANK OF MONTREAL.	MORTGAGE

**Registered Interests for Unit 21:**

Registration No.	Name	Registration Type
112 343 954	ROYAL BANK OF CANADA.	MORTGAGE

**Registered Interests for Unit 22:**

Registration No.	Name	Registration Type
092 024 999	THE TORONTO DOMINION BANK.	MORTGAGE

**Registered Interests for Unit 23: Nil**

**Registered Interests for Unit 24:**

Registration No.	Name	Registration Type
172 079 793	THE TORONTO DOMINION BANK.	MORTGAGE

**Registered Interests for Unit 25:**

Registration No.	Name	Registration Type
092 389 271	SERVUS CREDIT UNION LTD.	MORTGAGE
092 389 272	SERVUS CREDIT UNION LTD.	CAVEAT

**Registered Interests for Unit 26:**

Registration No.	Name	Registration Type
162 157 516	BANK OF MONTREAL.	MORTGAGE
182 107 181	C/O GROUP THREE PROPERTY MANAGEMENT INC.	CAVEAT

**Registered Interests for Unit 27:** Nil**Registered Interests for Unit 28:** Nil**Registered Interests for Unit 29:** Nil**Registered Interests for Unit 30:**

Registration No.	Name	Registration Type
------------------	------	-------------------

072 632 744	THE TORONTO DOMINION BANK.	MORTGAGE
122 177 937	C/O GROUP THREE PROPERTY MANAGEMENT INC	CAVEAT
152 123 273	C/O GROUP THREE PROPERTY MANAGEMENT INC	CAVEAT
172 208 521	C/O GROUP THREE PROPERTY MANAGEMENT INC	CAVEAT
192 188 151	ROYAL BANK OF CANADA.	WRIT

**Registered Interests for Unit 31:** Nil

**Registered Interests for Unit 32:** Nil

**Registered Interests for Unit 33:** Nil

**Registered Interests for Unit 34:**

Registration No.	Name	Registration Type
022 193 029	ROYAL BANK OF CANADA.	MORTGAGE

**Registered Interests for Unit 35:** Nil

**Registered Interests for Unit 36:**

Registration No.	Name	Registration Type
082 381 524	ROYAL BANK OF CANADA.	MORTGAGE

**Registered Interests for Unit 37: Nil****Registered Interests for Unit 38:**

Registration No.	Name	Registration Type
072 727 334	SERVUS CREDIT UNION LTD.	MORTGAGE
102 445 157	SERVUS CREDIT UNION LTD.	CAVEAT

**Registered Interests for Unit 39:**

Registration No.	Name	Registration Type
092 389 200	SERVUS CREDIT UNION LTD.	MORTGAGE
092 389 201	SERVUS CREDIT UNION LTD.	CAVEAT

**Registered Interests for Unit 40:**

Registration No.	Name	Registration Type
062 148 592	ROYAL BANK OF CANADA.	MORTGAGE

**Registered Interests for Unit 41:**

Registration No.	Name	Registration Type
132 258 357	BANK OF MONTREAL.	MORTGAGE

**Registered Interests for Unit 42:**

Registration No.	Name	Registration Type
------------------	------	-------------------

082 192 583	THE TORONTO DOMINION BANK.	MORTGAGE
182 298 483	ROYAL BANK OF CANADA.	WRIT
192 267 595	CONSOLIDATED CIVIL ENFORCEMENT INC.	CAVEAT

**Registered Interests for Unit 43:** Nil

**Registered Interests for Unit 44:**

Registration No.	Name	Registration Type
162 221 531	THE TORONTO DOMINION BANK.	MORTGAGE

**Registered Interests for Unit 45:** Nil

**Registered Interests for Unit 46:**

Registration No.	Name	Registration Type
152 305 513	COMPUTERSHARE TRUST COMPANY OF CANADA.	MORTGAGE

**Registered Interests for Unit 47:**

Registration No.	Name	Registration Type
982 255 798	SCOTIA MORTGAGE CORPORATION.	MORTGAGE

**Registered Interests for Unit 48:**

Registration No.	Name	Registration Type
992 320 867	ROYAL BANK OF CANADA.	MORTGAGE

**Registered Interests for Unit 49:** Nil

**Registered Interests for Unit 50:** Nil

**Registered Interests for Unit 51:**

Registration No.	Name	Registration Type
092 389 233	SERVUS CREDIT UNION LTD.	MORTGAGE
092 389 234	SERVUS CREDIT UNION LTD.	CAVEAT

**Registered Interests for Unit 52:** Nil

**Registered Interests for Unit 53:**

Registration No.	Name	Registration Type
102 173 674	ROYAL BANK OF CANADA.	MORTGAGE

**Registered Interests for Unit 54:**

Registration No.	Name	Registration Type
182 095 841	CANADIAN WESTERN BANK.	MORTGAGE
182 095 842	CANADIAN WESTERN BANK.	CAVEAT

**Registered Interests for Unit 55:**

Registration No.	Name	Registration Type
132 292 601	BANK OF MONTREAL.	MORTGAGE

**Registered Interests for Unit 56:** Nil

**Registered Interests for Unit 57:** Nil

**Registered Interests for Unit 58:** Nil

**Registered Interests for Unit 59:** Nil

**Registered Interests for Unit 60:** Nil

**Registered Interests for Unit 61:**

Registration No.	Name	Registration Type
042 149 690	THE TORONTO DOMINION BANK.	MORTGAGE
092 308 580	THE TORONTO DOMINION BANK.	MORTGAGE

**Registered Interests for Unit 62:**

Registration No.	Name	Registration Type
182 095 841	CANADIAN WESTERN BANK.	MORTGAGE
182 095 842	CANADIAN WESTERN BANK.	CAVEAT

**Registered Interests for Unit 63:**

Registration No.	Name	Registration Type
------------------	------	-------------------

992 136 050	CIBC MORTGAGES INC.	MORTGAGE
-------------	---------------------	----------

**Registered Interests for Unit 64:**

Registration No.	Name	Registration Type
082 229 388	THE TORONTO DOMINION BANK.	MORTGAGE

**Registered Interests for Unit 65: Nil****Registered Interests for Unit 66:**

Registration No.	Name	Registration Type
182 095 841	CANADIAN WESTERN BANK.	MORTGAGE
182 095 842	CANADIAN WESTERN BANK.	CAVEAT

**Registered Interests for Unit 67: Nil****Registered Interests for Unit 68:**

Registration No.	Name	Registration Type
152 082 355	BANK OF MONTREAL.	MORTGAGE

**Registered Interests for Unit 69:**

Registration No.	Name	Registration Type
172 175 868	CANADIAN WESTERN BANK.	MORTGAGE
172 175 869	CANADIAN WESTERN BANK.	CAVEAT



**Registered Interests for Unit 70**

Registration No.	Name	Registration Type
082 113 837	COMPUTERSHARE TRUST COMPANY OF CANADA.	MORTGAGE

**Registered Interests for Unit 71:**

Registration No.	Name	Registration Type
182 095 841	CANADIAN WESTERN BANK.	MORTGAGE
182 095 842	CANADIAN WESTERN BANK.	CAVEAT

**Registered Interests for Unit 72: Nil**

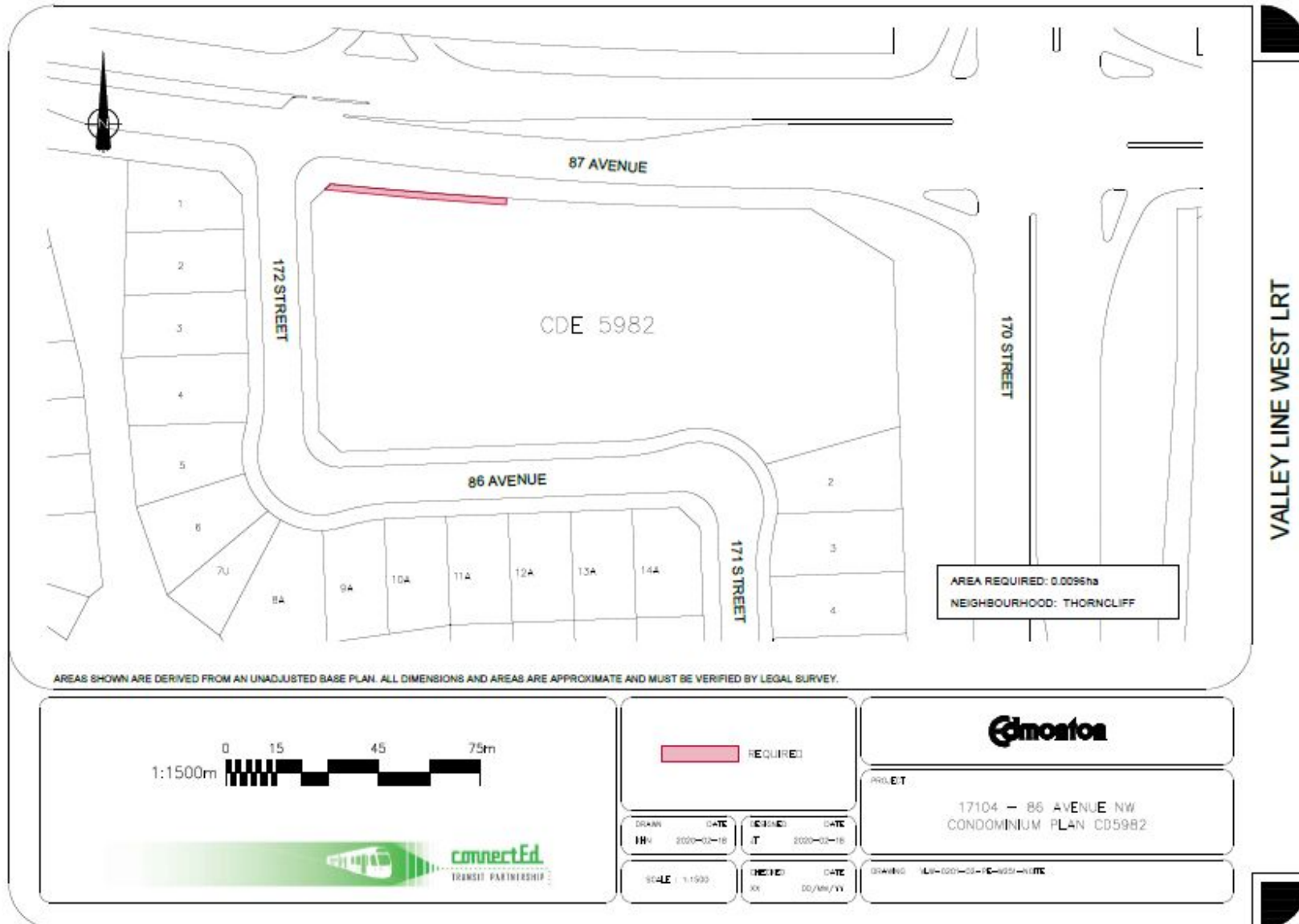

**PROPERTY 11:**

Municipal Address: **9935 - 156 Street NW, Edmonton, AB**

Legal Description: PLAN 3333AJ  
BLOCK 3  
LOT 16  
EXCEPTING THEREOUT ALL MINES AND MINERALS

PLAN 3333AJ  
BLOCK 3  
LOT 17  
EXCEPTING THEREOUT ALL MINES AND MINERALS

Registered Owner: K Hansen Masonry Ltd.

Estate: Fee Simple

Certificate of Title No: Property 4A: 782 205 301 (North Alberta Land Registration District)

Property 4B: 782 171 045 (North Alberta Land Registration District)

Land Area Required: Approximately 182.843m<sup>2</sup>, more or less

Known Improvements  
within Area of Land

Required: Landscaping

**Registered Interests: Nil**

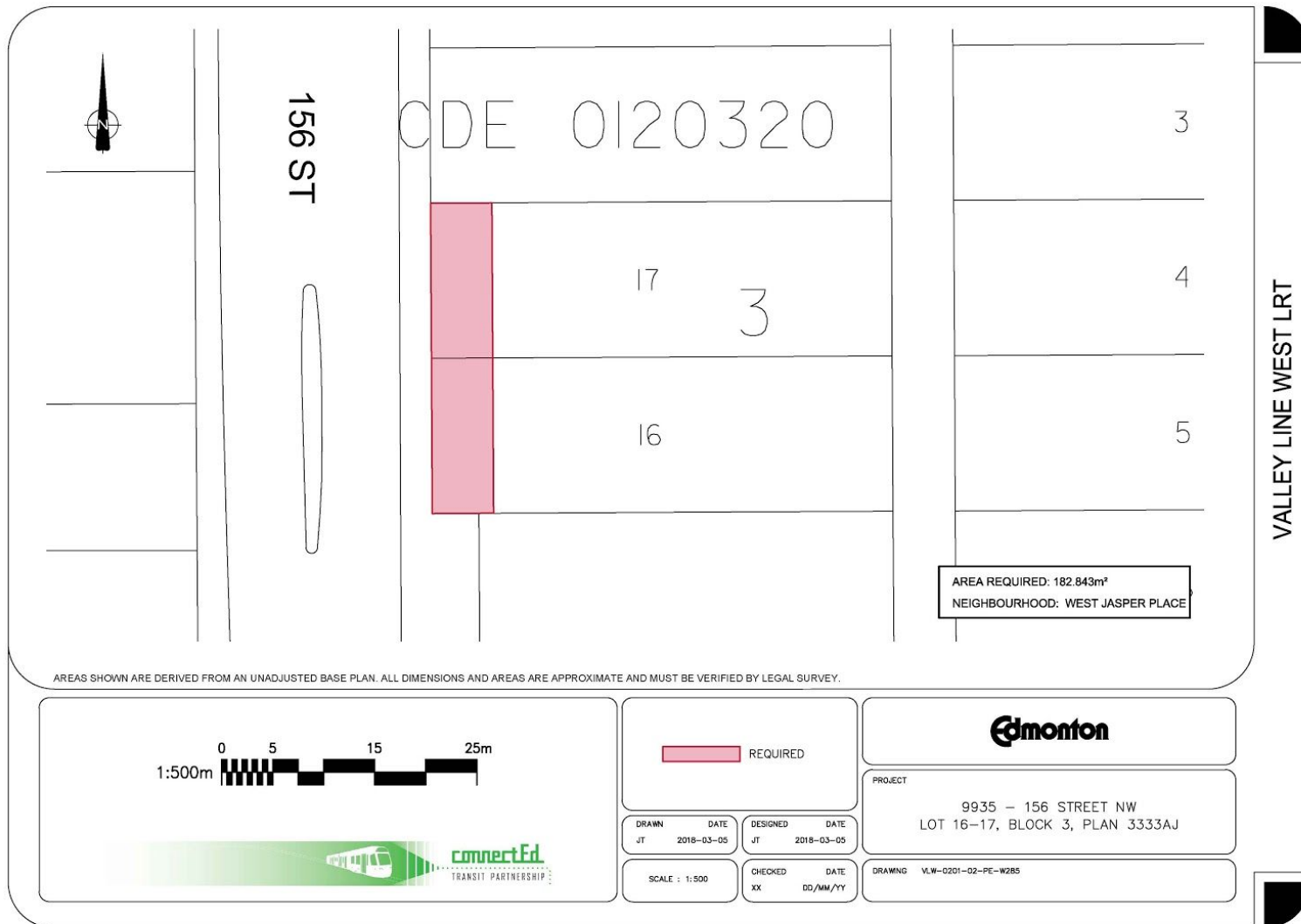

**PROPERTY 12:** FEE SIMPLE in the area required as shown on Diagram “A”; and UTILITY RIGHT OF WAY, for the construction, operation, maintenance, and replacement of a public walkway and related appurtenances including landscaping and roadway improvements, in the area required as shown on Diagram “B”

Municipal Address: **12225 Stony Plain Road NW, Edmonton, AB**

Legal Description: Unit 1: CONDOMINIUM PLAN 8321021  
UNIT 1  
AND 75 UNDIVIDED ONE TEN THOUSANDTH SHARES IN THE COMMON PROPERTY EXCEPTING THEREOUT ALL MINES AND MINERALS

Unit 2: CONDOMINIUM PLAN 8321021  
UNIT 2  
AND 66 UNDIVIDED ONE TEN THOUSANDTH SHARES IN THE COMMON PROPERTY EXCEPTING THEREOUT ALL MINES AND MINERALS

Unit 3: CONDOMINIUM PLAN 8321021  
UNIT 3  
AND 102 UNDIVIDED ONE TEN THOUSANDTH SHARES IN THE COMMON PROPERTY EXCEPTING THEREOUT ALL MINES AND MINERALS

Unit 4: CONDOMINIUM PLAN 8321021  
UNIT 4  
AND 68 UNDIVIDED ONE TEN THOUSANDTH SHARES IN THE COMMON PROPERTY EXCEPTING THEREOUT ALL MINES AND MINERALS

Unit 5: CONDOMINIUM PLAN 8321021  
UNIT 5  
AND 105 UNDIVIDED ONE TEN THOUSANDTH SHARES IN THE COMMON PROPERTY EXCEPTING THEREOUT ALL MINES AND MINERALS

Unit 6: CONDOMINIUM PLAN 8321021  
UNIT 6  
AND 102 UNDIVIDED ONE TEN THOUSANDTH SHARES IN THE COMMON PROPERTY EXCEPTING THEREOUT ALL MINES AND MINERALS

Unit 7: CONDOMINIUM PLAN 8321021  
UNIT 7

- Unit 8: AND 123 UNDIVIDED ONE TEN THOUSANDTH SHARES IN THE COMMON PROPERTY EXCEPTING THEREOUT ALL MINES AND MINERALS  
CONDOMINIUM PLAN 8321021  
UNIT 8
- Unit 9: AND 111 UNDIVIDED ONE TEN THOUSANDTH SHARES IN THE COMMON PROPERTY EXCEPTING THEREOUT ALL MINES AND MINERALS  
CONDOMINIUM PLAN 8321021  
UNIT 9
- Unit 10: AND 113 UNDIVIDED ONE TEN THOUSANDTH SHARES IN THE COMMON PROPERTY EXCEPTING THEREOUT ALL MINES AND MINERALS  
CONDOMINIUM PLAN 8321021  
UNIT 10
- Unit 11: AND 110 UNDIVIDED ONE TEN THOUSANDTH SHARES IN THE COMMON PROPERTY EXCEPTING THEREOUT ALL MINES AND MINERALS  
CONDOMINIUM PLAN 8321021  
UNIT 11
- Unit 12: AND 132 UNDIVIDED ONE TEN THOUSANDTH SHARES IN THE COMMON PROPERTY EXCEPTING THEREOUT ALL MINES AND MINERALS  
CONDOMINIUM PLAN 8321021  
UNIT 12
- Unit 13: AND 128 UNDIVIDED ONE TEN THOUSANDTH SHARES IN THE COMMON PROPERTY EXCEPTING THEREOUT ALL MINES AND MINERALS  
CONDOMINIUM PLAN 8321021  
UNIT 13
- Unit 14: AND 149 UNDIVIDED ONE TEN THOUSANDTH SHARES IN THE COMMON PROPERTY EXCEPTING THEREOUT ALL MINES AND MINERALS  
CONDOMINIUM PLAN 8321021  
UNIT 14
- Unit 15: AND 137 UNDIVIDED ONE TEN THOUSANDTH SHARES IN THE COMMON PROPERTY EXCEPTING THEREOUT ALL MINES AND MINERALS  
CONDOMINIUM PLAN 8321021  
UNIT 15  
AND 139 UNDIVIDED ONE TEN THOUSANDTH SHARES IN THE COMMON PROPERTY

- Unit 16: EXCEPTING THEREOUT ALL MINES AND MINERALS  
CONDOMINIUM PLAN 8321021  
UNIT 16  
AND 136 UNDIVIDED ONE TEN THOUSANDTH SHARES IN THE COMMON PROPERTY  
EXCEPTING THEREOUT ALL MINES AND MINERALS
- Unit 17: CONDOMINIUM PLAN 8321021  
UNIT 17  
AND 158 UNDIVIDED ONE TEN THOUSANDTH SHARES IN THE COMMON PROPERTY  
EXCEPTING THEREOUT ALL MINES AND MINERALS
- Unit 18: CONDOMINIUM PLAN 8321021  
UNIT 18  
AND 154 UNDIVIDED ONE TEN THOUSANDTH SHARES IN THE COMMON PROPERTY  
EXCEPTING THEREOUT ALL MINES AND MINERALS
- Unit 19: CONDOMINIUM PLAN 8321021  
UNIT 19  
AND 175 UNDIVIDED ONE TEN THOUSANDTH SHARES IN THE COMMON PROPERTY  
EXCEPTING THEREOUT ALL MINES AND MINERALS
- Unit 20: CONDOMINIUM PLAN 8321021  
UNIT 20  
AND 163 UNDIVIDED ONE TEN THOUSANDTH SHARES IN THE COMMON PROPERTY  
EXCEPTING THEREOUT ALL MINES AND MINERALS
- Unit 21: CONDOMINIUM PLAN 8321021  
UNIT 21  
AND 165 UNDIVIDED ONE TEN THOUSANDTH SHARES IN THE COMMON PROPERTY  
EXCEPTING THEREOUT ALL MINES AND MINERALS
- Unit 22: CONDOMINIUM PLAN 8321021  
UNIT 22  
AND 162 UNDIVIDED ONE TEN THOUSANDTH SHARES IN THE COMMON PROPERTY  
EXCEPTING THEREOUT ALL MINES AND MINERALS
- Unit 23: CONDOMINIUM PLAN 8321021  
UNIT 23  
AND 184 UNDIVIDED ONE TEN THOUSANDTH SHARES IN THE COMMON PROPERTY  
EXCEPTING THEREOUT ALL MINES AND MINERALS

- Unit 24: CONDOMINIUM PLAN 8321021  
UNIT 24  
AND 180 UNDIVIDED ONE TEN THOUSANDTH SHARES IN THE COMMON PROPERTY  
EXCEPTING THEREOUT ALL MINES AND MINERALS
- Unit 25: CONDOMINIUM PLAN 8321021  
UNIT 25  
AND 201 UNDIVIDED ONE TEN THOUSANDTH SHARES IN THE COMMON PROPERTY  
EXCEPTING THEREOUT ALL MINES AND MINERALS
- Unit 26: CONDOMINIUM PLAN 8321021  
UNIT 26  
AND 189 UNDIVIDED ONE TEN THOUSANDTH SHARES IN THE COMMON PROPERTY  
EXCEPTING THEREOUT ALL MINES AND MINERALS
- Unit 27: CONDOMINIUM PLAN 8321021  
UNIT 27  
AND 191 UNDIVIDED ONE TEN THOUSANDTH SHARES IN THE COMMON PROPERTY  
EXCEPTING THEREOUT ALL MINES AND MINERALS
- Unit 28: CONDOMINIUM PLAN 8321021  
UNIT 28  
AND 188 UNDIVIDED ONE TEN THOUSANDTH SHARES IN THE COMMON PROPERTY  
EXCEPTING THEREOUT ALL MINES AND MINERALS
- Unit 29: CONDOMINIUM PLAN 8321021  
UNIT 29  
AND 210 UNDIVIDED ONE TEN THOUSANDTH SHARES IN THE COMMON PROPERTY  
EXCEPTING THEREOUT ALL MINES AND MINERALS
- Unit 30: CONDOMINIUM PLAN 8321021  
UNIT 30  
AND 206 UNDIVIDED ONE TEN THOUSANDTH SHARES IN THE COMMON PROPERTY  
EXCEPTING THEREOUT ALL MINES AND MINERALS
- Unit 31: CONDOMINIUM PLAN 8321021  
UNIT 31  
AND 227 UNDIVIDED ONE TEN THOUSANDTH SHARES IN THE COMMON PROPERTY  
EXCEPTING THEREOUT ALL MINES AND MINERALS
- Unit 32: CONDOMINIUM PLAN 8321021



- UNIT 32  
AND 215 UNDIVIDED ONE TEN THOUSANDTH SHARES IN THE COMMON PROPERTY  
EXCEPTING THEREOUT ALL MINES AND MINERALS
- Unit 33: CONDOMINIUM PLAN 8321021  
UNIT 33  
AND 217 UNDIVIDED ONE TEN THOUSANDTH SHARES IN THE COMMON PROPERTY  
EXCEPTING THEREOUT ALL MINES AND MINERALS
- Unit 34: CONDOMINIUM PLAN 8321021  
UNIT 34  
AND 214 UNDIVIDED ONE TEN THOUSANDTH SHARES IN THE COMMON PROPERTY  
EXCEPTING THEREOUT ALL MINES AND MINERALS
- Unit 35: CONDOMINIUM PLAN 8321021  
UNIT 35  
AND 236 UNDIVIDED ONE TEN THOUSANDTH SHARES IN THE COMMON PROPERTY  
EXCEPTING THEREOUT ALL MINES AND MINERALS
- Unit 36: CONDOMINIUM PLAN 8321021  
UNIT 36  
AND 232 UNDIVIDED ONE TEN THOUSANDTH SHARES IN THE COMMON PROPERTY  
EXCEPTING THEREOUT ALL MINES AND MINERALS
- Unit 37: CONDOMINIUM PLAN 8321021  
UNIT 37  
AND 253 UNDIVIDED ONE TEN THOUSANDTH SHARES IN THE COMMON PROPERTY  
EXCEPTING THEREOUT ALL MINES AND MINERALS
- Unit 38: CONDOMINIUM PLAN 8321021  
UNIT 38  
AND 241 UNDIVIDED ONE TEN THOUSANDTH SHARES IN THE COMMON PROPERTY  
EXCEPTING THEREOUT ALL MINES AND MINERALS
- Unit 39: CONDOMINIUM PLAN 8321021  
UNIT 39  
AND 243 UNDIVIDED ONE TEN THOUSANDTH SHARES IN THE COMMON PROPERTY  
EXCEPTING THEREOUT ALL MINES AND MINERALS
- Unit 40: CONDOMINIUM PLAN 8321021  
UNIT 40

- Unit 41: AND 240 UNDIVIDED ONE TEN THOUSANDTH SHARES IN THE COMMON PROPERTY EXCEPTING THEREOUT ALL MINES AND MINERALS  
CONDOMINIUM PLAN 8321021  
UNIT 41
- Unit 42: AND 262 UNDIVIDED ONE TEN THOUSANDTH SHARES IN THE COMMON PROPERTY EXCEPTING THEREOUT ALL MINES AND MINERALS  
CONDOMINIUM PLAN 8321021  
UNIT 42
- Unit 43: AND 258 UNDIVIDED ONE TEN THOUSANDTH SHARES IN THE COMMON PROPERTY EXCEPTING THEREOUT ALL MINES AND MINERALS  
CONDOMINIUM PLAN 8321021  
UNIT 43
- Unit 44: AND 279 UNDIVIDED ONE TEN THOUSANDTH SHARES IN THE COMMON PROPERTY EXCEPTING THEREOUT ALL MINES AND MINERALS  
CONDOMINIUM PLAN 8321021  
UNIT 44
- Unit 45: AND 267 UNDIVIDED ONE TEN THOUSANDTH SHARES IN THE COMMON PROPERTY EXCEPTING THEREOUT ALL MINES AND MINERALS  
CONDOMINIUM PLAN 8321021  
UNIT 45
- Unit 46: AND 270 UNDIVIDED ONE TEN THOUSANDTH SHARES IN THE COMMON PROPERTY EXCEPTING THEREOUT ALL MINES AND MINERALS  
CONDOMINIUM PLAN 8321021  
UNIT 46
- Unit 47: AND 266 UNDIVIDED ONE TEN THOUSANDTH SHARES IN THE COMMON PROPERTY EXCEPTING THEREOUT ALL MINES AND MINERALS  
CONDOMINIUM PLAN 8321021  
UNIT 47
- Unit 48: AND 288 UNDIVIDED ONE TEN THOUSANDTH SHARES IN THE COMMON PROPERTY EXCEPTING THEREOUT ALL MINES AND MINERALS  
CONDOMINIUM PLAN 8321021  
UNIT 48  
AND 284 UNDIVIDED ONE TEN THOUSANDTH SHARES IN THE COMMON PROPERTY

- Unit 49: EXCEPTING THEREOUT ALL MINES AND MINERALS  
CONDOMINIUM PLAN 8321021  
UNIT 49  
AND 305 UNDIVIDED ONE TEN THOUSANDTH SHARES IN THE COMMON PROPERTY  
EXCEPTING THEREOUT ALL MINES AND MINERALS
- Unit 50: CONDOMINIUM PLAN 8321021  
UNIT 50  
AND 293 UNDIVIDED ONE TEN THOUSANDTH SHARES IN THE COMMON PROPERTY  
EXCEPTING THEREOUT ALL MINES AND MINERALS
- Unit 51: CONDOMINIUM PLAN 8321021  
UNIT 51  
AND 296 UNDIVIDED ONE TEN THOUSANDTH SHARES IN THE COMMON PROPERTY  
EXCEPTING THEREOUT ALL MINES AND MINERALS
- Unit 52: CONDOMINIUM PLAN 0824438  
UNIT 52  
AND 292 UNDIVIDED ONE TEN THOUSANDTH SHARES IN THE COMMON PROPERTY  
EXCEPTING THEREOUT ALL MINES AND MINERALS

Registered Owner: Units 1 to 52: LESTON HOLDINGS (1980) LTD.  
Certificate of Title No: Unit 1: 162 232 128 (North Alberta Land Registration District)  
Unit 2: 162 232 128 +1 (North Alberta Land Registration District)  
Unit 3: 162 232 128 +2 (North Alberta Land Registration District)  
Unit 4: 162 232 128 +3 (North Alberta Land Registration District)  
Unit 5: 162 232 128 +4 (North Alberta Land Registration District)  
Unit 6: 162 232 128 +5 (North Alberta Land Registration District)  
Unit 7: 162 232 128 +6 (North Alberta Land Registration District)  
Unit 8: 162 232 128 +7 (North Alberta Land Registration District)  
Unit 9: 162 232 128 +8 (North Alberta Land Registration District)  
Unit 10: 162 232 128 +9 (North Alberta Land Registration District)  
Unit 11: 162 232 128 +10 (North Alberta Land Registration District)  
Unit 12: 162 232 128 +11 (North Alberta Land Registration District)  
Unit 13: 162 232 128 +12 (North Alberta Land Registration District)  
Unit 14: 162 232 128 +13 (North Alberta Land Registration District)

- Unit 15 :162 232 128 +14 (North Alberta Land Registration District)
- Unit 16: 162 232 128 +15 (North Alberta Land Registration District)
- Unit 17: 162 232 128 +16 (North Alberta Land Registration District)
- Unit 18: 162 232 128 +17 (North Alberta Land Registration District)
- Unit 19: 162 232 128 +18 (North Alberta Land Registration District)
- Unit 20: 162 232 128 +19 (North Alberta Land Registration District)
- Unit 21: 162 232 128 +20 (North Alberta Land Registration District)
- Unit 22: 162 232 128 +21 (North Alberta Land Registration District)
- Unit 23: 162 232 128 +22 (North Alberta Land Registration District)
- Unit 24: 162 232 128 +23 (North Alberta Land Registration District)
- Unit 25: 162 232 128 +24 (North Alberta Land Registration District)
- Unit 26: 162 232 128 +25 (North Alberta Land Registration District)
- Unit 27: 162 232 128 +26 (North Alberta Land Registration District)
- Unit 28: 162 232 128 +27 (North Alberta Land Registration District)
- Unit 29: 162 232 128 +28 (North Alberta Land Registration District)
- Unit 30: 162 232 128 +29 (North Alberta Land Registration District)
- Unit 31: 162 232 128 +30 (North Alberta Land Registration District)
- Unit 32: 162 232 128 +31 (North Alberta Land Registration District)
- Unit 33: 162 232 128 +32 (North Alberta Land Registration District)
- Unit 34: 162 232 128 +33 (North Alberta Land Registration District)
- Unit 35: 162 232 128 +34 (North Alberta Land Registration District)
- Unit 36: 162 232 128 +35 (North Alberta Land Registration District)
- Unit 37: 162 232 128 +36 (North Alberta Land Registration District)
- Unit 38: 162 232 128 +37 (North Alberta Land Registration District)
- Unit 39: 162 232 128 +38 (North Alberta Land Registration District)
- Unit 40: 162 232 128 +39 (North Alberta Land Registration District)
- Unit 41: 162 232 128 +40 (North Alberta Land Registration District)
- Unit 42: 162 232 128 +41 (North Alberta Land Registration District)
- Unit 43: 162 232 128 +42 (North Alberta Land Registration District)
- Unit 44: 162 232 128 +43 (North Alberta Land Registration District)
- Unit 45: 162 232 128 +44 (North Alberta Land Registration District)
- Unit 46: 162 232 128 +45 (North Alberta Land Registration District)
- Unit 47: 162 232 128 +46 (North Alberta Land Registration District)

- Unit 48: 162 232 128 +47 (North Alberta Land Registration District)
- Unit 49: 162 232 128 +48 (North Alberta Land Registration District)
- Unit 50: 162 232 128 +49 (North Alberta Land Registration District)
- Unit 51: 162 232 128 +50 (North Alberta Land Registration District)
- Unit 52: 162 232 128 +51 (North Alberta Land Registration District)

Land Area Required: Approximately 51.012m<sup>2</sup>, more or less, for the fee simple interest, and approximately 13.284m<sup>2</sup>, more or less, for the utility right of way

Known Improvements  
within Area of Land

Required: Landscaping and transformer

**Registered Interests for Units 1 to 52:**

<b>Registration No.</b>	<b>Name</b>	<b>Registration Type</b>
172 293 071	PEOPLES TRUST COMPANY.	MORTGAGE
172 293 072	PEOPLES TRUST COMPANY.	CAVEAT RE: ASSIGNMENT OF RENTS AND LEASES

DIAGRAM "A"

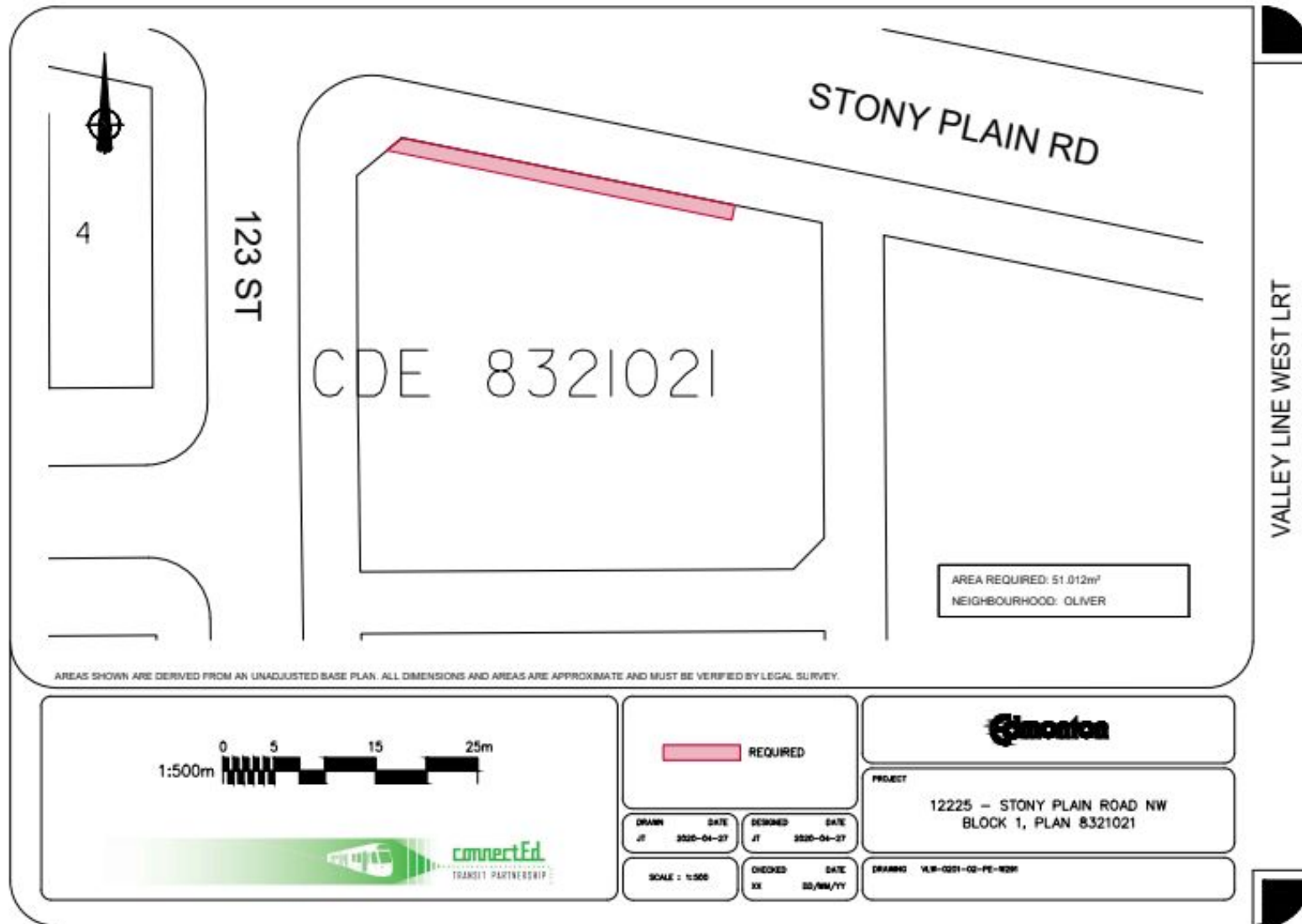
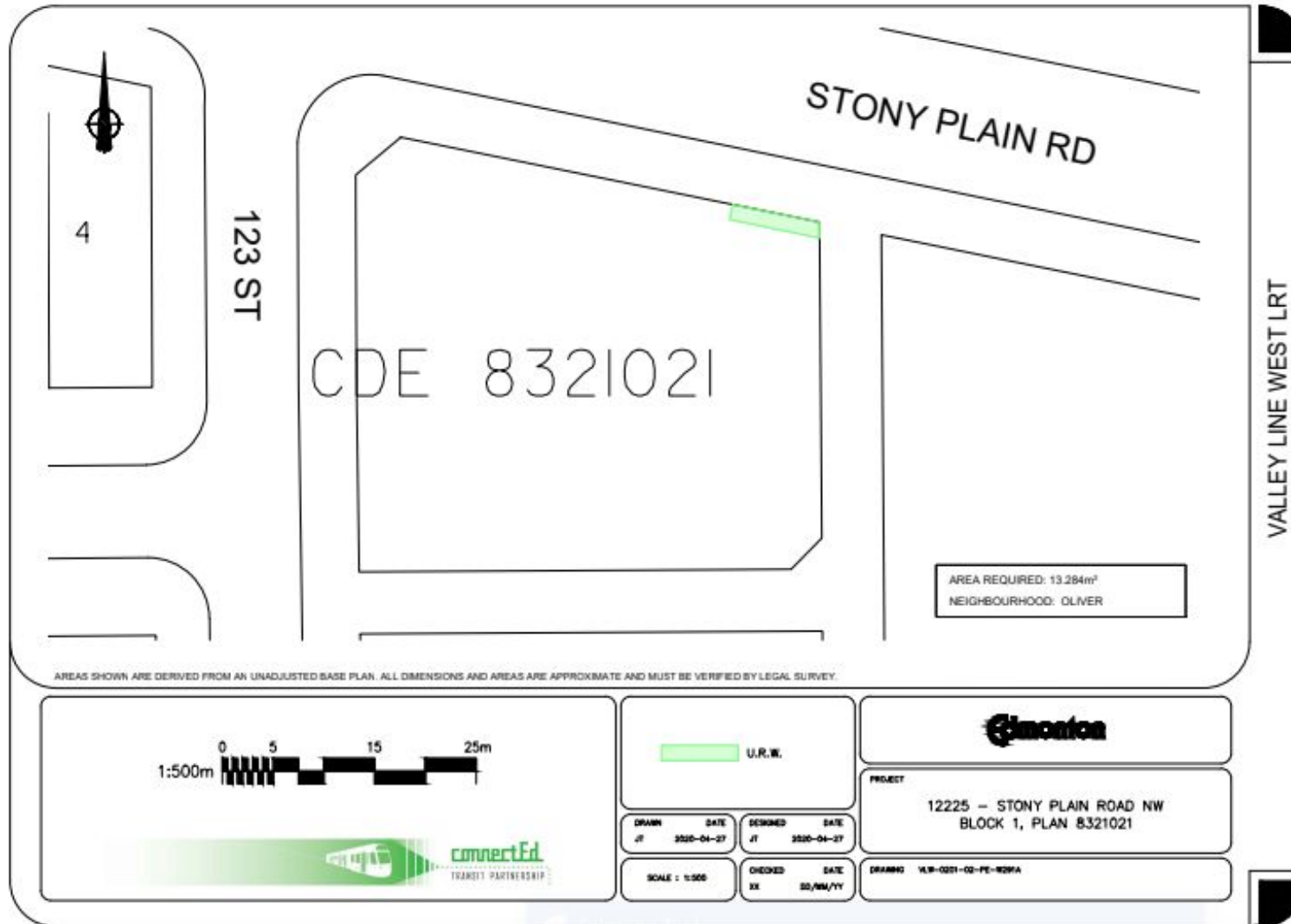

DIAGRAM "B"



**PROPERTY 13:**

Municipal Address: **10350 - 122 Street NW, Edmonton, AB**  
 Legal Description: PLAN 2806RS  
 BLOCK 3  
 LOT F  
 EXCEPTING THEREOUT ALL MINES AND MINERALS  
 Registered Owner: BPCL HOLDINGS INC.  
 Estate: Fee Simple  
 Certificate of Title No: 982 026 117 (North Alberta Land Registration District)  
 Land Area Required: Approximately 64.339m<sup>2</sup>, more or less

Known Improvements  
 within Area of Land

Required: Landscaping

**Registered Interests:**

<b>Registration No.</b>	<b>Name</b>	<b>Registration Type</b>
982 071 721	ROYAL BANK OF CANADA.	MORTGAGE
982 071 722	ROYAL BANK OF CANADA.	CAVEAT RE: ASSIGNMENT OF LEASE
982 071 723	ROYAL BANK OF CANADA.	CAVEAT RE: ASSIGNMENT OF RENTS
002 168 834	ROYAL BANK OF CANADA.	AMENDING AGREEMENT
022 063 713	VIDEON CABLESYSTEMS INC.	CAVEAT RE : RIGHT OF WAY AGREEMENT
042 470 742	ROYAL BANK OF CANADA.	CAVEAT RE: MORTGAGE AMENDING AGREEMENT
082 154 722	ROYAL BANK OF CANADA.	MORTGAGE
082 154 723	ROYAL BANK OF CANADA.	CAVEAT RE: ASSIGNMENT OF RENTS AND LEASES
082 193 504	ROYAL BANK OF CANADA.	CAVEAT RE: AMENDING AGREEMENT
082 196 234	ROYAL BANK OF CANADA.	CAVEAT RE: AMENDING AGREEMENT
102 353 237	BOARDWALK REAL ESTATE MANAGEMENT LTD.	CAVEAT RE: BENEFICIAL OWNER



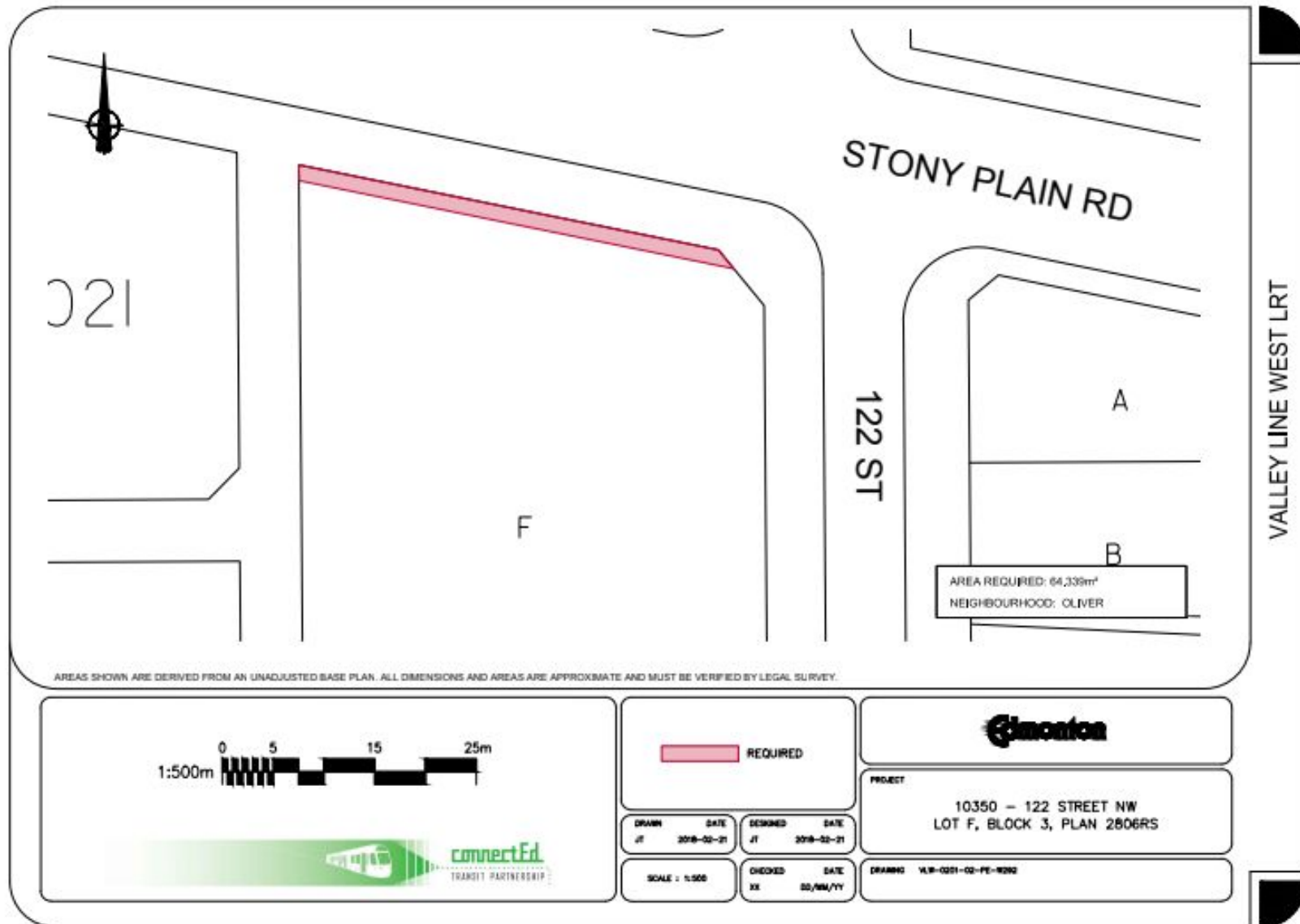

**PROPERTY 14:**

Municipal Address: **9509 - 156 Street NW, Edmonton, AB**

Legal Description: PLAN 6530ET  
BLOCK SEVEN (7)  
THE SOUTH HALF OF LOT THREE (3), THE SOUTH HALF OF LOT SIX (6) AND ALL OF LOTS  
FOUR (4) AND FIVE (5)

EXCEPTING THEREOUT:

A) ALL THOSE PORTIONS OF LOTS THREE (3) AND FOUR (4) IN SAID BLOCK AND PLAN DESCRIBED AS FOLLOWS:-- COMMENCING AT A POINT IN THE SOUTH BOUNDARY OF THE SAID LOT FOUR (4) TWENTY FIVE (25) FEET EASTERLY FROM THE SOUTHERLY CORNER THEREOF THENCE WESTERLY ALONG THE SAID SOUTH BOUNDARY OF THE SAID LOT FOUR (4) TO THE SAID SOUTH WEST CORNER THEREOF THENCE NORTHERLY ALONG THE WEST BOUNDARIES OF THE SAID LOTS THREE (3) AND FOUR (4) ONE HUNDRED AND FIFTY (150) FEET THENCE EASTERLY AND PARALLEL TO THE SAID SOUTH BOUNDARY OF THE SAID LOT FOUR (4) TEN (10) FEET THENCE SOUTHERLY AND PARALLEL TO THE SAID WEST BOUNDARIES OF THE SAID LOTS TO A POINT FIFTEEN (15) FEET PERPENDICULARLY DISTANT NORTHERLY FROM THE SAID BOUNDARY OF THE SAID LOT FOUR (4) THENCE SOUTH EASTERLY IN A STRAIGHT LINE TO THE POINT OF COMMENCEMENT

(B) ALL THAT PORTION OF LOT FIVE (5) IN THE SAID BLOCK SEVEN (7) WHICH LIES SOUTH EAST OF A STRAIGHT LINE JOINING A POINT IN THE EAST BOUNDARY OF THE SAID LOT FIFTEEN (15) FEET NORTHERLY FROM THE SOUTH EAST CORNER THEREOF TO A POINT IN THE SOUTH BOUNDARY OF THE SAID LOT FIFTEEN (15) FEET WESTERLY FROM THE SAID SOUTH EAST CORNER THEREOF

EXCEPTING THEREOUT ALL MINES AND MINERALS

Registered Owner: XXXXXX

Estate: Fee Simple

Certificate of Title No: 872 266 995 (North Alberta Land Registration District)

Land Area Required: Approximately 77.072m<sup>2</sup>, more or less

Known Improvements  
within Area of Land

Required: Landscaping, Sidewalk

**Registered Interests:**

<b>Registration No.</b>	<b>Name</b>	<b>Registration Type</b>
792 266 841	XXXX	CAVEAT
792 297 917	XXXX, XXXX AND XXXX	CAVEAT
962 058 418	A. BRENDA LAU PROFESSIONAL CORPORATION	CAVEAT RE: LEASE
022 117 173	809822 ALBERTA LTD.	CAVEAT RE: LEASE
062 167 092	XXXX	LAPSE OF CAVEAT
062 167 093	XXXX	LAPSE OF CAVEAT
062 408 154	A. BRENDA LAU PROFESSIONAL CORPORATION.	CAVEAT RE: LEASE, ETC.
132 146 504	PETER GUO PROFESSIONAL CORPORATION.	CAVEAT RE: LEASE INTEREST

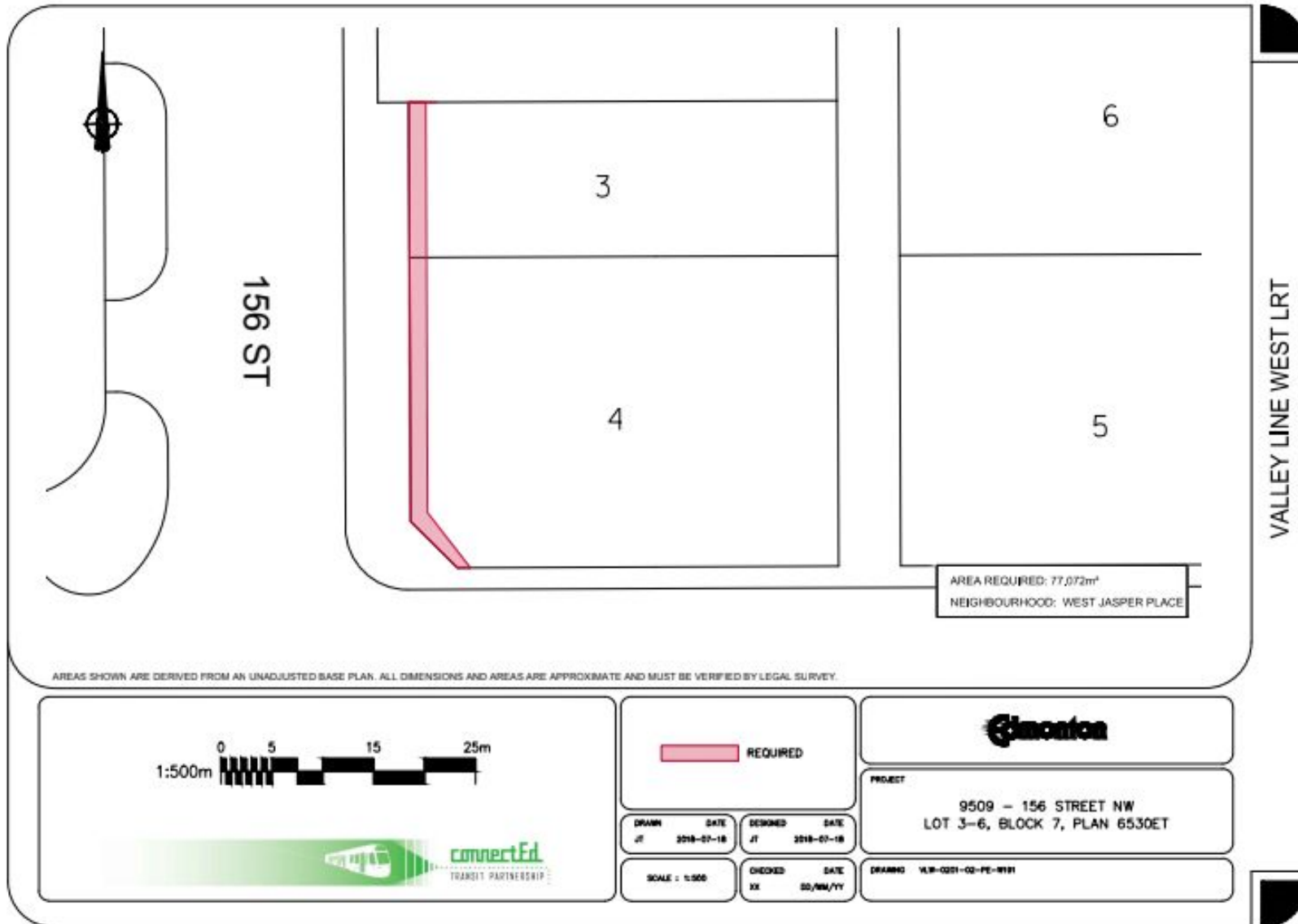

**PROPERTY 15:** FEE SIMPLE in the area required as shown on Diagram "A"; and UTILITY RIGHT OF WAY, for the construction, operation, protection, and maintenance of a transit shelter, in the area required as shown on Diagram "B"

Municipal Address: **1 Meadowlark Park Shopping Centre NW, Edmonton, AB**

Legal Description: DESCRIPTIVE PLAN 9924575

BLOCK 10

LOT 2

EXCEPTING THEREOUT ALL MINES AND MINERALS

AREA: 9.39 HECTARES (23.2 ACRES) MORE OR LESS

Registered Owner: FIRST CAPITAL (MEADOWLARK) CORPORATION

Certificate of Title No: 112 217 513 (North Alberta Land Registration District)

Land Area Required: Approximately 1213.680m<sup>2</sup>, more or less, for the fee simple interest, and approximately 38.827m<sup>2</sup>, more or less, for the utility right of way

Known Improvements  
within Area of Land

Required: Landscaping, concrete walkway, power for parking stalls

#### Registered Interests:

Registration No.	Name	Registration Type
922 226 854	SOBEYS WEST INC.	CAVEAT RE : LEASE
922 235 996	WAL-MART CANADA CORP./LA COMPAGNIE WAL-MART DU CANADA.	CAVEAT
932 222 302	ROYAL BANK OF CANADA.	CAVEAT RE : LEASE
932 261 437	CANADIAN IMPERIAL BANK OF COMMERCE.	CAVEAT RE : LEASE
932 354 054	KFCC / PEPSICO HOLDINGS LTD.	CAVEAT RE : LEASE
942 254 184	LIQUOR STORES GP INC.	CAVEAT RE : LEASE
982 142 337	MCDONALD'S RESTAURANTS OF CANADA LIMITED.	CAVEAT RE : LEASE, ETC.

992 020 413	HER MAJESTY THE QUEEN IN RIGHT OF ALBERTA AS REPRESENTED BY MINISTER OF PUBLIC WORKS, SUPPLY & SERVICES	CAVEAT RE : LEASE
992 229 035	COVE VENTURES LTD.	EASEMENT
992 229 036	COVE VENTURES LTD.	EASEMENT
992 229 037	FIRST CAPITAL (MEADOWLARK) CORPORATION; CANADA SAFEWAY LIMITED	RESTRICTIVE COVENANT
992 229 038	FIRST CAPITAL (MEADOWLARK) CORPORATION	RESTRICTIVE COVENANT
992 229 039	FIRST CAPITAL (MEADOWLARK) CORPORATION	RESTRICTIVE COVENANT
992 229 040	FIRST CAPITAL (MEADOWLARK) CORPORATION	RESTRICTIVE COVENANT
992 229 041	FIRST CAPITAL (MEADOWLARK) CORPORATION; KFCC/TRICON HOLDINGS LTD.	RESTRICTIVE COVENANT
992 294 729	SOBEYS WEST INC.	CAVEAT RE : LEASE, ETC.
002 065 143	HER MAJESTY THE QUEEN IN RIGHT OF CANADA AS REPRESENTED BY MINISTER OF PUBLIC WORKS AND GOVERNMENT SERVICES CANADA	CAVEAT RE : LEASE
012 062 014	PATRICIA HEIGHTS MEDICAL CLINIC LTD.	CAVEAT RE : LEASE
012 079 382	922090 ALBERTA LTD.	CAVEAT RE : LEASE
012 079 738	XXXXXX	CAVEAT RE : LEASE
012 142 260	854524 ALBERTA LTD	CAVEAT RE : LEASE
012 220 784	864480 ALBERTA LTD.	CAVEAT RE : LEASE
012 220 798	933341 ALBERTA LTD.	CAVEAT RE : LEASE
012 220 809	933125 ALBERTA LTD.	CAVEAT RE : LEASE
012 220 810	936984 ALBERTA LTD.	CAVEAT RE : LEASE
012 292 892	FIRST CAPITAL (MEADOWLARK) CORPORATION; THE LIQUOR DEPOT AT MEADOWLARK LTD.	RESTRICTIVE COVENANT

012 296 752	SOBEYS WEST INC.	CAVEAT RE : LEASE
012 296 753	SOBEYS WEST INC	CAVEAT RE : LEASE
012 357 238	IN FAVOUR OF - DAVID D. CAMPBELL PROFESSIONAL CORPORATION. IN FAVOUR OF - GORDON H. WILKES PROFESSIONAL CORPORATION. IN FAVOUR OF - DAVID C. EDWARDS PROFESSIONAL CORPORATION. IN FAVOUR OF - G. LOBAY PROFESSIONAL CORPORATION. IN FAVOUR OF - G. L. MOYSA PROFESSIONAL CORPORATION. IN FAVOUR OF - G. LOUIE PROFESSIONAL CORPORATION. IN FAVOUR OF - 813872 ALBERTA LTD.  DEBTOR - PLASTIC & COSMETIC LASER SURGICAL CENTRE LTD.	NOTICE OF SECURITY INTEREST RE : FIXTURES
022 411 333	PRISZM BRANDZ INC.	CAVEAT RE : LEASE
032 493 820	XXXXXX	CAVEAT RE : LEASE, ETC.
042 090 865	863815 ALBERTA LTD.	CAVEAT RE : LEASE
042 251 112	FIRST CAPITAL (MEADOWLARK) CORPORATION; THE LIQUOR DEPOT CORPORATION; THE LIQUOR DEPOT AT MEADOWLARK LTD.; THE LIQUOR DEPOT AT CALLINGWOOD LTD.	RESTRICTIVE COVENANT
042 416 240	LIQUOR STORES GP INC.	CAVEAT RE : LEASE
052 185 590	KENNETH M. LUFT PROFESSIONAL CORPORATION.	CAVEAT RE : LEASE
052 235 784	SPECIFIC GRAVITY BREWING COMPANY & RESTAURANT INC.	CAVEAT RE : LEASE
052 478 882	G. L. MOYSA PROFESSIONAL CORPORATION.; BLAIR M. MEHLING PROFESSIONAL	CAVEAT RE : LEASE

	CORPORATION.	
082 176 153	KENNETH M. LUFT PROFESSIONAL CORPORATION.	CAVEAT RE : LEASE
092 444 445	XXXXXX; XXXXXX; XXXXXX; and XXXXXX	CAVEAT RE : LEASE INTEREST
102 310 728	833641 ALBERTA LTD.	CAVEAT RE : LEASE INTEREST
102 342 640	854524 ALBERTA LTD.	CAVEAT RE : LEASE INTEREST
112 127 296	HER MAJESTY THE QUEEN IN RIGHT OF ALBERTA AS REPRESENTED BY MINISTER OF INFRASTRUCTURE	CAVEAT RE : LEASE INTEREST
112 217 514	CDPQ MORTGAGE INVESTMENT CORPORATION.	MORTGAGE
112 217 515	CDPQ MORTGAGE INVESTMENT CORPORATION.	CAVEAT RE : ASSIGNMENT OF RENTS AND LEASES
112 217 516	CDPQ MORTGAGE INVESTMENT CORPORATION.	CAVEAT RE : LEASE INTEREST
112 217 517	CDPQ MORTGAGE INVESTMENT CORPORATION.	CAVEAT RE : LEASE INTEREST
112 217 518	CDPQ MORTGAGE INVESTMENT CORPORATION.	CAVEAT RE : LEASE INTEREST
112 300 013	933125 ALBERTA LTD.	CAVEAT RE : LEASE INTEREST
142 398 641	R. SHARON PROFESSIONAL CORPORATION.	CAVEAT RE : LEASE INTEREST
152 380 507	HER MAJESTY THE QUEEN IN RIGHT OF ALBERTA AS REPRESENTED BY MINISTER OF INFRASTRUCTURE	CAVEAT RE : LEASE INTEREST
162 063 491	EDMONTON WEST FAMILY PHYSICIANS GROUP NPC.	CAVEAT RE : LEASE INTEREST



DIAGRAM "A"

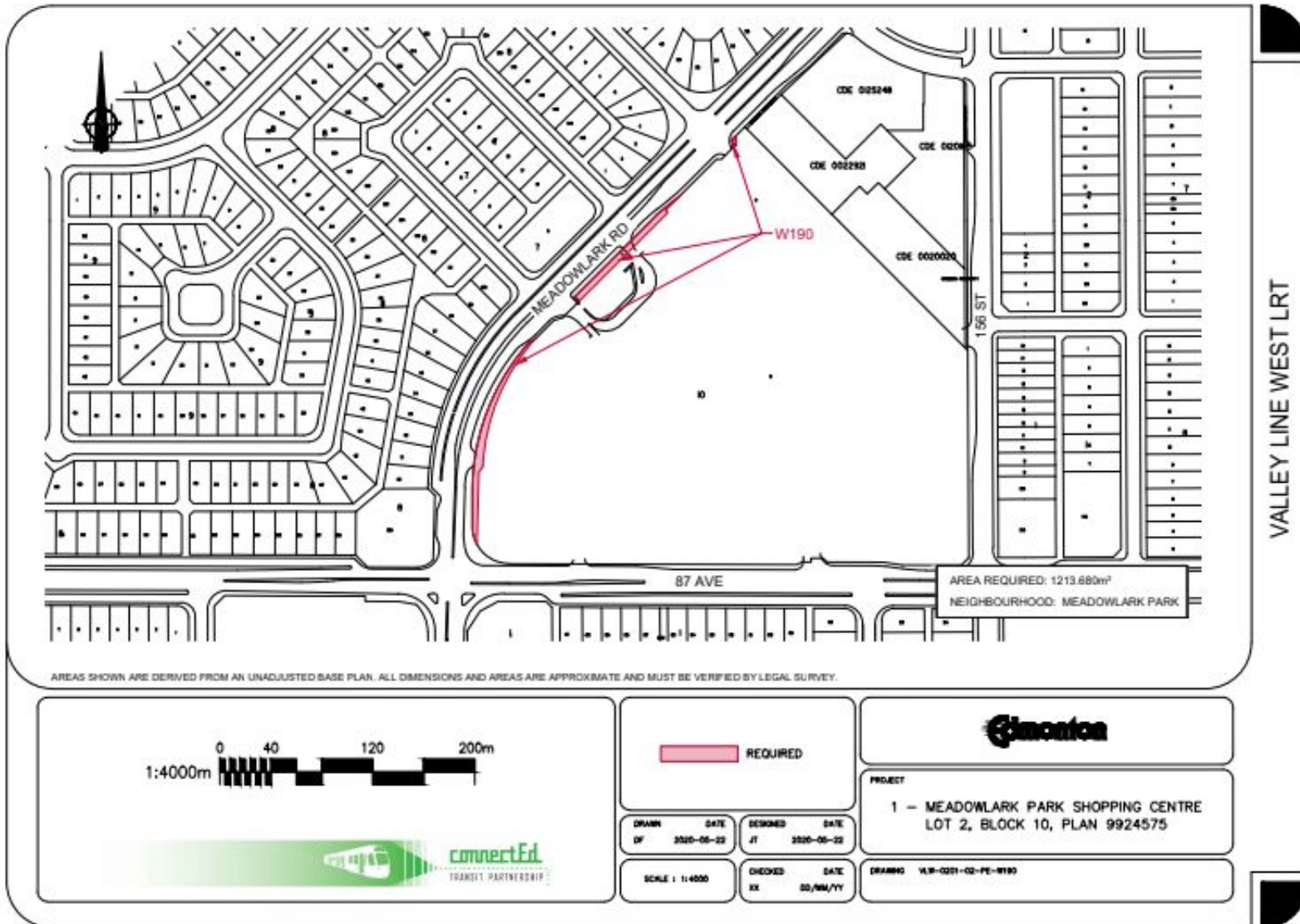

DIAGRAM "B"

