

Charter Bylaw 18931

A Bylaw to amend Bylaw 12800, as amended,
The Edmonton Zoning Bylaw
Amendment No. 2842

WHEREAS City Council at its meeting of February 22, 2001, gave third reading to Bylaw 12800, as amended; and

WHEREAS Council considers it desirable to amend the text of the Edmonton Zoning Bylaw;

NOW THEREFORE after due compliance with the relevant provisions of the Municipal Government Act RSA 2000, ch. M-26, as amended, the Municipal Council of the City of Edmonton duly assembled enacts as follows:

1. Bylaw 12800, as amended, The Edmonton Zoning Bylaw is hereby further amended by :
 - a) deleting Appendix I of Section 997, “Blatchford Special Area” and replacing with Appendix I of Section 997, “Special Area Blatchford Neighbourhood” attached as Schedule “A” and forming part of this Bylaw.

- b) deleting Appendix II of Section 997, “Environmental Overlay” and replacing with Appendix II of Section 997, “Environmental Overlay” attached as Schedule “B” and forming part of this Bylaw.

READ a first time this	day of	, A. D. 2019;
READ a second time this	day of	, A. D. 2019;
READ a third time this	day of	, A. D. 2019;
SIGNED and PASSED this	day of	, A. D. 2019.

THE CITY OF EDMONTON

MAYOR

CITY CLERK

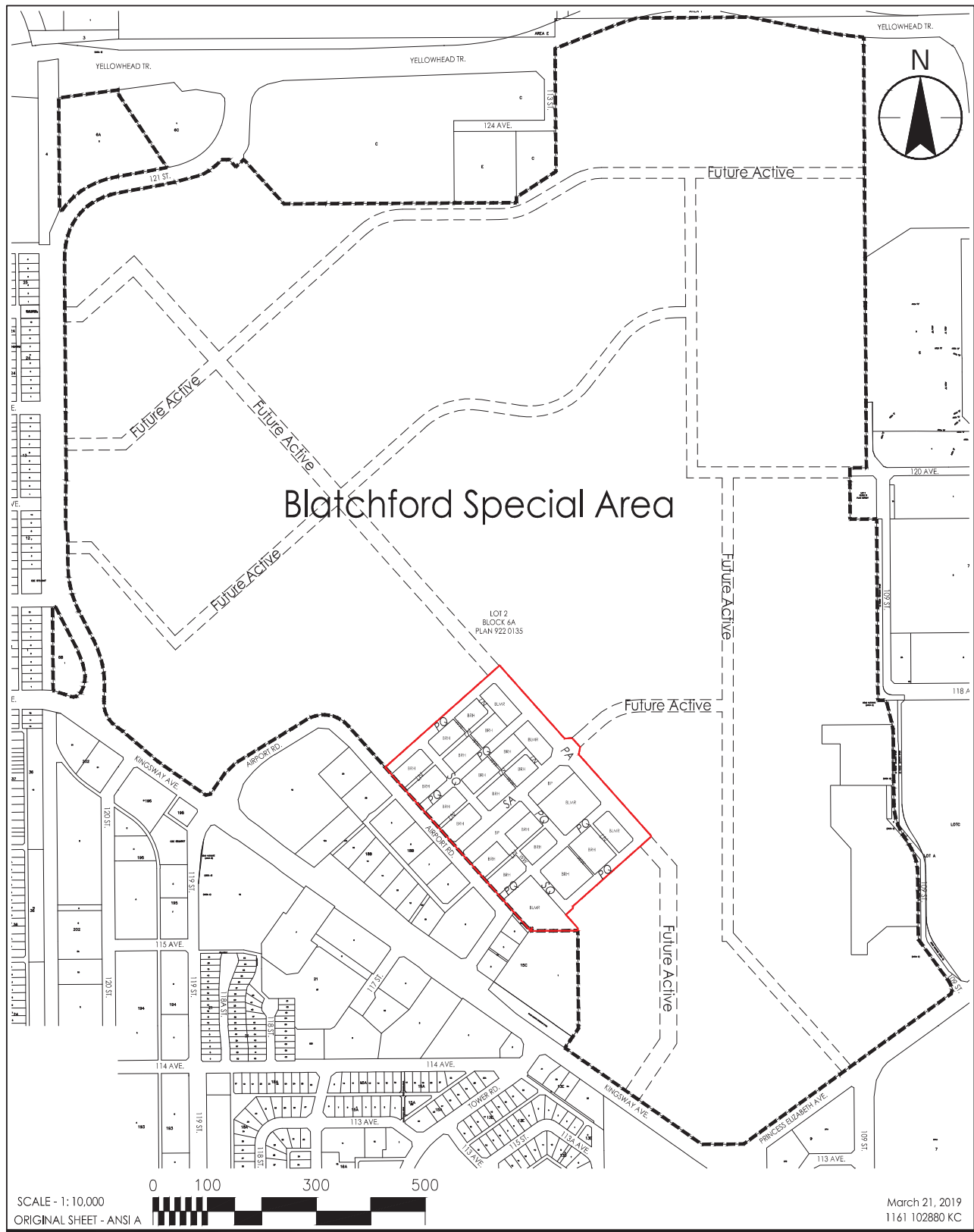

SCALE - 1:10,000
 ORIGINAL SHEET - ANSI A



March 21, 2019
 1161 102880 KC

- LEGEND**
- PA = PRIMARY ACTIVE STREET
 - SA = SECONDARY ACTIVE STREET
 - PQ = PRIMARY QUIET STREET
 - SQ = SECONDARY QUIET STREET
 - LN = LANE
 - WW = WALKWAY

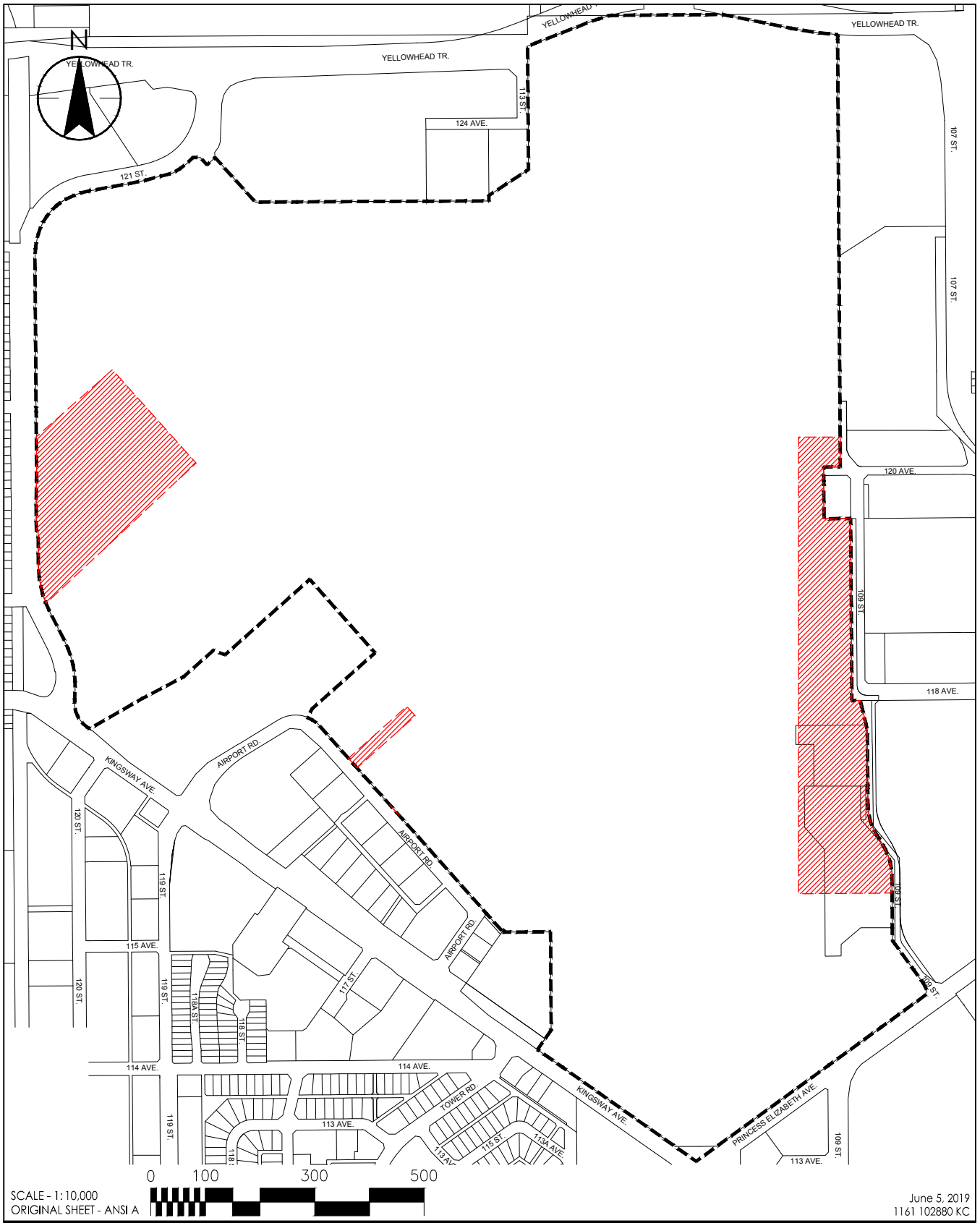

i j
 CITY OF EDMONTON
 BLATCHFORD NEIGHBOURHOOD
 REZONING
 Figure No. Appendix 1
 Title Special Area
Blatchford Neighbourhood



SCALE - 1:10,000
 ORIGINAL SHEET - ANSI A

June 5, 2019
 1161 102880 KC

LEGEND:

-  AREAS REQUIRING ENVIRONMENTAL TESTING AND POTENTIAL REMEDIATION
-  BLATCHFORD ENVIRONMENTAL OVERLAY BOUNDARY

NOTE: AREAS REQUIRING ENVIRONMENTAL TESTING AND POTENTIAL REMEDIATION REFLECT AN ADDITIONAL 25m BUFFER AROUND AREAS OF POTENTIAL CONCERN

Client/Project
 CITY OF EDMONTON
 BLATCHFORD
 NEIGHBOURHOOD

Figure No.
 Appendix II

Title
 ENVIRONMENTAL
 OVERLAY