

Charter Bylaw 18931

A Bylaw to amend Bylaw 12800, as amended,  
The Edmonton Zoning Bylaw  
Amendment No. 2842

WHEREAS City Council at its meeting of February 22, 2001, gave third reading to Bylaw 12800, as amended; and

WHEREAS Council considers it desirable to amend the text of the Edmonton Zoning Bylaw;

NOW THEREFORE after due compliance with the relevant provisions of the Municipal Government Act RSA 2000, ch. M-26, as amended, the Municipal Council of the City of Edmonton duly assembled enacts as follows:

1. Bylaw 12800, as amended, The Edmonton Zoning Bylaw is hereby further amended by :
  - a) deleting Appendix I of Section 997, “Blatchford Special Area” and replacing with Appendix I of Section 997, “Special Area Blatchford Neighbourhood” attached as Schedule “A” and forming part of this Bylaw.

- b) deleting Appendix II of Section 997, "Environmental Overlay" and replacing with Appendix II of Section 997, "Environmental Overlay" attached as Schedule "B" and forming part of this Bylaw.

READ a first time this	26th	day of	August	, A. D. 2019;
READ a second time this	26th	day of	August	, A. D. 2019;
READ a third time this	26th	day of	August	, A. D. 2019;
SIGNED and PASSED this	26th	day of	August	, A. D. 2019.

THE CITY OF EDMONTON

  
\_\_\_\_\_  
MAYOR

  
\_\_\_\_\_  
A/CITY CLERK

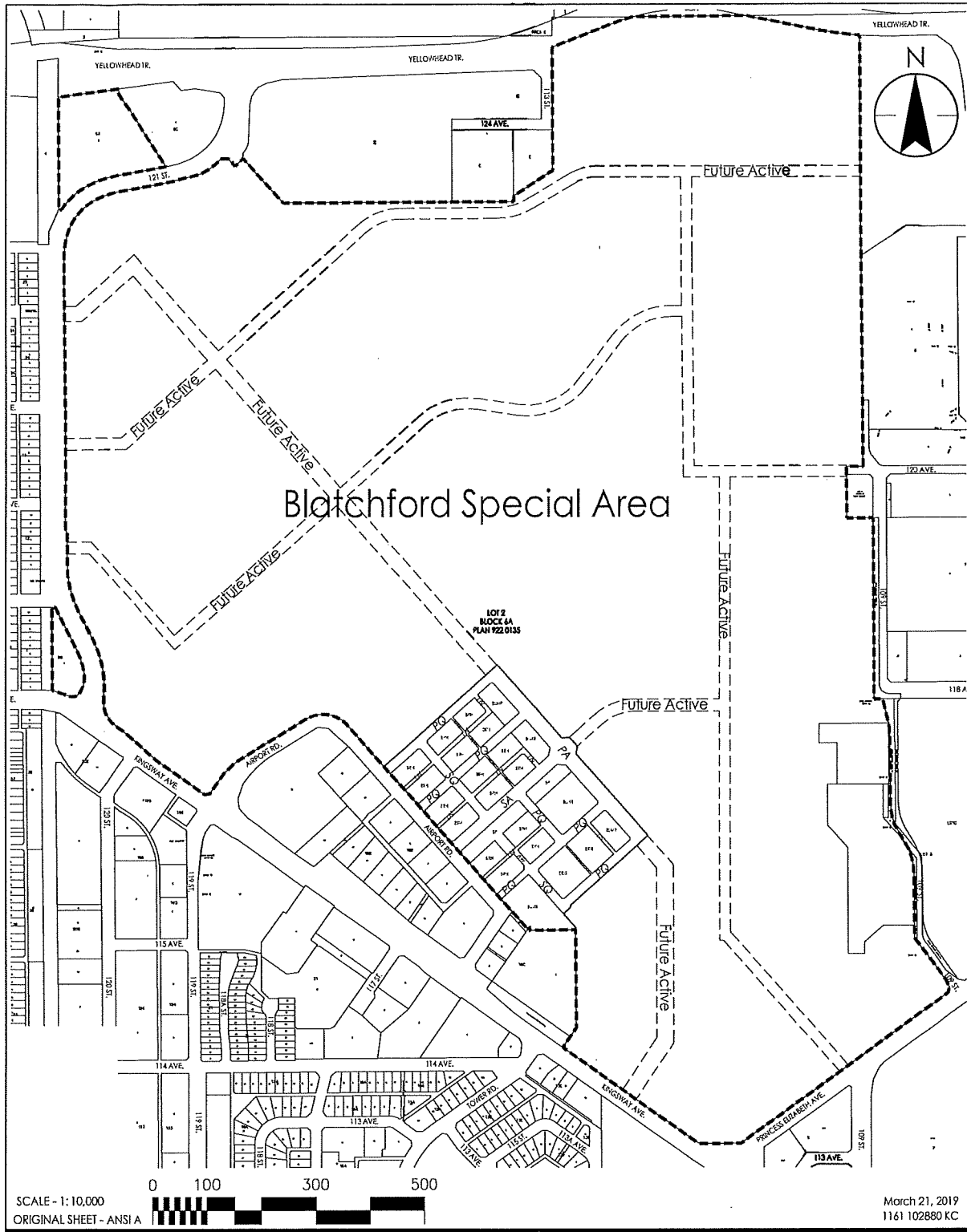

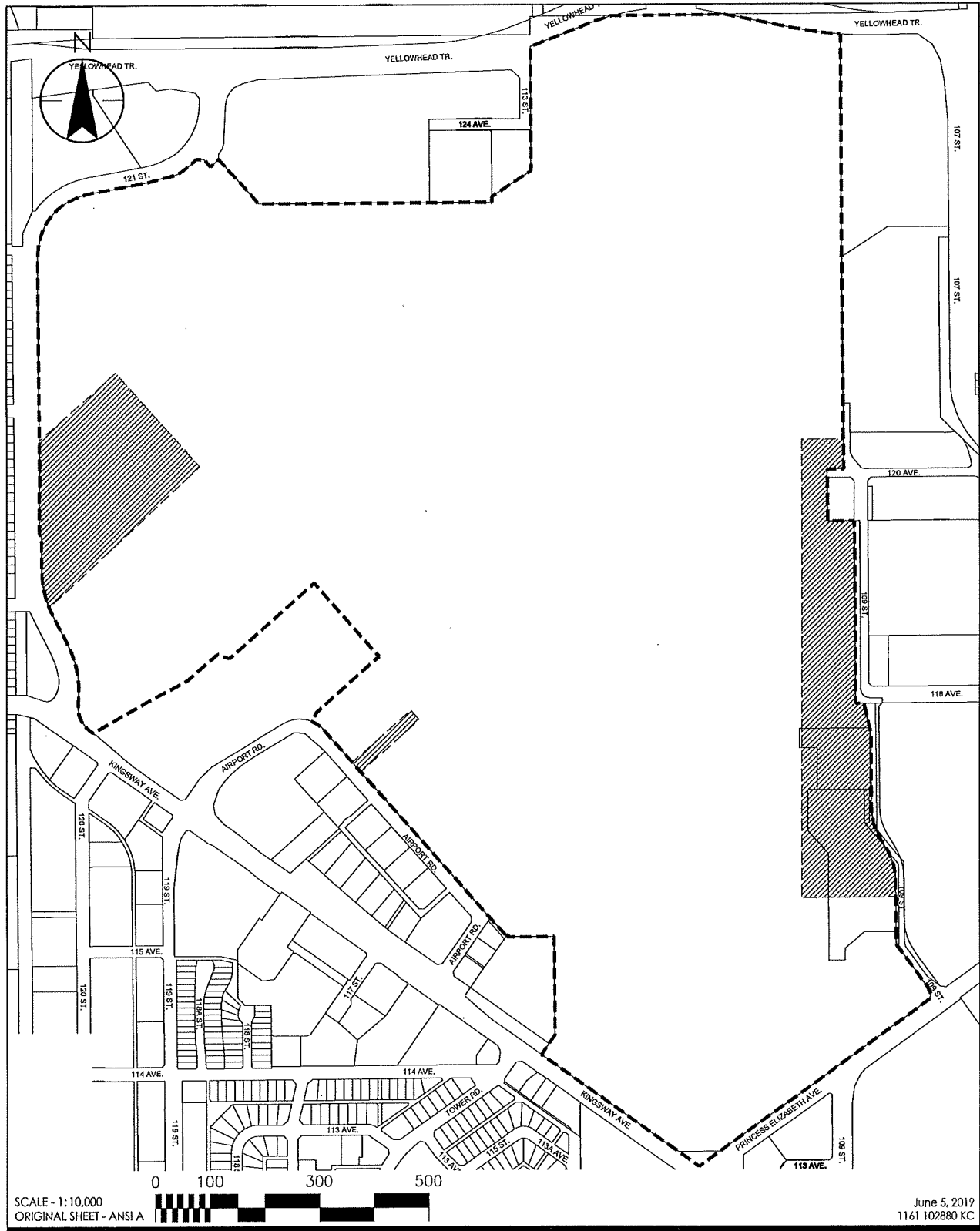

- LEGEND**
- PA = PRIMARY ACTIVE STREET
  - SA = SECONDARY ACTIVE STREET
  - PQ = PRIMARY QUIET STREET
  - SQ = SECONDARY QUIET STREET
  - LN = LANE
  - WW = WALKWAY

CITY OF EDMONTON  
 BLATCHFORD NEIGHBOURHOOD  
 REZONING  
 Figure No. Appendix 1  
 Title Special Area  
 Blatchford Neighbourhood



June 5, 2019  
1161 102880 KC

LEGEND:

-  AREAS REQUIRING ENVIRONMENTAL TESTING AND POTENTIAL REMEDIATION
-  BLATCHFORD ENVIRONMENTAL OVERLAY BOUNDARY

NOTE: AREAS REQUIRING ENVIRONMENTAL TESTING AND POTENTIAL REMEDIATION REFLECT AN ADDITIONAL 25m BUFFER AROUND AREAS OF POTENTIAL CONCERN

Client/Project

CITY OF EDMONTON  
BLATCHFORD  
NEIGHBOURHOOD

Figure No.

Appendix II

Title

ENVIRONMENTAL  
OVERLAY