

Charter Bylaw 19522

A Bylaw to amend Bylaw 12800, as amended,
The Edmonton Zoning Bylaw
Amendment No. 3136

WHEREAS a portion of NE-11-54-24-4; located at 18704 - 50 Street NW, Edmonton Energy and Technology Park, Edmonton, Alberta, is specified on the Zoning Map and Appendix I to Section 970 Special Area Edmonton Energy and Technology Park as (AG) Agricultural Zone; and

WHEREAS an application was made to rezone the above described property to (EETIM) Edmonton Energy and Technology Park Medium Industrial Zone and (A) Metropolitan Recreation Zone;

NOW THEREFORE after due compliance with the relevant provisions of the Municipal Government Act RSA 2000, ch. M-26, as amended, the Municipal Council of the City of Edmonton duly assembled enacts as follows:

1. The Zoning Map, being Part III to Bylaw 12800 The Edmonton Zoning Bylaw is hereby amended by rezoning the lands legally described as a portion of NE-11-54-24-4; located at 18704 - 50 Street NW, Edmonton Energy and Technology Park, Edmonton, Alberta, which lands are shown on the sketch plan attached as Schedule "A", from (AG) Agricultural Zone to (EETIM) Edmonton Energy and Technology Park Medium Industrial Zone and (A) Metropolitan Recreation Zone.

2. The Edmonton Zoning Bylaw is hereby further amended by deleting from it Appendix I to Section 970 Special Area Edmonton Energy and Technology Park and substituting therefore as Appendix I the map attached as Schedule "B".

READ a first time this	26	day of	January	, A. D. 2021;
READ a second time this	26	day of	January	, A. D. 2021;
READ a third time this	26	day of	January	, A. D. 2021;
SIGNED and PASSED this	26	day of	January	, A. D. 2021.

THE CITY OF EDMONTON

MAYOR

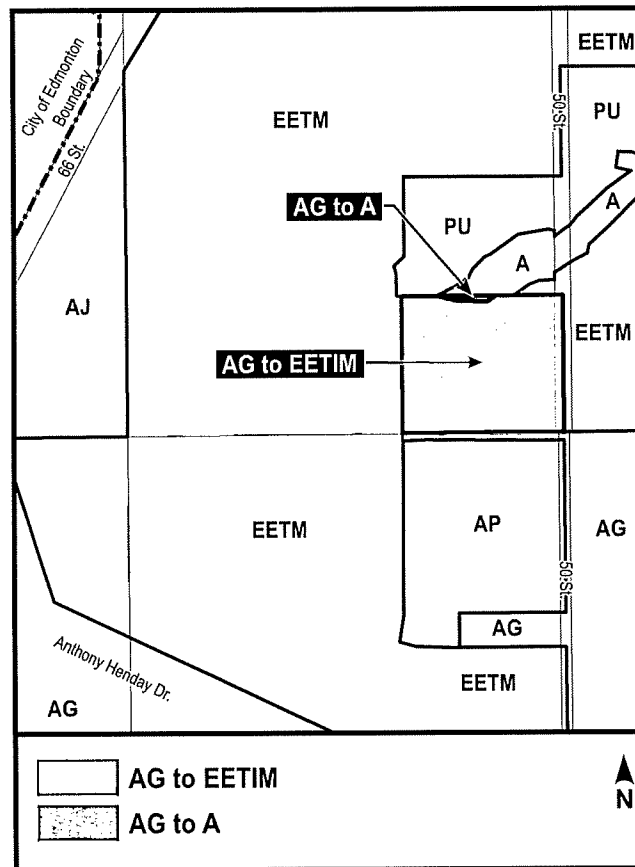

CITY CLERK

CHARTER BYLAW 19522

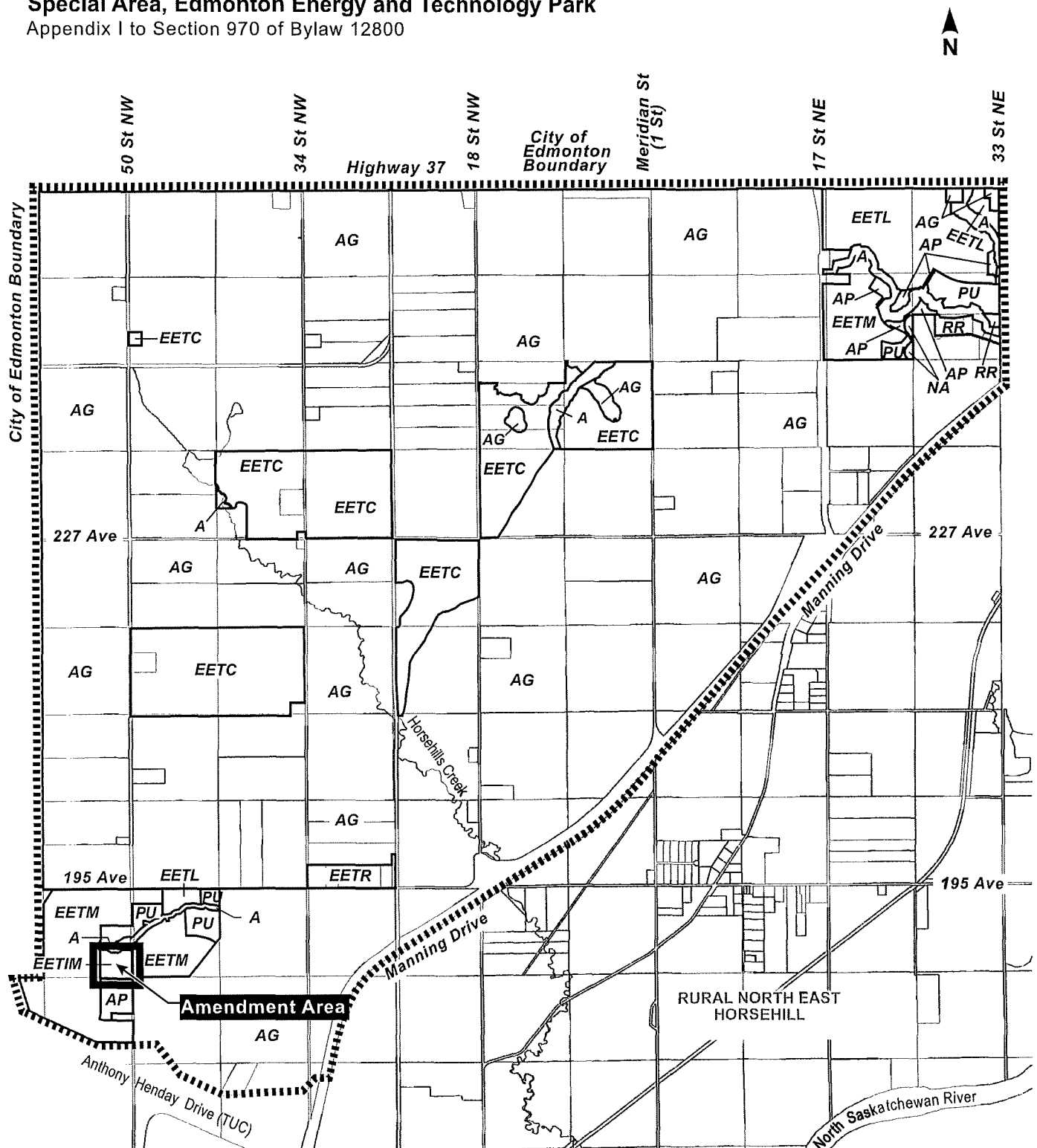

Special Area, Edmonton Energy and Technology Park

Appendix I to Section 970 of Bylaw 12800



- Special Study Area
- Amendment Boundary

Notes:

- * Designation applied to site with altered or specific development regulations in accordance with Section 970 of Zoning Bylaw.
- ★ Indicates Service Commercial Node.