

Bylaw 18809

Amendment to Bylaw 17260,
the Jasper Place Area Redevelopment Plan

WHEREAS pursuant to the authority granted to it, City Council considers it appropriate to provide planning policy to guide the future redevelopment of certain lands within the Britannia Youngstown, Canora, Glenwood and West Jasper Place neighbourhoods generally between 107 Avenue, 149 Street, 95 Avenue and 170 Street/Mayfield Road, known as Jasper Place;

WHEREAS on September 2, 2015, the Municipal Council of the City of Edmonton passed Bylaw 17260, the Jasper Place Area Redevelopment Plan;

WHEREAS an application was received by City Planning to amend the Jasper Place Area Redevelopment Plan; and

NOW THEREFORE after due compliance with the relevant provisions of the Municipal Government Act RSA 2000, ch. M-26, as amended, the Municipal Council of the City of Edmonton duly assembled enacts as follows:

1. That Bylaw 17260, Jasper Place Area Redevelopment Plan is hereby amended by the following:
 - a. delete "Figure 6: Jasper Place proposed land use" and replace with "Figure 6: Jasper Place proposed land use" attached hereto as Schedule "A" and forming part of this bylaw;
 - b. delete "Figure 12: Jasper Place proposed land use" and replace with "Figure 12: Jasper Place proposed land use" attached hereto as Schedule "B" and forming part of this bylaw;

- c. delete "Figure 16: Stony Plain Road focus area proposed land use" and replace with "Figure 16: Stony Plain Road focus area proposed land use" attached hereto as Schedule "C" and forming part of this bylaw.

READ a first time this 29th day of April , A. D. 2019;

READ a second time this 29th day of April , A. D. 2019;

READ a third time this 29th day of April , A. D. 2019;

SIGNED and PASSED this 29th day of April , A. D. 2019.

THE CITY OF EDMONTON

MAYOR

CITY CLERK

A

PROPOSED LAND USE

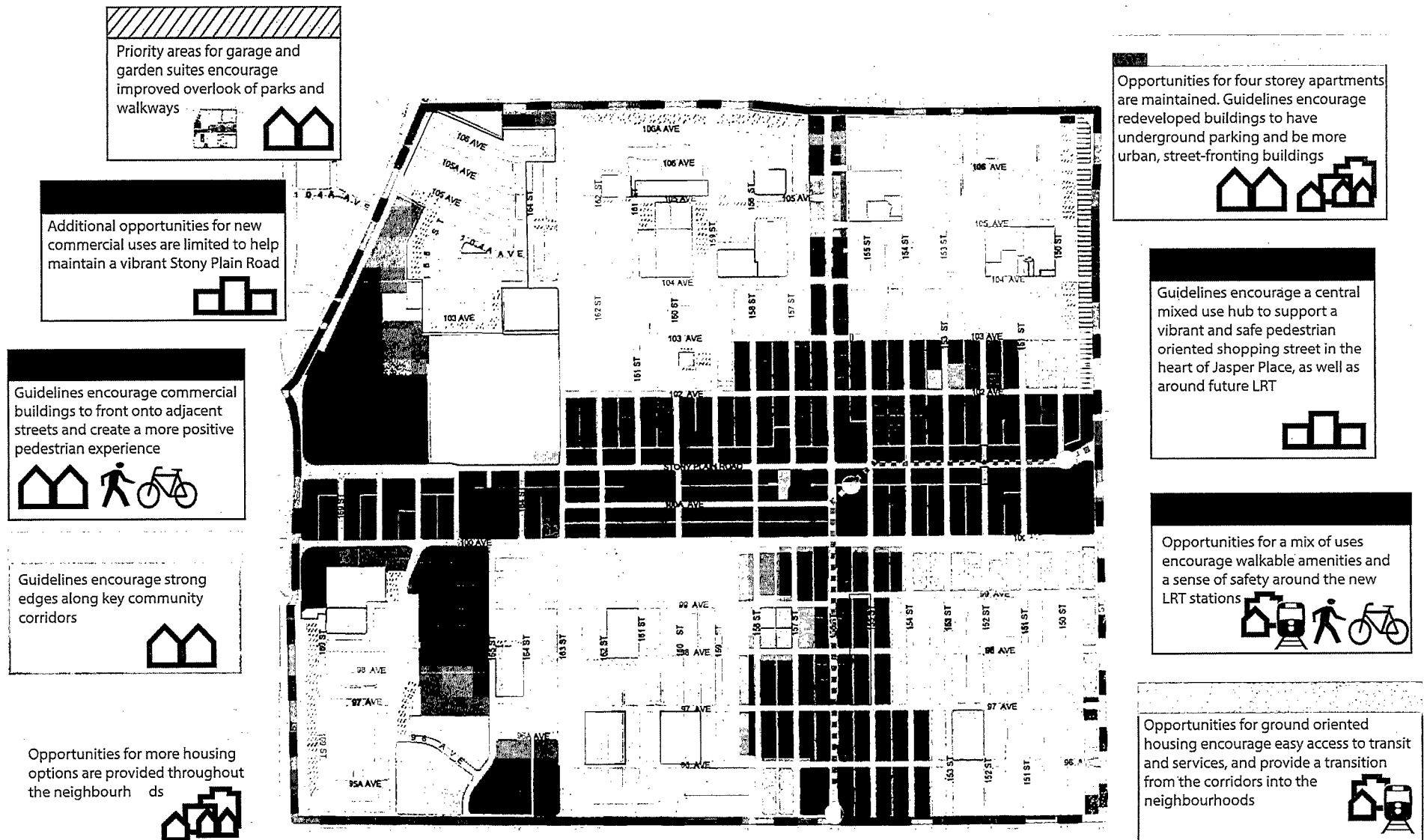

Figure 6: Jasper Place proposed land use

PROPOSED LAND USE

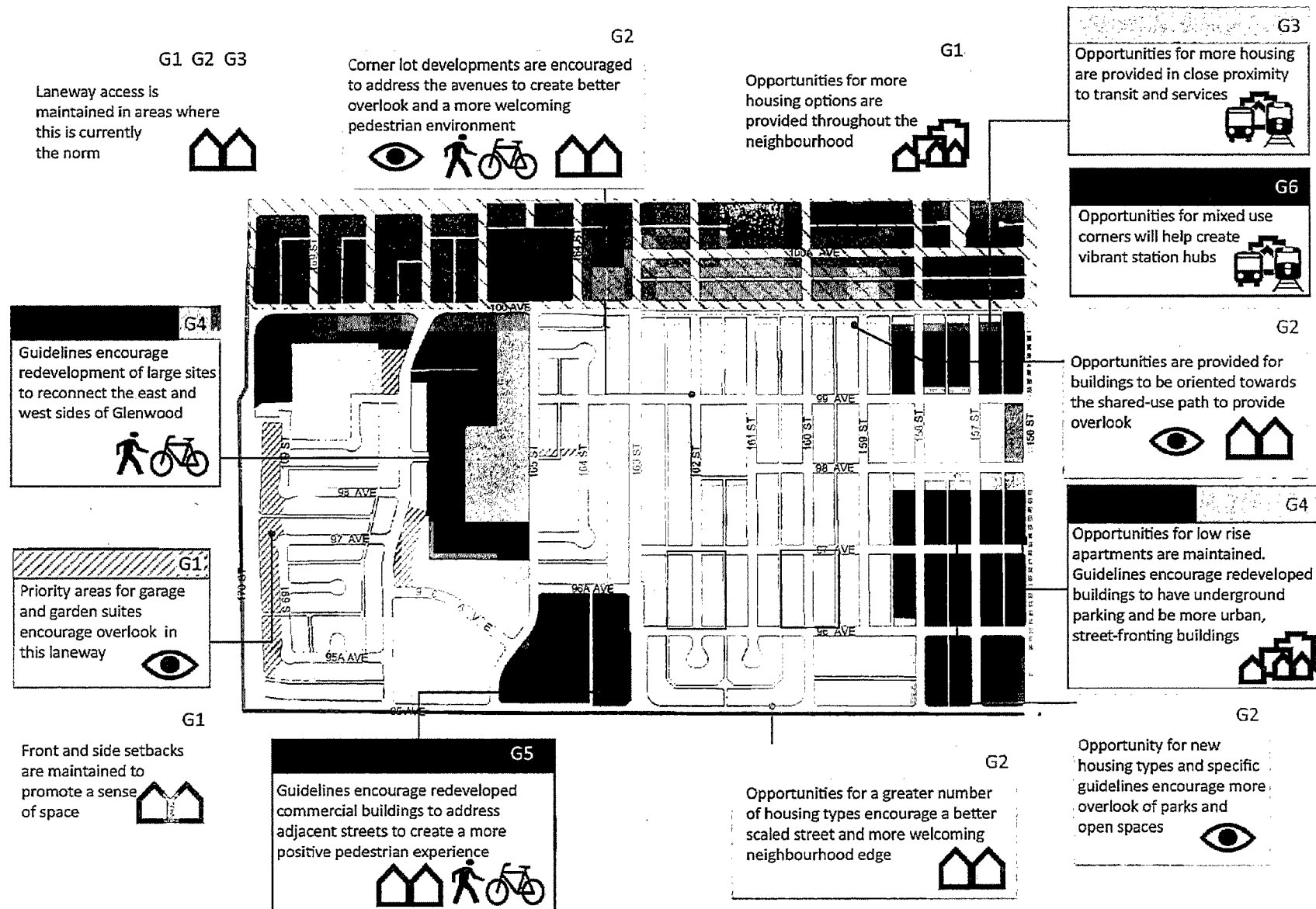

Figure 12: Glenwood proposed land use

PROPOSED LAND USE

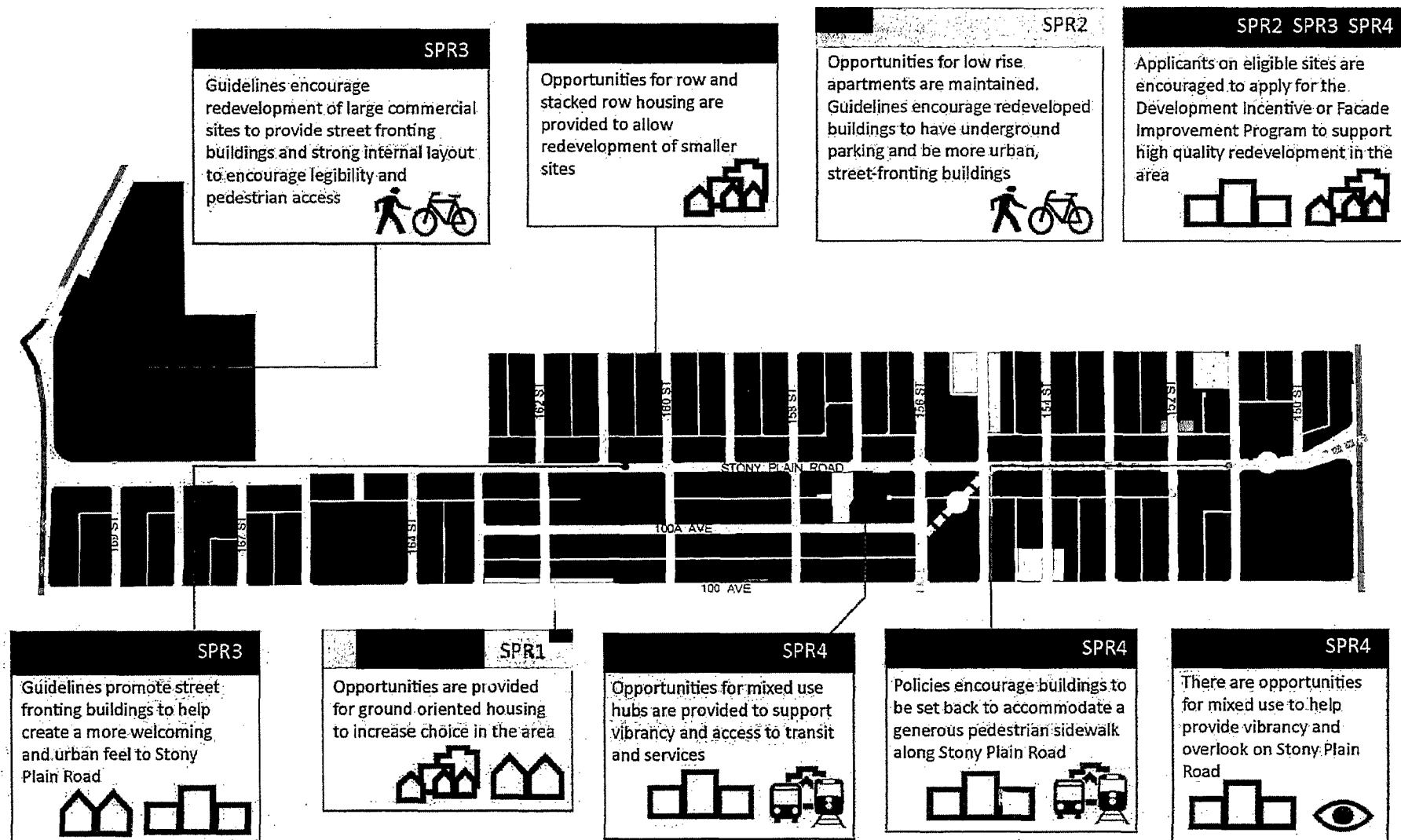

Figure 16: Stony Plain Road focus area proposed land use