

Bylaw 18761

Bylaw to amend Bylaw 11648, as amended,
being the Central McDougall/Queen Mary Park Area Redevelopment Plan

WHEREAS pursuant to the authority granted to it, City Council on March 5, 1998, passed Bylaw 11648, as amended, being a bylaw to adopt the Central McDougall/Queen Mary Park Area Redevelopment Plan; and

WHEREAS an application was received by City Planning to amend Bylaw 11648, as amended, the Central McDougall/Queen Mary Park Area Redevelopment Plan;

WHEREAS City Council considers it desirable to amend Central McDougall/Queen Mary Park Area Redevelopment Plan;

NOW THEREFORE after due compliance with the relevant provisions of the Municipal Government Act RSA 2000, ch. M-26, as amended, the Municipal Council of the City of Edmonton duly assembled enacts as follows:

1. The Central McDougall/Queen Mary Park Area Redevelopment Plan is hereby further amended by:
 - a. deleting “Map 12 - Queen Mary Park – Zoning” and replace it with “Map 12 - Queen Mary Park – Zoning” attached as Schedule “B” and forming part of this Bylaw; and

READ a first time this	day of	, A. D. 2019;
READ a second time this	day of	, A. D. 2019;
READ a third time this	day of	, A. D. 2019;
SIGNED and PASSED this	day of	, A. D. 2019.

THE CITY OF EDMONTON

MAYOR

CITY CLERK

Map 12 - Queen Mary Park - Approved Zoning

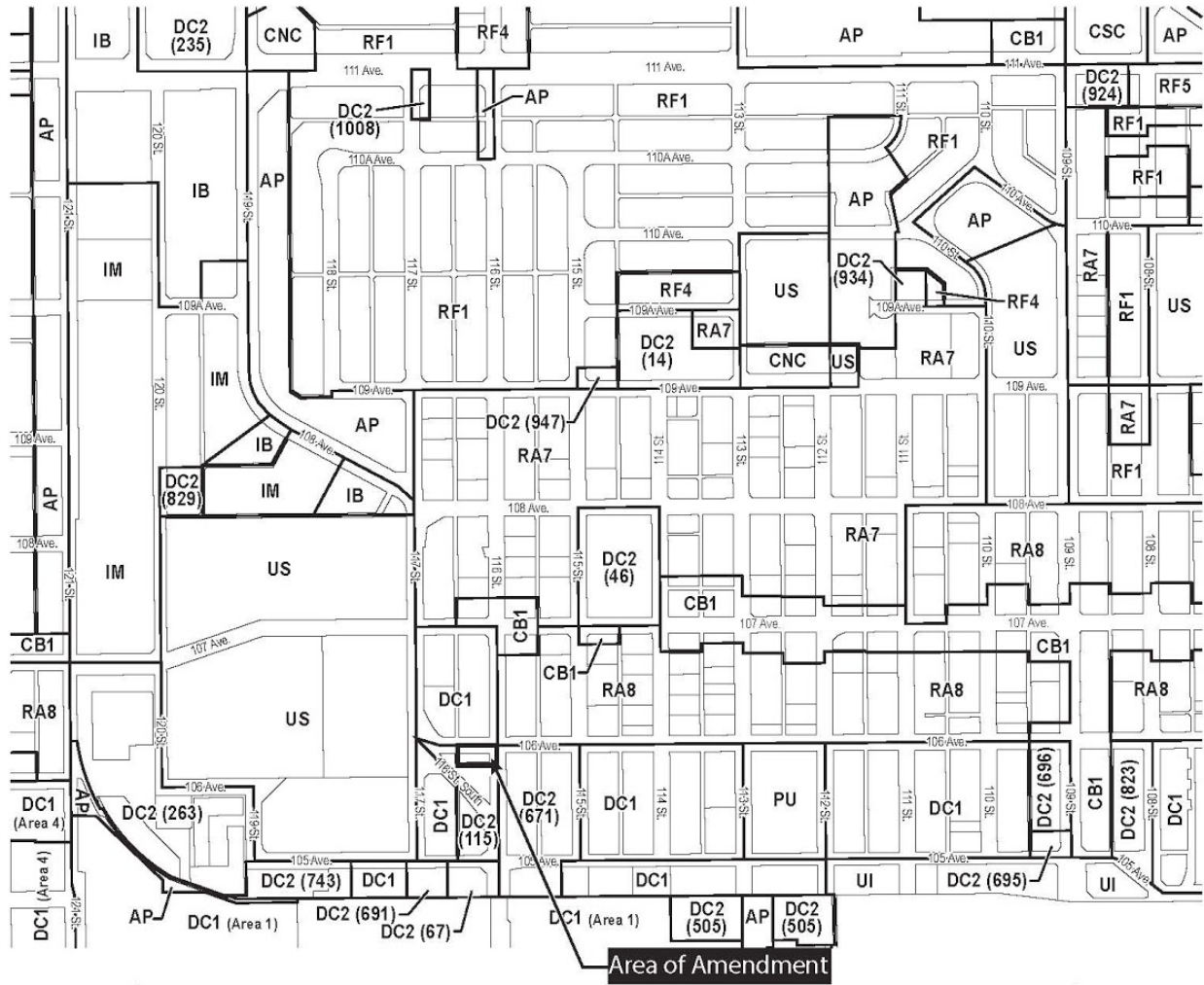

Zones		N
RF1	Single Detached Residential District	
RF4	Semi Detached Residential District	
RA7	Low Rise Apartment District	
RA8	Medium Rise Apartment District	
CNC	Neighbourhood Convenience Commercial District	
CB1	Low Intensity Business District	
IB	Industrial Business District	
IM	Medium Industrial District	
US	Urban Services District	
PU	Public Utility District	
AP	Public Parks District	
DC2	Site Specific Development Control District	